

ASSEMBLY - VIEW FROM FRONT

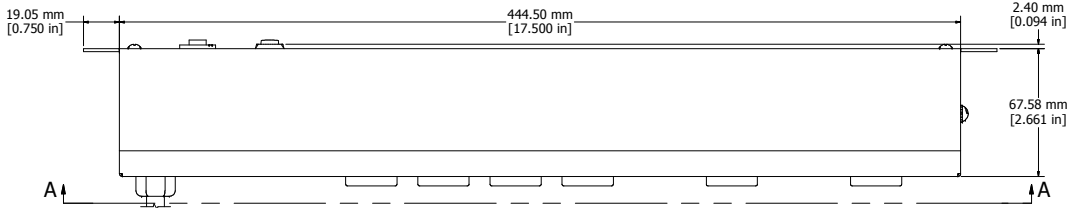

ASSEMBLY - VIEW FROM BOTTOM

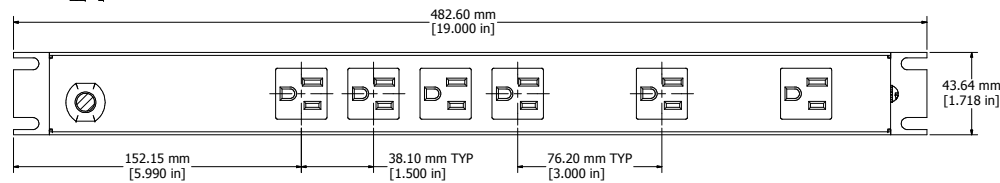
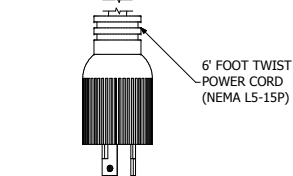

SECTION A-A

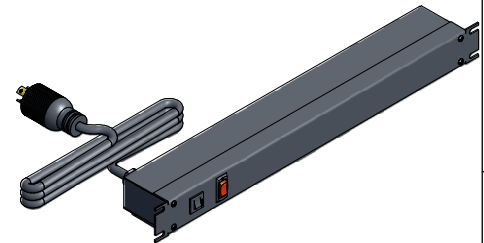

ISOMETRIC VIEW

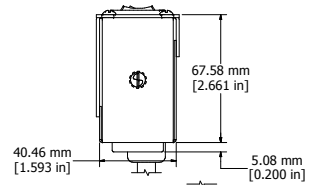

ASSEMBLY - VIEW FROM SIDE

1583H6C1BK
Finish - Front - Black Painted Steel
Back - Black Painted Steel
Rated - 125 VAC, 60 Hz, 15 Amps
Approvals - CSA Certified Standards C22.2 (No. 21-95, 42-99)
- UL Recognized Standard UL1363
Colours & Cord Length
1583H6C1BK - Black w/ 6' Foot Power Cord (NEMA 5-15P)
1583H6C1- ASA 61 Grey w/ 6' Foot Power Cord (NEMA 5-15P)
1583H6D1BK - Black w/ 15' Foot Power Cord (NEMA 5-15P)
1583H6D1- ASA 61 Grey w/ 15' Foot Power Cord (NEMA 5-15P)



**HAMMOND
MANUFACTURING™**
1583H6C1BK
www.hammondmfg.com