

REV	DATE	DESCRIPTION	BY	APP
F2	REVISED PER ECO-07-028164		JDF	CWR
F3	REVISED PER ECO-09-021510		KK	AEG

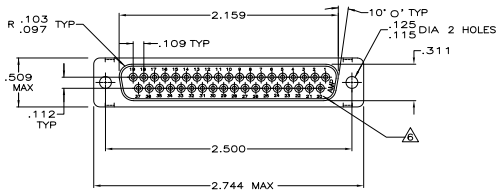

RCPT CONNECTOR
 INSERT: BLACK THERMOPLASTIC,
 94V-0 RATED.
 SHELL: STEEL PER ASTM A109,
 BRIGHT TIN PLATED
 PER MIL-T-10727.

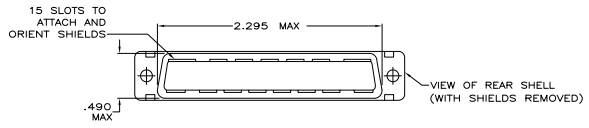
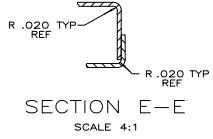
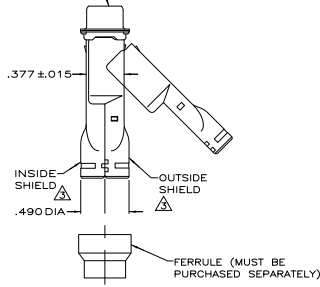
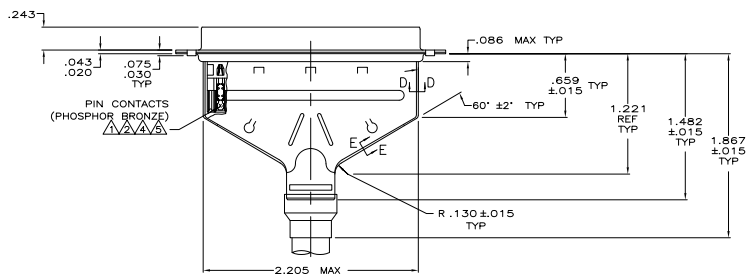
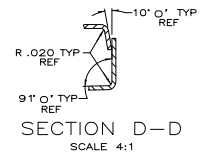

- △ RCPT CONNECTOR FULLY LOADED WITH CONTACTS. ALL OTHER PARTS SHIPPED UNASSEMBLED (EACH PART INDIVIDUALLY BULK PACKED).
- △ NUMBER ON CONTACT INDICATES WIRE RANGE.
- △ SHIELDS: MATERIAL-.020 THICK STEEL, TIN PLATED.
- △ CONTACTS PLATED .000030 GOLD ON MATING END FOR .150 MIN LENGTH. .000100-.000200 BRIGHT TIN OR BRIGHT TIN-LEAD IN WIRE TERMINATION AREA. .000050 NICKEL UNDERPLATE ON ENTIRE CONTACT.
- △ CONTACTS PLATED WITH GOLD FLASH ON MATING END FOR .150 MIN LENGTH. .000100-.000200 BRIGHT TIN OR BRIGHT TIN-LEAD IN WIRE TERMINATION AREA. .000030 NICKEL UNDERPLATE ON ENTIRE CONTACT.
- △ RAISED CAVITY IDENTIFICATION AND AMP TRADEMARK.
- △ CONTACTS PLATED .000050 GOLD ON MATING END FOR.150 MIN LENGTH. .000100-.000200 BRIGHT TIN OR BRIGHT TIN-LEAD IN WIRE TERMINATION AREA. .000050 NICKEL UNDERPLATE IN ENTIRE CONTACT.
- △ CONTACTS PLATED WITH GOLD FLASH ON MATING END FOR .150 MIN LENGTH. .000100-.000200 MATTE TIN IN WIRE TERMINATION AREA. .000030 MIN NICKEL UNDERPLATE ON ENTIRE CONTACT.
- △ OBSOLETE PARTS: OBSOLETE CIS STREAMLINING PER D.RENAUD/D.SINISI

REVISION	DESCRIPTION	DATE	BY	APP
2	#22-26	747564-9		
1	#26-30	747564-8		
2	#22-26	747564-7		
3	#20-22	747564-6		
2	#22-26	747564-5		
1	#26-30	747564-4		
3	#20-22	747564-3		
2	#22-26	747564-2		
1	#26-30	747564-1		

THIS DRAWING IS A CONTROLLED DOCUMENT. DATE: 11/19/04
 TTI ELECTRONICS CORPORATION
 HARRISBURG, PA 17105-3008
 KIT, RCPT, SHIELDING HARDWARE, SIZE 4, 37 POSN, HDE-20, ANTIPLATE
 114-40002
 007799
 747564