

4

3

2

1

THIS DRAWING IS UNPUBLISHED. RELEASED FOR PUBLICATION FEB. 2003.
 COPYRIGHT 2003 BY TYCO ELECTRONICS CORPORATION. ALL RIGHTS RESERVED.

| LOC | DIST | REVISIONS | | | |
|-----|------|---------------------------|---------|-----|------|
| P | LTR | DESCRIPTION | DATE | DWN | APVD |
| E | | REVISED PER ECR-10-024121 | 23NOV10 | AL | CW |

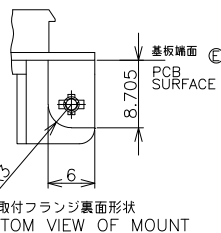
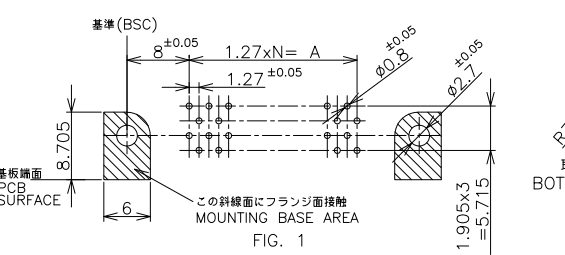
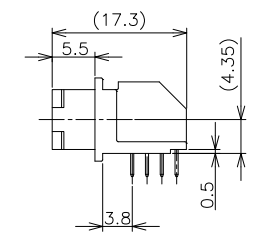
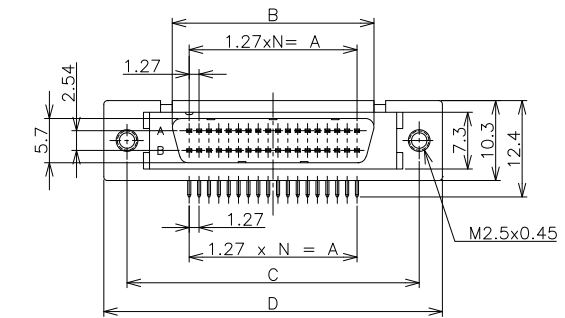
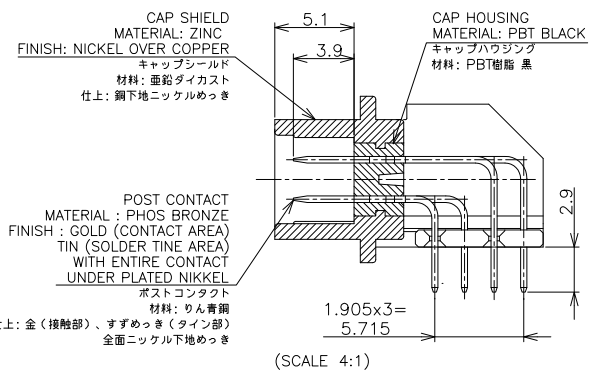
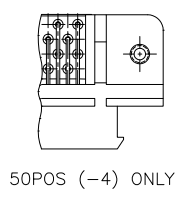
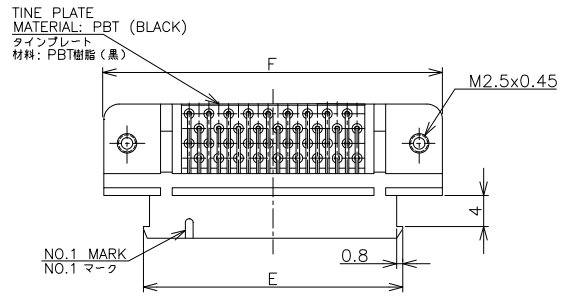

鉛フリー
LEAD FREE

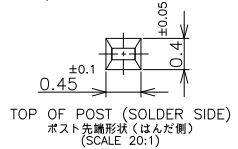

| POS | N | A | B | C | D | E | F | GOLD THK | PART NUMBER |
|-----|----|-------|-------|------|------|-------|------|-------------|-------------|
| 96 | 47 | 59.69 | 64.06 | 75.7 | 81.7 | 71.49 | 75.7 | 0.00076 MIN | 2-174225-6 |
| 68 | 33 | 41.91 | 46.28 | 57.9 | 63.9 | 53.71 | 57.9 | | 2-174225-5 |
| 50 | 24 | 30.48 | 34.85 | 46.5 | 52.5 | 42.28 | 46.5 | | △2-174225-4 |
| 36 | 17 | 21.59 | 25.96 | 37.6 | 43.6 | 33.39 | 37.6 | | △2-174225-3 |
| 28 | 13 | 16.51 | 20.88 | 32.5 | 38.5 | 28.31 | 32.5 | | △2-174225-2 |
| 20 | 9 | 11.43 | 15.8 | 27.4 | 33.4 | 23.23 | 27.4 | | △2-174225-1 |
| 96 | 47 | 59.69 | 64.06 | 75.7 | 81.7 | 71.49 | 75.7 | 0.0002 MIN | 174225-6 |
| 68 | 33 | 41.91 | 46.28 | 57.9 | 63.9 | 53.71 | 57.9 | | 174225-5 |
| 50 | 24 | 30.48 | 34.85 | 46.5 | 52.5 | 42.28 | 46.5 | | 174225-4 |
| 36 | 17 | 21.59 | 25.96 | 37.6 | 43.6 | 33.39 | 37.6 | | △174225-3 |
| 28 | 13 | 16.51 | 20.88 | 32.5 | 38.5 | 28.31 | 32.5 | | △174225-2 |
| 20 | 9 | 11.43 | 15.8 | 27.4 | 33.4 | 23.23 | 27.4 | | 174225-1 |

- FIG. 1
- P.C BOARD HOLE LAY-OUT AS SHOWN FIG. 1
 - USE SCREW SIZE ; M2.5 PAN-HEAD SCREW
 - OBSOLETE PARTS: OBSOLETE CIS STREAMLINING PER D.RENAUD/D.SINISI
 - OBSOLETE
- 1 基板パターン寸法図はFIG. 1に示す通り。
 2 適用ねじ: M2.5なべ小ねじ

THIS DRAWING IS A CONTROLLED DOCUMENT.

| | | | | | |
|--|--|-------------------------------------|--------------------------------|------------------------------|--|
| DIMENSIONS: 単位: 概 MM | TOLERANCES UNLESS OTHERWISE SPECIFIED: 数公差 | DWN H. TAGUCHI 16DEC03 | CHK T. FUTATSIGI 16DEC03 | APVD H. KODAMA 16DEC03 | NAME 名 |
| 0 PLC ±0.3 1 PLC ±0.3 2 PLC ±0.3 3 PLC ±0.3 4 PLC ±0.3 ANGLES ±3° | FINISH 仕上 | Tyco Electronics Kawasaki, Japan | | | POST HEADER (HORIZONTAL M2.5) AMPLIMITE .050 SERIES 2 TYPE B |
| MATERIAL | FINISH | SIZE A3 | CAGE CODE 00779 | DRAWING NO. 174225 | RESTRICTED TO |
| CUSTOMER DRAWING | | SCALE 尺度 2:1 | SHEET 1 OF 1 | REV E | |

AMP 1470-19 REV 31MAR2000
 11DEC03 10:30am