

REVISED PER		DATE	BY	CHK	APP
U	REVISED PER EC 0513-0176-03	200403	JG	CC	
U1	REVISED PER ECO-09-021826	090410	KX	AEG	

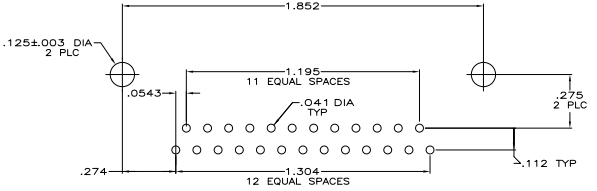
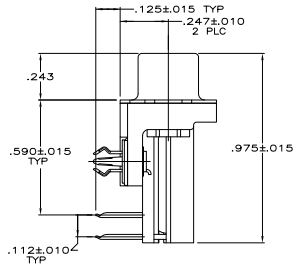
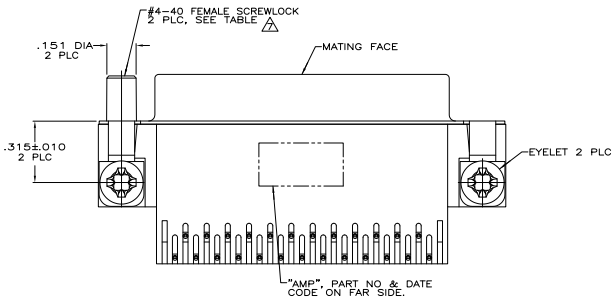
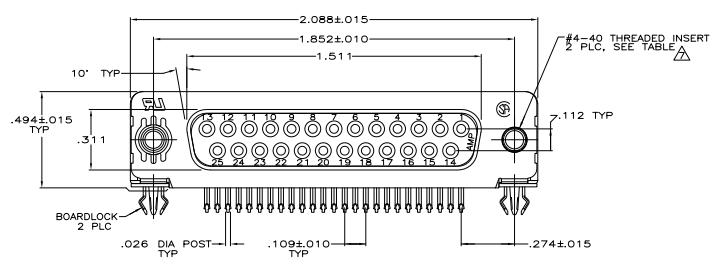

RECOMMENDED P.C. BOARD MOUNTING DIMENSIONS

- CONNECTOR MATES WITH ANY 25 POSN PLUG IN AMPLIMITE SERIES.
- MOLDED PARTS: FLAME RETARDANT 94V-0 RATED THERMOPLASTIC, BLACK.
SHELL: STEEL PER ASTM A109
CONTACTS: PHOSPHOR BRONZE PER QQ-B-750
EYELETS: BRASS
SCREWLOCKS: ZINC
INSERTS: ZINC
BOARDLOCKS: COPPER ALLOY
- SHELL: .000100 MIN TIN OR TIN-LEAD
CONTACTS: SEE TABLE
EYELETS: TIN
SCREWLOCKS: CLEAR CHROMATE
BOARDLOCKS: SEE TABLE
INSERTS: CLEAR CHROMATE
- GOLD PLATING PER MIL-G-45204, NICKEL PLATING PER QQ-N-290, TIN PLATING PER MIL-T-10727.
- GOLD FLASH FOR A DISTANCE OF .100 MIN FROM MATING END, .000100-.000200 BRIGHT TIN OR BRIGHT TIN-LEAD ON TERMINATION END, ALL OVER .000050 NICKEL ON ENTIRE CONTACT.
- .000030 GOLD FOR A DISTANCE OF .100 MIN FROM MATING END, .000100-.000200 BRIGHT TIN OR BRIGHT TIN-LEAD ON TERMINATION END, ALL OVER .000050 NICKEL ON ENTIRE CONTACT.
- SCREWLOCKS & INSERTS WILL WITHSTAND 4 IN-LBS TORQUE & 20 LBS PULL OUT FORCE FROM MATING FACE SIDE.
- OBsolete PARTS: OBsolete CIS STREAMLINING PER D.RENAUD/D.SINISI

OBsolete	THREADED INSERTS	TIN		6-747838-7
SUPSD BY 747838-6	FEMALE SCREWLOCKS	TIN-LEAD		747838-6
	FEMALE SCREWLOCKS	TIN-LEAD		747838-5
	THREADED INSERTS	TIN-LEAD		747838-4
	THREADED INSERTS	TIN-LEAD		747838-3
OBsolete	.125 DIA HOLES	TIN-LEAD		747838-2
OBsolete	.125 DIA HOLES	TIN-LEAD		747838-1

THIS DRAWING IS A CONTROLLED DOCUMENT		CALLUCO/3000		AMP Incorporated Harrisburg, PA 17105-3608	
DESIGNED BY	INCHES	DATE	REV	DESCRIPTION	REVISIONS
114-40010	114-40010	108-40025	1	RECEPTACLE ASSEMBLY, SIZE 3, 25 POSITION, .026 DIA POSTS, BOARDLOCKS, AMPLIMITE™ HD-20	
114-40010	114-40010	114-40010	1	114-40010	
CUSTOMER DRAWING			A100779		747838
			PAGE 4		1 OF 1