

THIS DRAWING IS UNPUBLISHED  
 ALL INFORMATION HEREIN IS UNCLASSIFIED  
 DATE 08-20-2010 BY 2010 ELECTRONICS CORPORATION

REV	DATE	DESCRIPTION	BY	APP'D
00				
1		REVISED PER EDD-10-018804		

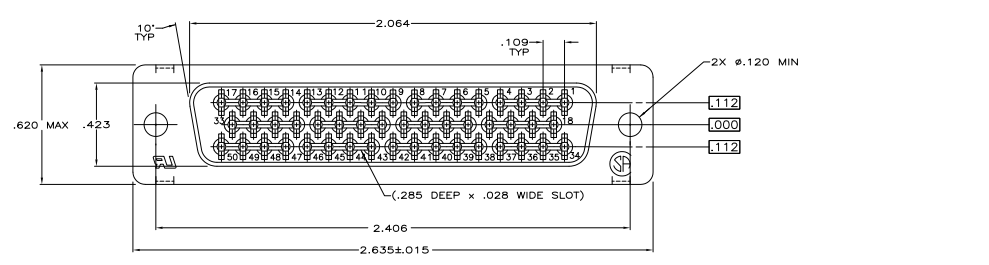

- ⚠ RECOMMENDATIONS FOR .093-.125 THICK PC BOARDS
  - A. HOLES SHOULD BE DRILLED WITH A 1.15 mm DRILL.
  - B. MINIMUM PCB TIN PLATING TO BE .0003 THICK OVER .002±.001 THICK COPPER.
  - C. RECOMMENDED HOLE SIZE AFTER TIN PLATING IS .037 TO .043 FOR PCB .093 TO .125 THICK.
  - D. IF HOLE IS REFLOWED AFTER PLATING, DIA TO BE .036 TO .043.
- ⚠ HOUSING: GLASS-FILLED NYLON OR POLYESTER, UL94V-0 RATED, COLOR BLACK. CONTACTS: COPPER ALLOY. SHELL: CARBON STEEL.
- ⚠ CONTACTS:
  - 0.76 MICRO METERS [.000030] MINIMUM GOLD IN MATING AREA.
  - 2.54 MICRO METERS [.000100] MINIMUM TIN ON COMPLIANT PIN.
  - ALL OVER 1.27 MICRO METERS [.000050] MINIMUM NICKEL.
  - OR
  - GOLD FLASH OVER PALLADIUM NICKEL.
  - 0.76 MICRO METERS [.000030] MINIMUM TOTAL IN MATING AREA.
  - 2.54 MICRO METERS [.000100] MINIMUM TIN ON COMPLIANT PIN.
  - ALL OVER 1.27 MICRO METERS [.000050] MINIMUM NICKEL.

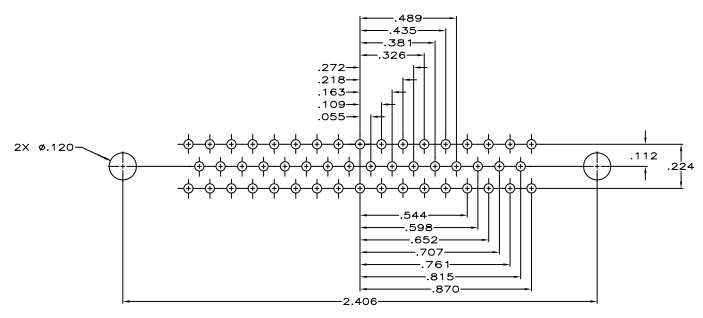
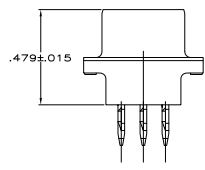
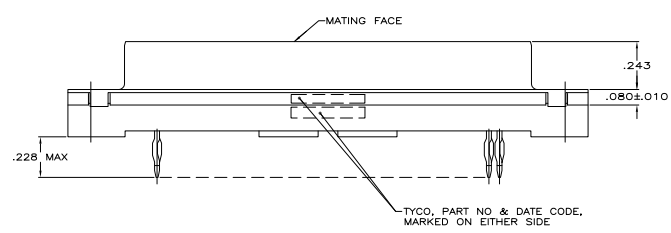

RECOMMENDED PC BOARD HOLE LAYOUT ⚠

5747143-2  
 PART NO

THIS DRAWING IS A CONTROLLED DOCUMENT.		REV	DATE	DESCRIPTION	BY	APP'D
DESIGNED	ENGINEER	REVISED	DATE	DESCRIPTION	BY	APP'D
1	M. BELMONT	1	108-40014	RECEPTACLE ASSY, SIZE 5, 50 POS, MEDIUM PROFILE, ACTION PIN CONTACTS, METAL SHELL, AMPHIMATE HSP		
2		2	114-40026			
3		3	100779	5747143		
CUSTOMER DRAWING		REV	DATE	DESCRIPTION	BY	APP'D
		4.1				

488 (1/86)