

THIS DRAWING IS UNPUBLISHED
 UNLESS OTHERWISE SPECIFIED
 ALL RIGHTS RESERVED

REV	DATE	DESCRIPTION	BY	CHK
00				
01		REVISED PER EDD-11-004835	11MMR11	RK HMR

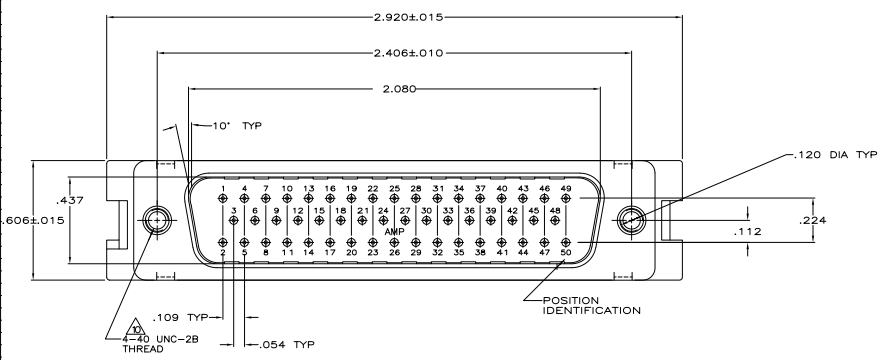

- CONNECTORS COMPLY WITH AMP SPEC 108-40012.
 - CONNECTOR DESIGNED FOR 28 AND 26 AWG STRANDED AND SOLID CONDUCTOR RIBBON CABLE ON .050 CENTER LINE.
- △ DIMENSION APPLIES TO TERMINATED CONNECTOR.
 - △ MOLDED PARTS: FLAME RETARDANT 94V-0 RATED THERMOPLASTIC; COLOR: BLACK.
 - △ SHELL: STEEL PER QQ-S-698.
 - △ CONTACTS: PH BRZ PER QQ-B-750.
 - △ GOLD PLATING PER MIL-G-45204, TIN PLATING PER MIL-T-10727, NICKEL PLATING PER QQ-N-290.
 - △ SHELL: BRIGHT TIN PLATED.
 - △ CONTACTS:
 .000030 MIN GOLD ON MATING END, .000100-.000200 MATTE TIN ON TERMINATION END, ALL OVER .000050 NICKEL ON ENTIRE CONTACT.
 OR
 GOLD FLASH OVER PALLADIUM-NICKEL ON MATING END, .000030 MIN TOTAL, .000100-.000200 MATTE TIN ON TERMINATION END, ALL OVER .000050 NICKEL ON ENTIRE CONTACT.
 - △ THE MAX SCREW PENETRATION INTO THE CONNECTOR = .312.
 - △ INTERNAL NUT: ZINC PLATED .000150-.000300 THICK, CLEAR CHROMATE COATED.

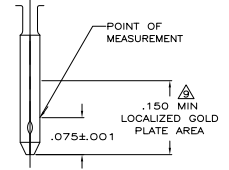
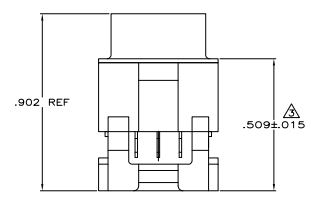
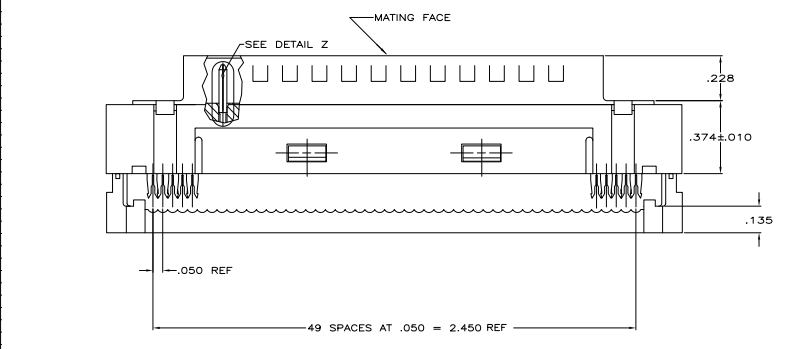

DETAIL Z
 SCALE 10:1
 ROTATED 180° CW

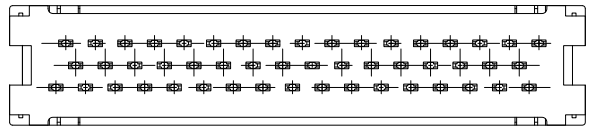

1658607-1
 PART NO

THIS DRAWING IS A CONTROLLED DOCUMENT.		DATE: 4/19/93	BY: J. SHAW
DRAWN BY: J. SHAW		DATE: 4/19/93	BY: J. SHAW
CHECKED BY: M. WILMSLEY		DATE: 4/19/93	BY: M. WILMSLEY
APPROVED BY: M. WILMSLEY		DATE: 4/19/93	BY: M. WILMSLEY
CUSTOMER SPEC: A1		DATE: 4/19/93	BY: M. WILMSLEY
REVISIONS: A1		DATE: 4/19/93	BY: M. WILMSLEY
PART NO: 1658607-1		DATE: 4/19/93	BY: M. WILMSLEY
DRAWING NO: 1658607		DATE: 4/19/93	BY: M. WILMSLEY
CUSTOMER DRAWING		DATE: 4/19/93	BY: M. WILMSLEY