

LOC	DIST	REVISIONS		DATE	MIN	APPD
GP	00	P	LTR	DESCRIPTION		
		A		REVISED PER ECO-06-028330	18/DEC/06	ZMR/EDB

- ▲ MOLDED PARTS: GLASS FILLED NYLON, UL94V-0 RATED, COLOR BLACK.  
SHELLS & BRACKETS: CARBON STEEL.  
CONTACTS: PHOSPHOR BRONZE.
- ▲ SHELLS: .000200 MIN TIN OVER .000100 MIN COPPER.  
BRACKETS: .000200 MIN TIN OVER .000050 MIN COPPER.  
CONTACTS: .000030 MIN GOLD FOR A LENGTH OF .100 MIN FROM MATING END, .000100 MIN TIN ON OPPOSITE END, BOTH OVER .000050 MIN NICKEL  
--OR--  
GOLD FLASH OVER .000030 MIN PALLADIUM NICKEL PLATED FOR LENGTH OF .100 MIN FROM MATING END, .000100 MIN TIN ON OPPOSITE END, BOTH OVER .000050 MIN NICKEL.

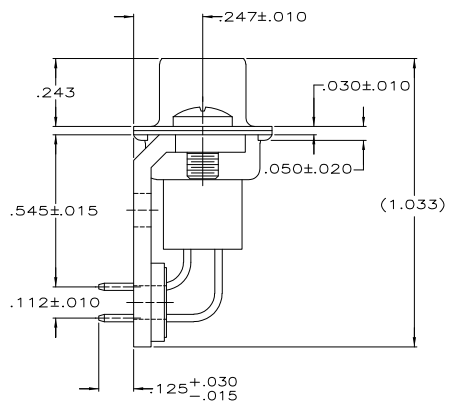

5745114-2  
PART NO.

DIMENSIONS:		REVISIONS:		TYPICAL DIMENSIONS:		MATERIAL:		FINISH:	
INCHES		0	PLC	±		0	PLC	±	
		1	PLC	±		1	PLC	±	
		2	PLC	±		2	PLC	±	
		3	PLC	±		3	PLC	±	
		4	PLC	±		4	PLC	±	
			ANGLES	±			ANGLES	±	

DATE	BY	CHK	APPD	NAME	SIZE	CHG CODE	DRAWING NO	RESTRICTED TO
8-24-05	D. HENRY				A2	00779	C=5745114	
8-24-05	S. BOLASH							
8-24-05	M. WALMSLEY							

PRODUCT SPEC	APPLICATION SPEC	RIGHT	SCALE	SHEET	REV
108-40025	114-40013		4:1	1 of 1	A

THIS DRAWING IS A CONTROLLED DOCUMENT.

Ytyco Electronics Corporation  
Harrisburg, PA 17105-3608

RECEPTACLE ASSEMBLY, SIZE 3, 25 POSITION, RIGHT ANGLE, .545 SERIES, .025 SQ. POSTS, AMPLIMITE HDP

CUSTOMER DRAWING

AMP 1471-9 REV 31MM2000