

REV	DATE	DESCRIPTION	BY	CHK
GP 00				
A		REVISED PER ECO-06-028339	3/24/07	ZMR/EDB

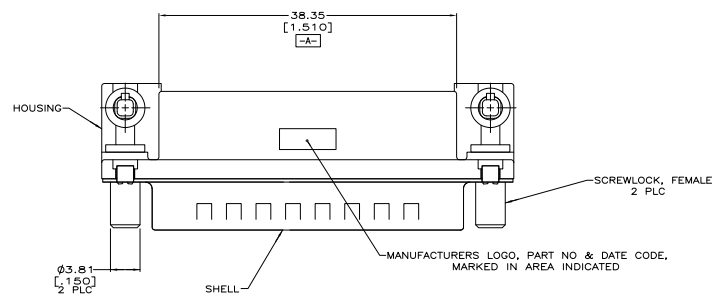

- ▲ HOUSING: NYLON, THERMOPLASTIC, UL 94VO RATED, BLACK; SHELL: CARBON STEEL; PIN CONTACTS: BRASS EYELETS: BRASS; SCREWLOCKS: ZINC; BOARDLOCKS: COPPER ALLOY.
- ▲ PIN CONTACTS: GOLD PLATED FOR A LENGTH OF 3.81 [150] MIN FROM MATING END, 0.76μm [0.00030] MIN GOLD IN MATED AREA, 2.54μm [0.00100] MIN TIN FOR A LENGTH OF 3.56 [140] MIN FROM OPPOSITE END, BOTH OVER 1.27μm [0.00050] MIN NICKEL.
- OR-
- ▲ GOLD FLASH OVER PALLADIUM NICKEL PLATED FOR A LENGTH OF 3.81 [150] MIN FROM MATING END, 0.76μm [0.00030] MIN PALLADIUM NICKEL IN MATED AREA, 2.54μm [0.00100] MIN TIN OVER A LENGTH OF 3.56 [140] MIN FROM OPPOSITE END, BOTH OVER 1.27μm [0.00050] MIN NICKEL.
- ▲ EYELETS: 2.54μm [0.00100] MIN TIN OVER COPPER FLASH.
- ▲ SHELL: 2.54μm [0.00100] MIN TIN OVER 1.27μm [0.00050] MIN NICKEL.
- ▲ SCREWLOCKS: CLEAR CHROMATE.
- ▲ BOARDLOCKS: 3.81μm [0.00150] MIN TIN OVER 1.27μm [0.00050] MIN NICKEL.
- ▲ DATUMS AND BASIC DIMENSIONS ESTABLISHED BY CUSTOMER.
- ▲ POSITION TOLERANCE APPLIES AT CONTACT TIP.
- ▲ BOARDLOCKS WILL ACCEPT .062 MAX PRINTED CIRCUIT BOARD THICKNESS.
- 6. COMPATIBLE WITH SOLDERING APPLICATIONS TO A MAXIMUM OF 225°C FOR A MAXIMUM DURATION OF 90 SECONDS. TEMPERATURE TO BE MEASURED ON CONNECTOR SURFACE.

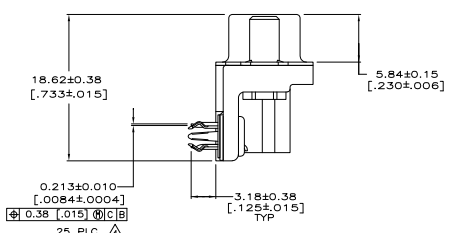
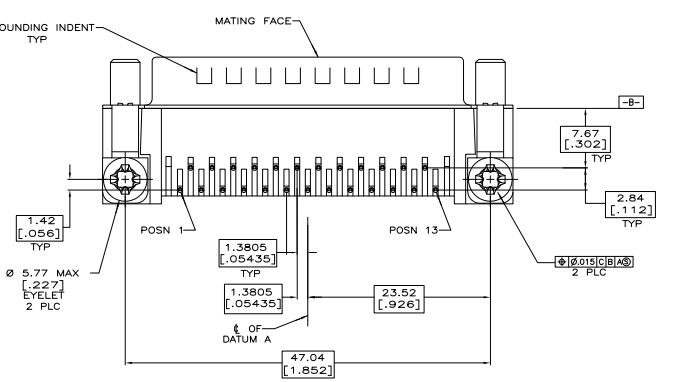
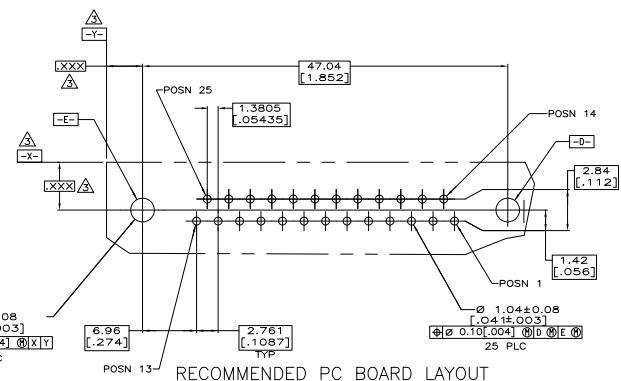
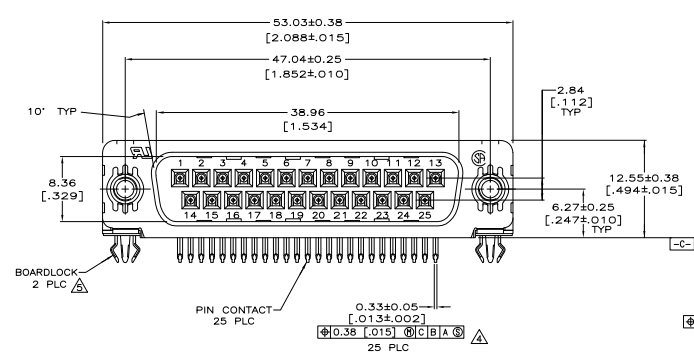

COPYRIGHT 2005  
 TYCO ELECTRONICS CORP  
 ALL RIGHTS RESERVED

THIS DRAWING IS A CONTROLLED DOCUMENT.		REV	DATE	BY	CHK
DRAWING NO.		108-40025	04-28-03	W. WILMSLEY	04-28-03
REVISED PER		ECO-06-028339	03-24-07	3/24/07	ZMR/EDB
CUSTOMER DRAWING		114-40010			
PART NO		5788795-1			
DESCRIPTION		PLUG ASSEMBLY, SIZE 3, 318 SERIES, WITH FRONT METAL SHELL, HIGH TEMPERATURE, ANGLE, PD-20			
REVISED TO		A1 00779 (C)=5788795			
DATE		4/1			