

DETAIL D

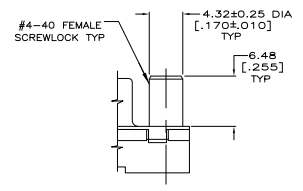

DETAIL E

- ▲ HOUSING: POLYESTER, UL 94V-0 RATED, BLACK.
- ▲ SHELL: CARBON STEEL.
- ▲ SHELL: 5.08um [.000200] MIN TIN OVER 2.54um [.000100] MIN COPPER.
- ▲ GOLD FLASH FOR A LENGTH OF 2.54[.100] MIN FROM MATING END, 2.54um [.000100] MIN TIN OR TIN-LEAD ON OPPOSITE END, BOTH OVER 1.27um [.000050] MIN NICKEL.
- ▲ 0.76um [.000030] MIN GOLD FOR A LENGTH OF 2.54 [.100] MIN FROM MATING END, 2.54um [.000100] MIN TIN OR TIN-LEAD ON OPPOSITE END, BOTH OVER 1.27um [.000050] MIN NICKEL.
- 6. NOTE DELETED.
- ▲ DATUMS AND BASIC DIMENSIONS ESTABLISHED BY CUSTOMER.
- ▲ 2.79[.110] MAX IN SHELL TAB CLUNCH AREAS.
- ▲ SUPERSEDED BY 747150-2.
- ▲ SUPERSEDED BY 747150-9.
- ▲ SUPERSEDED BY 1-747150-6.
- ▲ OBSOLETE.
- ▲ CONTACTS: PHOSPHOR BRONZE.
- ▲ SCREWLOCKS: ZINC.
- ▲ INSERTS: BRASS.

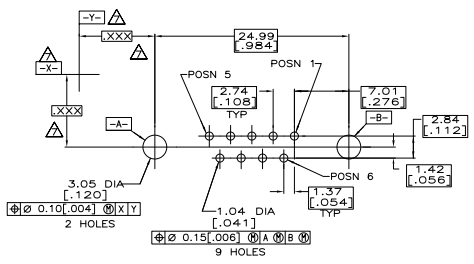

RECOMMENDED PC BOARD LAYOUT
 CONNECTOR SIDE OF PC BOARD

W/FEMALE SCREWLOCKS PER DETAIL E	▲	4.32	.170	1-747150-6
	▲	4.32	.170	1-747150-5
	▲	3.18	.125	1-747150-4
W/THREADED INSERTS PER DETAIL D	▲	6.35	.250	1-747150-1
	▲	4.32	.170	1-747150-0
	▲	4.32	.170	747150-9
WO/FEMALE SCREWLOCKS OR THREADED INSERTS AS SHOWN	▲	3.18	.125	747150-8
	▲	3.18	.125	747150-7
	▲	4.32	.170	747150-4
HARDWARE OPTIONS	▲	3.18	.125	747150-2
	▲	3.18	.125	747150-1
CONTACTS				
FINISH				
C				
PART NO				

THIS DRAWING IS A CONTROLLED DOCUMENT.		REV	DATE	DESCRIPTION	BY	CHK	APP
INCHES	MILLIMETERS						
1:1	1:1						
108-40025							
114-40023							
100779							
CUSTOMER DRAWING							