

4

3

2

1

THIS DRAWING IS UNPUBLISHED. RELEASED FOR PUBLICATION  
 © COPYRIGHT BY TYCO ELECTRONICS CORPORATION. ALL RIGHTS RESERVED.

LOC		DIB		REVISIONS			
P	LR	DESCRIPTION	DATE	BY	APPD		
0		RELEASED PER EC 0513-0087-05		OBSEPOS	GP	JG	

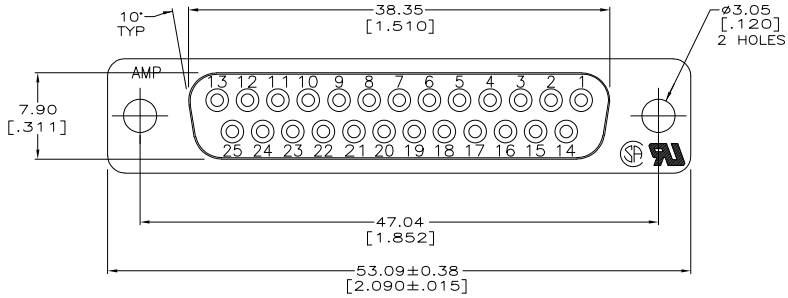

- △ HOUSING: BLACK POLYESTER, UL 94V-0 RATED. CONTACTS: PHOSPHOR BRONZE.
- △ GOLD FLASH FOR A LENGTH OF 2.54[.100] MIN FROM MATING END, 2.54µm[.000100] MIN TIN FOR A LENGTH OF 3.18[.125] FROM OPPOSITE END, ALL OVER 1.27µm[.000050] MIN NICKEL.
- △ 0.76µm[.000030] MIN GOLD FOR A LENGTH OF 2.54[.100] MIN FROM MATING END, 2.54µm[.000100] MIN TIN FOR A LENGTH OF 3.18[.125] FROM OPPOSITE END, ALL OVER 1.27µm[.000050] MIN NICKEL.

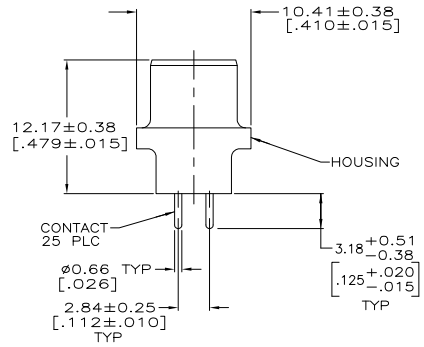
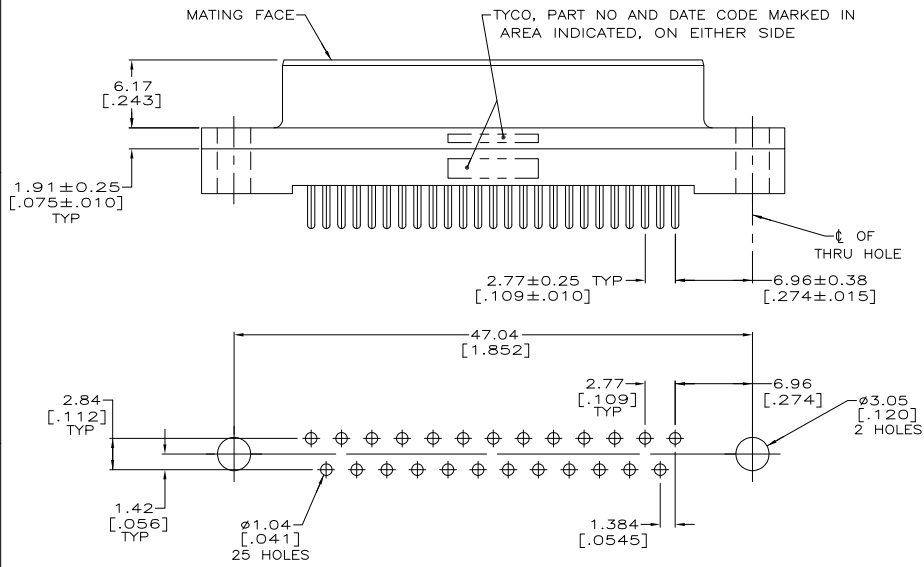

RECOMMENDED PC BOARD MOUNTING DIMENSIONS

**COPYRIGHT 2005  
 TYCO ELECTRONICS CORP  
 ALL RIGHTS RESERVED**

△	5207828-4
△	5207828-3
△	PART NO

THIS DRAWING IS A CONTROLLED DOCUMENT.		DR: C. PETERS	OBSEPOS	<b>tyco</b>	Tyco Electronics Corporation	
DIMENSIONS: INCHES		OK: S. BOLASH	OBSEPOS	<b>Electronics</b>	Harrisburg, PA 17105-3608	
OTHER DIMENSIONS UNLESS OTHERWISE SPECIFIED:		APP: M. WALMSLEY	OBSEPOS	RECEPTACLE ASSEMBLY, SIZE 3, 25 POSN, VERTICAL, AMPLIMITE HD-20		
0 PLC ±		PRODUCT SPEC: 108-40025	OBSEPOS	SIZE: A2	CAGE CODE: 00779	DRAWING NO: C=5207828
1 PLC ±		APPLICATION SPEC: -	OBSEPOS	RESTRICTED TO: -	-	
2 PLC ±		HEIGHT: -	OBSEPOS	SCALE: 4:1	SHEET: 1 of 1	REV: 0
3 PLC ±		FINISH: -	OBSEPOS	CUSTOMER DRAWING		
4 PLC ±		CONTACTS: SEE TABLE	OBSEPOS			

AMP 1471-9 REV 31MMR2000

5207828

A