

DESCRIPTION: MALE CENTRONICS BACKSHELL KIT

	A	B	C	D
14	1.496	1.008	1.577	.622
	38.00	25.60	40.06	15.80
24	1.919	1.436	1.560	.622
	48.75	36.47	39.61	15.80
36	2.431	1.935	1.624	.622
	61.76	49.15	41.25	15.80
50	3.026	2.531	1.730	.622
	76.86	64.29	43.95	15.80

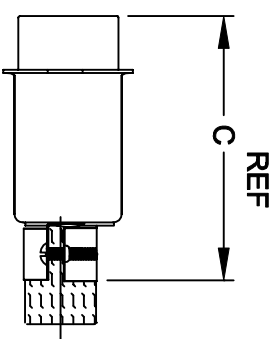
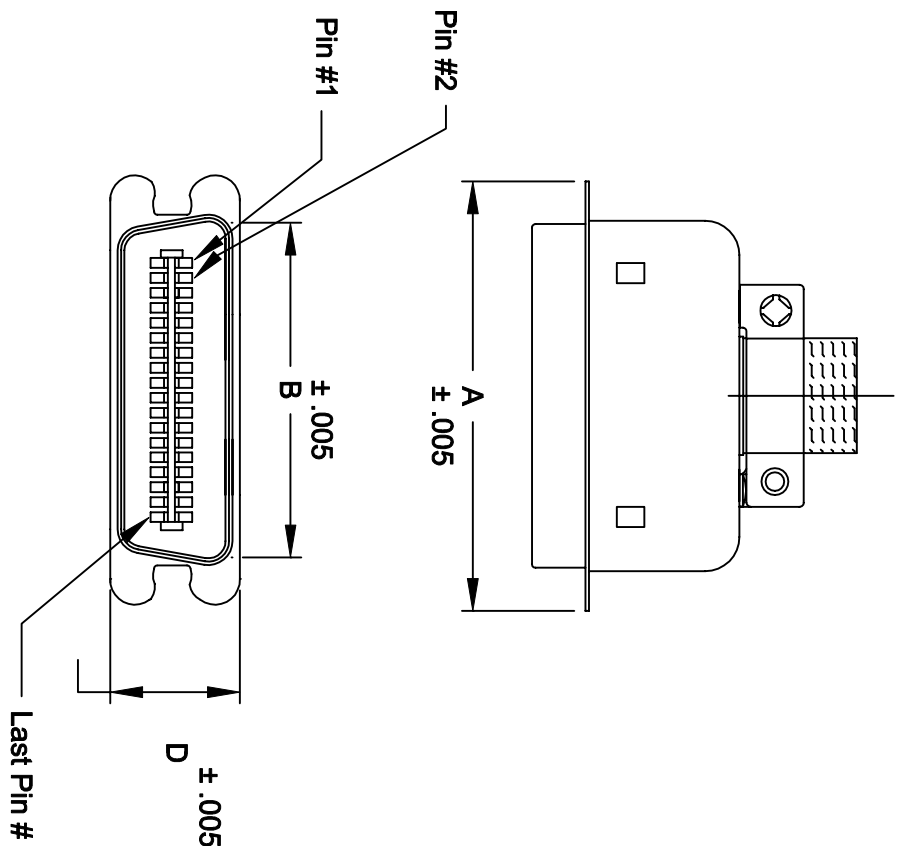

110-XXX-193-001

SERIES _____
 POSITIONS _____
 014 _____
 024 _____
 036 _____
 050 _____

GENDER _____
 1 = MALE
 2 = FEMALE

TERMINATION _____
 9 = IDC

SHELL PLATING _____
 3 = NICKEL
 HARDWARE OPTIONS _____
 00 = NO HARDWARE

PLATING OPTIONS _____
 01 = GOLD FLASH

MATERIALS:

INSULATOR: GLASS-FILLED THERMOPLASTIC

UL RATED 94V-0

CONTACTS: COPPER ALLOY

ELECTRICALS:

CONTACT CURRENT RATING: 5 AMPS

DIELECTRIC WITHSTANDING VOLTAGE: AC 1200 R.M.S.

INSULATION RESISTANCE: 1000 mohms MINIMUM AT 500V DC

CONTACT RESISTANCE: 30 MOHMS MAXIMUM

OPERATING TEMPERATURE: -55°C TO +125°C



THESE DRAWINGS AND SPECIFICATIONS ARE THE PROPERTY OF NorComp AND SHALL NOT BE REPRODUCED, COPIED OR USED AS THE BASIS FOR THE MANUFACTURE OF SALE OF APPARATUS WITHOUT WRITTEN PERMISSION.

NorComp

DRAWN: WAYNE ROBBINS	DATE: 9-17-98
CHECKED:	DATE:
SCALE: 1:1	SHEET 1 OF 1
DWG NO. 110-XXX-193-001	REV 2