

THIS DRAWING IS UNPUBLISHED. RELEASED FOR PUBLICATION .19
 © COPYRIGHT 19 BY AMP INCORPORATED. ALL INTERNATIONAL RIGHTS RESERVED.

LOC	DIST	P	F	ZONE	LTR	DESCRIPTION	DATE	APPD
CH	11							
					D	ECN96022902	07-30-93	P.G.
					C	EC OB20-1666-97	19/NOV/97	RNP
					E	EC OB20-1595-98	09/DEC/98	RNP
					F	EC OG3B-0280-01	15/JAN/02	GS
					G	EC OG3B-0280-01	17/JAN/02	GS
					G1	REVISED PER ECO-09-024717	07/OCT/09	AEG

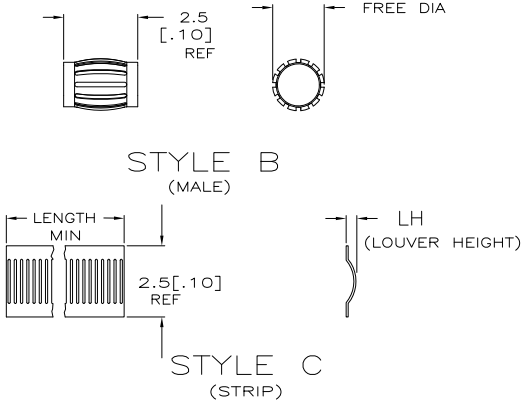

STYLE	FREE DIA	LENGTH	LH	MAT'L (NOTE)	MATING DIA REF	PLATING (NOTE)	NUM LOUV	MAT'L THK	REF	PART NO.
OBsolete	B [.375]	-- [.014]	8	9.5 [.375]	4-2 40	0.10 [.004]	--			2-192048-6
OBsolete	B [.06]	-- [.012]	8	1.7 [.067]	1-2 5	0.10 [.004]	--			2-192048-5
OBsolete	B [.20]	-- [.014]	--	--	3-2 20	0.10 [.004]	--			2-192048-4
OBsolete	--	--	--	--	--	--	--			2-192048-3
OBsolete	--	--	--	--	--	--	--			2-192048-2
OBsolete	B [.06]	-- [.012]	8	--	UNPL 5	0.10 [.004]	--			2-192048-1
OBsolete	C --	NOTE 6 [.014]	8	--	UNPL --	0.10 [.004]	--			2-192048-0
OBsolete	NOT AVAILABLE								06802	1-192048-9
OBsolete	B [.65]	-- [.012]	8	16.6 [.655]	2 71	0.10 [.004]	06050			1-192048-8
OBsolete	B [.65]	-- [.012]	8	16.6 [.655]	UNPL 71	0.10 [.004]	06049			1-192048-7
OBsolete	NOT AVAILABLE								06036	1-192048-6
OBsolete	B [.59]	-- [.012]	8	15.2 [.600]	UNPL 65	0.10 [.004]	06030			1-192048-5
OBsolete	B [.28]	-- [.012]	8	7.3 [.288]	UNPL 30	0.10 [.004]	06028			1-192048-4
OBsolete	B [.16]	-- [.012]	8	4.4 [.175]	3-2 17	0.10 [.004]	06038			1-192048-3
OBsolete	B [.16]	-- [.012]	8	4.4 [.175]	UNPL 17	0.10 [.004]	06039			1-192048-2
OBsolete	B [.13]	-- [.016]	8	3.2 [.127]	4-2 11	0.10 [.004]	06031			1-192048-1
OBsolete	B [.13]	-- [.016]	8	3.2 [.127]	UNPL 11	0.10 [.004]	06034			1-192048-0
OBsolete	B --	-- [.016]	8	3.2 [.127]	4-2 11	0.08 [.003]	06072			192048-9
OBsolete	B [.13]	-- [.016]	8	3.2 [.127]	UNPL 11	0.08 [.003]	06071			192048-8
OBsolete	B [.06]	-- [.012]	8	1.7 [.067]	4-2 5	0.10 [.004]	06060			192048-7
OBsolete	B [.05]	-- [.016]	8	1.3 [.051]	4-2 4	0.10 [.004]	06058			192048-6
OBsolete	B [.05]	-- [.016]	8	1.3 [.051]	UNPL 4	0.10 [.004]	06015			192048-5
OBsolete	NOT AVAILABLE								06059	192048-4
OBsolete	C --	NOTE 7 [.014]	8	--	4-2 --	0.10 [.004]	06032			192048-3
OBsolete	C --	NOTE 6 [.014]	8	--	3-2 --	0.10 [.004]	06051			192048-2
OBsolete	C --	NOTE 7 [.014]	8	--	UNPL --	0.10 [.004]	06033			192048-1

- 1. FINISH—SILVER PLATE 200 μIN THICK MIN.
- 2. FINISH—NICKEL PLATE 40 μIN THICK MIN.
- 3. FINISH—GOLD PLATE 10 μIN THICK MIN.
- 4. FINISH—GOLD PLATE 20 μIN THICK MIN.
- 5. PLATING NOTES ARE TO BE INTERPRETED AS FOLLOWS, 3-2 AS 3 OVER 2.
- 6. PRODUCT IS SOLD BY THE FOOT.
- 7. 72 INCH STRIP WOUND TO A ONE INCH INSIDE DIAMETER.
- 8. MATERIAL—BeCu (CDA172).
- 9. PRELIMINARY PART NUMBER
- 10. OBSOLETE PARTS: OBSOLETE CIS STREAMLINING PER D.RENAUD/D.SINISI

THIS DRAWING IS A CONTROLLED DOCUMENT FOR AMP INCORPORATED. IT IS SUBJECT TO CHANGE AND THE CONTROLLING ENGINEERING ORGANIZATION SHOULD BE CONTACTED FOR THE LATEST REVISION.

DO NOT SCALE PRINT. UNLESS SPECIFIED DIMENSIONS IN mm [INCHES] TOLERANCES ON: 2 PLC DEC ±0.5 [.02] 3 PLC DEC ±0.25 [.010] ANGLES ± -	DR RA JAYNE 06-12-92 CHK - APPD - MATERIAL - SEE TABLE	AMP AMP Incorporated Harrisburg, PA 17105-3608 NAME CONTACT BAND, MALE DRAWING NO C-192048
FINISH - SEE TABLE	APPLICATION SPEC - WEIGHT -	SIZE C 00779 CAGE CODE - DRAWING NO C-192048 SCALE NTS SHEET 1 OF 1

CUSTOMER DRAWING