

THIS DRAWING IS UNCLASSIFIED	REVISIONS FOR PUBLICATION
DATE: 08/01/85	BY: AMP INCORPORATED, ALL RIGHTS RESERVED

REV	DATE	DESCRIPTION	BY	CHK	APP
0		RELEASED PER NPR 5579	-	-	-
1	96-1999-10-2	WAS			
A		REV PER EC 0410-361-97	10 SEP 97	CD	JM

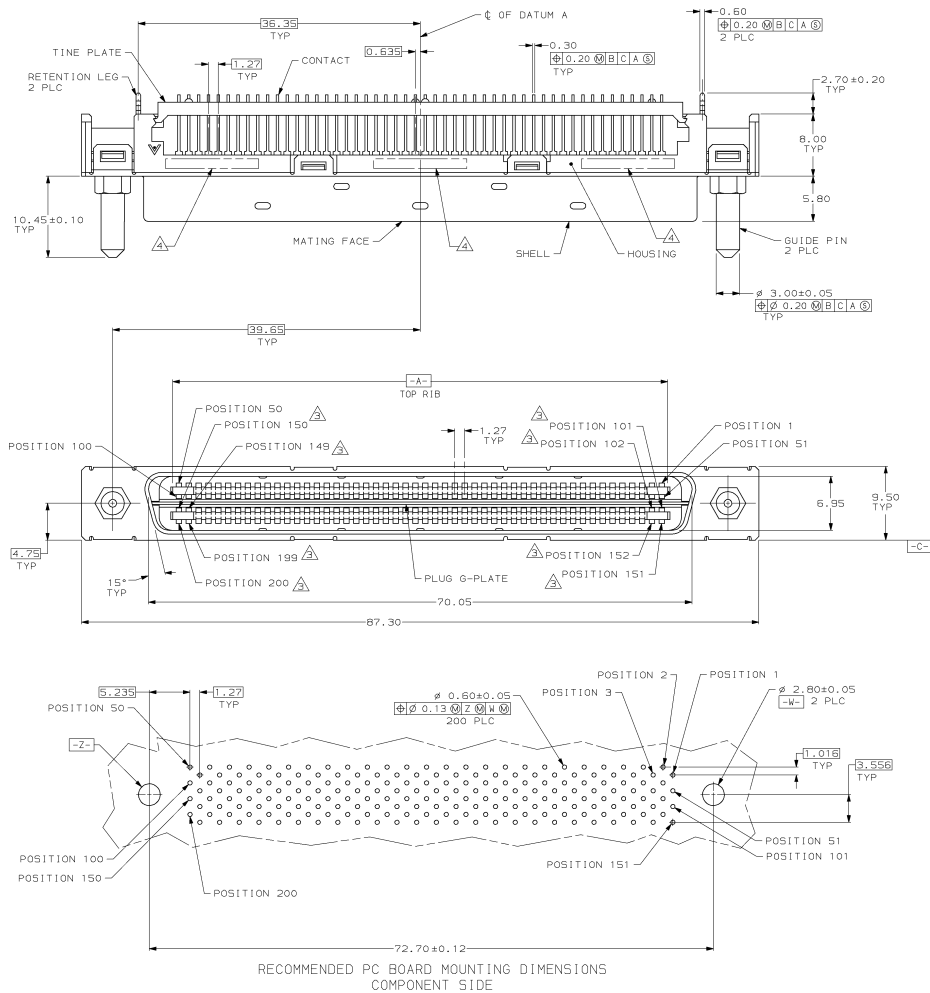

- △ HOUSING AND TINE PLATE; POLYESTER, NATURAL.
- CONTACT; COPPER ALLOY.
- SHELL; CARBON STEEL.
- RETENTION LEG AND GUIDE PIN; BRASS.
- PLUG G-PLATE; STAINLESS STEEL.
- △ SHELL; 3.00µm MIN NICKEL OVER 1.30µm MIN COPPER.
- RETENTION LEG; 2.00µm MIN TIN-LEAD OVER 1.00µm MIN NICKEL.
- GUIDE PIN; NICKEL OVER COPPER.
- CONTACTS; 0.75µm MIN GOLD FOR A LENGTH OF 3.00 MIN FROM MATING END, 2.54 µm MIN TIN-LEAD FOR A LENGTH OF 2.80 MIN FROM OPPOSITE END, BOTH OVER 1.27µm MIN NICKEL.
- △ CONTACTS 101, 102, 149, 150, 151, 152, 199, AND 200, ARE SEQUENCED TOWARDS MATING FACE.
- △ DATE CODE MAY BE MARKED ON THIS SIDE, IN ONE OF THE LOCATIONS SHOWN.

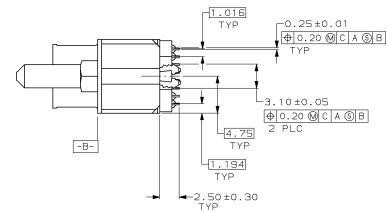

787887-1
PART NUMBER

THIS DRAWING IS A CONTROLLED DOCUMENT.		DATE: 09 JAN 97	AMP Incorporated Harrisburg, PA 17105-3608
DESIGNED BY: [Signature]	DESIGNED: [Signature]	DATE: 11 JAN 97	PLUG ASSEMBLY, 200 POSITION, VERTICAL, "OSO, CHAMP™"
DATE: [Signature]	DATE: [Signature]	DATE: [Signature]	
SIZE: [Signature]	SIZE: [Signature]	SIZE: [Signature]	REVISED TO: [Signature]
CUSTOMER DRAWING	DATE: [Signature]	DATE: [Signature]	DATE: [Signature]