

4

3

2

1

THIS DRAWING IS UNPUBLISHED. RELEASED FOR PUBLICATION
 © COPYRIGHT 20- BY TYCO ELECTRONICS CORPORATION. ALL RIGHTS RESERVED.

LOC		DIBT		REVISIONS			
F	LTR	DESCRIPTION	DATE	BY	APP'D		
0		RELEASED PER EC 0513-0556-04	08-02-05	JA	JG		

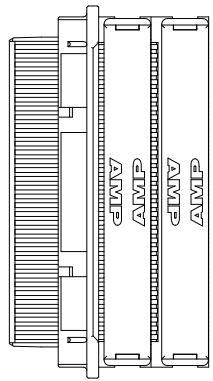
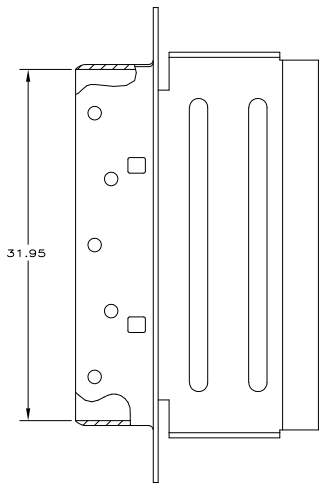

- △ MATERIAL:
 PLUG CONTACTS - BERYLLIUM COPPER.
 PLUG SHELL - CARBON STEEL.
 PLUG HOUSING - LCP, NATURAL, RATED UL 94V-0.
 TERMINATION COVERS - LCP, BLACK, RATED UL 94V-0.

- △ PLATING:
 PLUG CONTACTS - 0.76µm MINIMUM GOLD PLATE IN LOCALIZED GOLD PLATE AREA, 1.27µm MINIMUM TIN PLATE IN TERMINATION AREA, ALL OVER 1.27µm MINIMUM NICKEL.
 PLUG SHELL - 5.08µm MINIMUM NICKEL OVER 1.27µm MINIMUM COPPER.

- △ TERMINATION COVERS AND PLUG SHELL ARE PACKAGED UNASSEMBLED.

- 4. RECOMMENDED WIRE: 28 AWG WITH A 0.64-0.72 INSULATION DIAMETER, WIRE MUST BE APPROVED BY TYCO ELECTRONICS ENGINEERING.

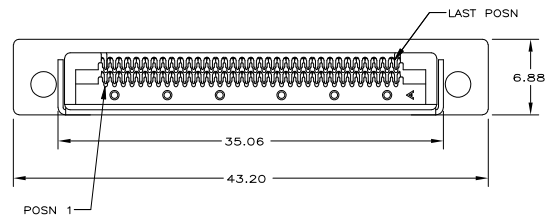
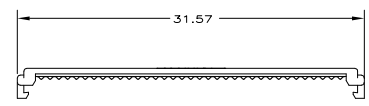
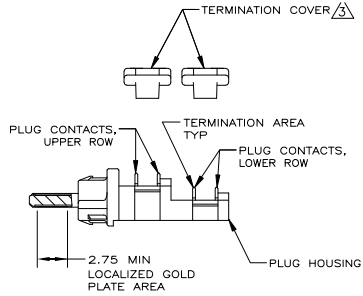
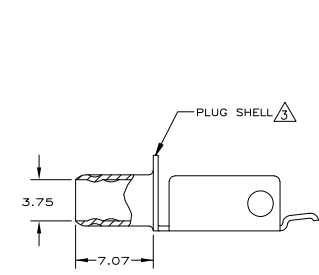

6364.308-1
 PART NO.

**COPYRIGHT 2005
 TYCO ELECTRONICS CORP
 ALL RIGHTS RESERVED**

THIS DRAWING IS A CONTROLLED DOCUMENT.		BY: J. ALCORTA	08-02-05		Tyco Electronics Corporation	
		CHK: S. SHUEY	08-02-05		Harrisburg, Pa 17105-3608	
DIMENSIONS: mm		APPROVED: M. WALMSLEY	08-02-05	NAME: PLUG KIT, 28 AWG, UNASSEMBLED, 68 POSITION		
TOLERANCES UNLESS OTHERWISE SPECIFIED:		PRODUCT SPEC: 108-1471		CHAMP 0mm OFFSET CABLE CONNECTOR.		
0 PLG	± .-	APPLICATION SPEC: -		SIZE	ONE CASE (PARTS 10)	RESTRICTED TO
1 PLG	± .-	WEIGHT: -		A2	00779	©-6364308
2 PLG	± 0.13	FINISH: -		CUSTOMER DRAWING		
3 PLG	± .-			SCALE	4:1	SHEET 1 OF 1
4 PLG	± .-			REV Q		

AMP 1471-9 REV 31MM2000

6364.308

A