

1. THE CONTACT SURFACES OF THE TERMINALS ARE COATED WITH LUBRICANT.
- ⚠ ALL DIMENSIONS SHOWN ARE FOR REFERENCE ONLY UNLESS OTHERWISE SPECIFIED.
 - ⚠ MATERIAL: HOUSING - THERMOPLASTIC, BLACK.
 TERMINAL - PHOS BRONZE PLATED WITH EITHER .000030 MINIMUM GOLD PLATE OR GOLD FLASH OVER PALLADIUM NICKEL PLATE, .000030 MINIMUM TOTAL ON MATING SURFACE. .000120 MINIMUM TIN PLATE ON TAILS OVER .000050 MINIMUM NICKEL UNDERPLATE OVER ENTIRE TERMINAL.

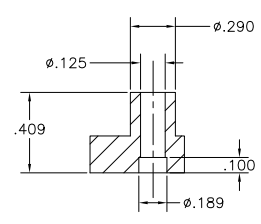
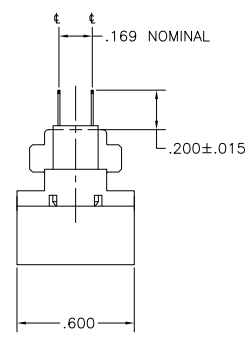

DETAIL A
BOTH ENDS

5552209-1
PART NUMBER

THIS DRAWING IS A CONTROLLED DOCUMENT.		DATE	BY	REVISION	APPROVED
DATE	BY	REVISION	APPROVED	TTE Electronics Corporation Harrisburg, PA 17105-3608	
DATE	BY	REVISION	APPROVED	PLUG ASSY, 14 POS/VERT MTC, W/ STANDOFF, CHAMP-LOK	
DATE	BY	REVISION	APPROVED	SIZE	DATE
DATE	BY	REVISION	APPROVED	A1	00779
DATE	BY	REVISION	APPROVED	CUSTOMER DRAWING	