

4

3

2

1

THIS DRAWING IS UNPUBLISHED. RELEASED FOR PUBLICATION
 © COPYRIGHT BY TYCO ELECTRONICS CORPORATION. ALL RIGHTS RESERVED.

LOC	DIST	REVISIONS					
GP	00	P	LTR	DESCRIPTION	DATE	MIN	APD
		A		RELEASED	17APR07	BM	WM

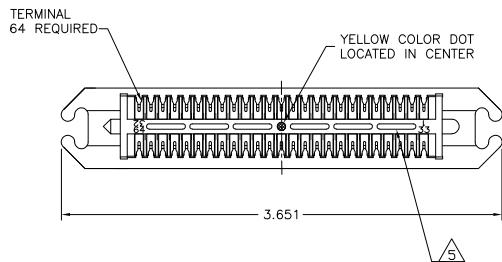

1. THE CONTACT SURFACES OF THE TERMINALS ARE COATED WITH LUBRICANT.
2. ALL DIMENSIONS SHOWN ARE FOR REFERENCE ONLY UNLESS OTHERWISE SPECIFIED.

3. MATERIAL:
 HOUSING: THERMOPLASTIC, COLOR: BLACK
 TERMINALS: HIGH STRENGTH COPPER ALLOY PLATED WITH .000030 MIN GOLD OR GOLD FLASH OVER .000030 MIN PALLADIUM NICKEL ON CONTACT MATING SURFACE .000050 MIN NICKEL UNDERPLATE OVER ENTIRE TERMINAL.

4. WIRE SIZE: 26, 27 & 28 AWG, 7 STRANDS OF COPPER CONDUCTORS. MAXIMUM INSULATION DIAMETER OF .045 IS ACCEPTABLE FOR MOST APPLICATIONS.
5. COATING MAY OR MAY NOT APPEAR AND IS AT THE DISCRETION OF TYCO.

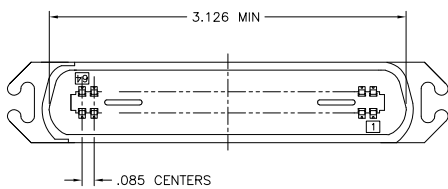
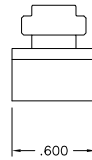
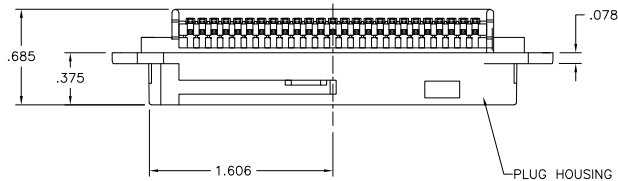

1888845-1
 PART
 NUMBER

THIS DRAWING IS A CONTROLLED DOCUMENT.		DR. S. MCMASTER	220E008	Tyco Electronics Corporation
DIMENSIONS:		DR. W. MILLHIMES <td>220E008 <td>Harrisburg, PA 17105-3608</td> </td>	220E008 <td>Harrisburg, PA 17105-3608</td>	Harrisburg, PA 17105-3608
INCHES		DR. W. MILLHIMES <td>220E008 <td>NAME</td> </td>	220E008 <td>NAME</td>	NAME
OTHER DIMENSIONS:		PRODUCT SPEC		ASSEMBLY, PLUG, 64 POSITION, E SLOT (CHAMP-LOK, BAIL LOCK)
APPLICATION SPEC		SIZE	DATE CODE	DRAWING NO.
MATERIAL		WEIGHT	A2	00779 C=1888845
FINISH		CUSTOMER DRAWING	SCALE	2:1 SHEET 1 of 1 REV A
RESTRICTED TO				