

NUMBER C-1734375
METRIC
3RD ANGLE PROJECTION

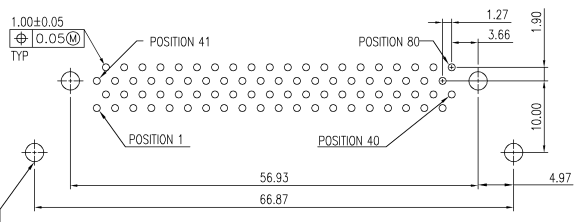

RECOMMENDED PC BOARD LAYOUT
VIEWED FROM CONNECTOR SIDE

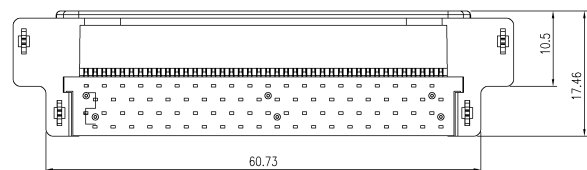
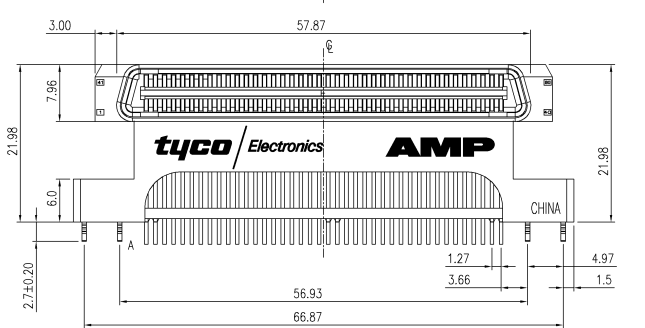
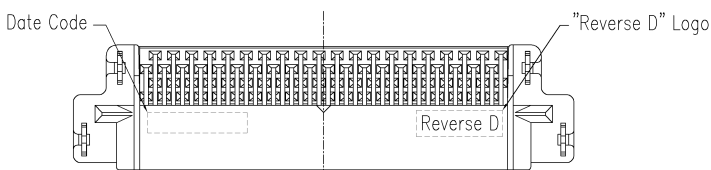
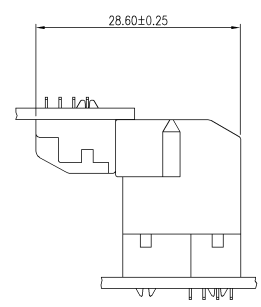
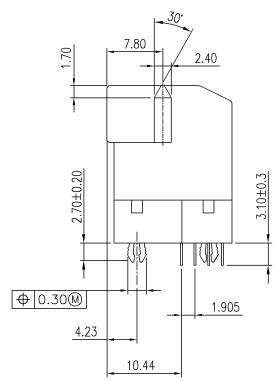

RIGHT ANGLE PLUG ASSEMBLY MATED
WITH RIGHT ANGLE RECEPTACLE ASSEMBLY

- NOTE:
- MATERIAL:
HOUSING: LCP, UL 94V-0, COLOR: BLACK.
CONTACT: PHOSPHOR BRONZE, THICKNESS=0.30mm.
RETENTION LEGS: BRASS, THICKNESS=0.50mm.
 - FINISH:
CONTACT: 0.762um [30u"] MIN. GOLD PLATED IN CONTACT AREA,
3.8um [150u"] MIN. MATTE TIN PLATED ON SOLDER TAILS,
1.27um [50u"] MIN. NICKEL UNDERPLATED ALL OVER.
RETENTION LEGS: 3.8um [150u"] MIN. TIN-CU PLATED OVER 1.27um [50u"] MIN. NICKEL PLATED.
 - ALWAYS RoHS/ELV COMPLIANT
 - WAVE SOLDER CAPABLE TO 265°C PER TYCO SPEC 109-202, CONDITION B.

THIS INFORMATION IS CONFIDENTIAL AND IS PROVIDED TO YOU ON THE CONDITION THAT NO FURTHER DISCLOSURE IS MADE BY YOU TO OTHER THAN AMP PERSONNEL WITHOUT THE WRITTEN PERMISSION OF AMP. DO NOT SCALE PRINT.

PRINT DW

B	CHANGE PLATING SPEC	ECR-06-024892	OH	SH	27OCT	2006
A	ADD P/N 1-, -1	F200-0022-05	OH	SH	04FEB	2005
O	FIRST RELEASED	F200-0175-04	OH	SH	30JUL	2004
LTR	REVISION RECORD	ECN	DWN	CHK	DATE	

TOLERANCES UNLESS OTHERWISE SPECIFIED:		DWN	O. HU	24-OCT-2006		TYCO HOLDINGS (BERMUDA) VII LTD. TAIWAN BRANCH
0	PLC ± 0.38	CHK	S. HOU	24-OCT-2006		NAME
1	PLC ± 0.25	MATERIAL		APVD	W.J. KE	24-OCT-2006
2	PLC ± 0.13	SEE NOTE		PRODUCT SPEC	CHAMP 1.27, SERIES I, PLUG ASS'Y, R/A, EXTENDED HEIGHT	
3	PLC ± 0.05	FINISH		QUALIFICATION TEST REPORT	LOC	SIZE
ANGLES ± 3°		SEE NOTE		WEIGHT	DW	A ₃
					SCALE	C-1734375
					DRAWING NO	REV
						B
					SHEET	1 OF 3

8 7 6 5 4 3 2 1 CUSTOMER DRAWING

NUMBER C-1734375
METRIC
3RD ANGLE PROJECTION

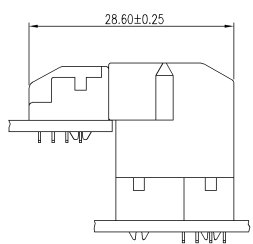
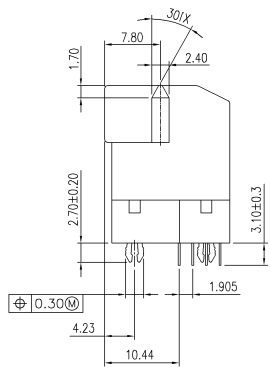
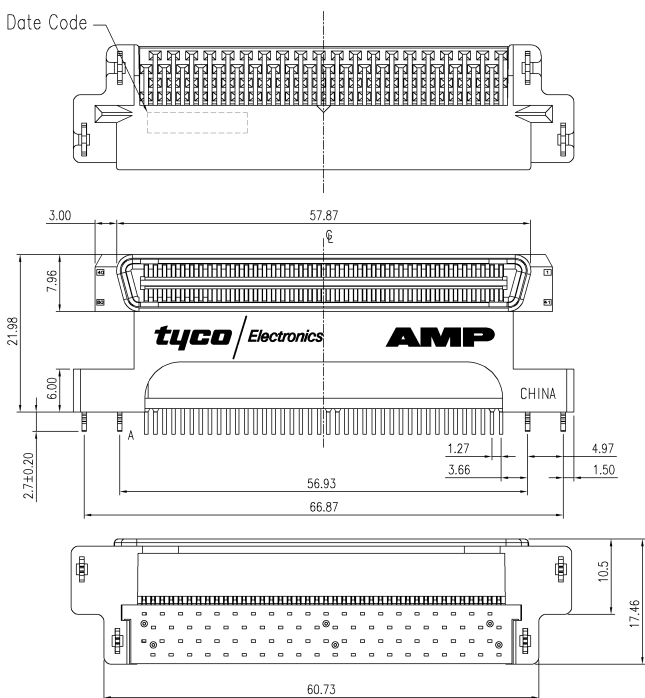

RIGHT ANGLE PLUG ASSEMBLY MATED WITH RIGHT ANGLE RECEPTACLE ASSEMBLY

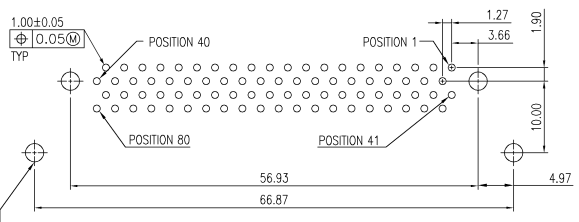

RECOMMENDED PC BOARD LAYOUT VIEWED FROM CONNECTOR SIDE

TOLERANCES UNLESS OTHERWISE SPECIFIED:		DWN	O. HU	NORMAL		1-1734375-1
0 PLC ± 0.38		CHK	24-OCT-2006	INTERFACE		PART NUMBER
1 PLC ± 0.25		S. HOU		TYCO Electronics		
2 PLC ± 0.13		24-OCT-2006		TYCO HOLDINGS (BERMUDA) VII LTD. TAIWAN BRANCH		
3 PLC ± 0.05		W.J. KE		NAME		
ANGLES ± 3°		24-OCT-2006		CHAMP 1.27, SERIES I, PLUG ASS'Y, R/A, EXTENDED HEIGHT		
MATERIAL	SEE NOTE	APVD	---	LOC	SIZE	DRAWING NO
FINISH	SEE NOTE	QUALIFICATION TEST REPORT	---	DW	A ₃	C-1734375
		WEIGHT	---	SCALE	---	SHEET
						2 OF 3

SEE SHEET 1	ECN	DWN	CHK	DATE
LTR	REVISION RECORD			

PRINT DW
THIS INFORMATION IS CONFIDENTIAL AND IS PROVIDED TO YOU ON THE CONDITION THAT NO FURTHER DISCLOSURE IS MADE BY YOU TO OTHER THAN AMP PERSONNEL WITHOUT THE WRITTEN PERMISSION OF AMP. DIMENSIONS IN MILLIMETERS. DO NOT SCALE PRINT.

8 | 7 | 6 | 5 | 4 | 3 | 2 | 1
CUSTOMER DRAWING

D
C
B
A

NUMBER C-1734375
 METRIC
 3RD ANGLE PROJECTION

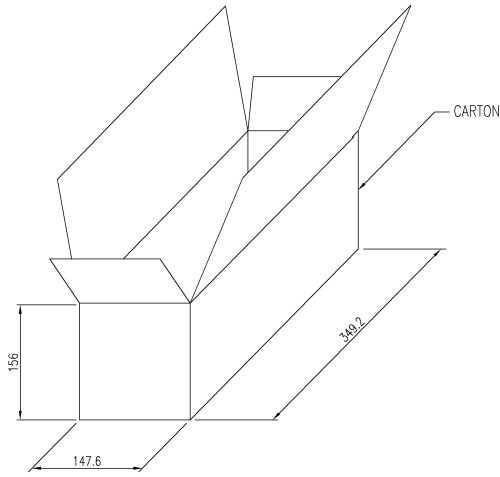
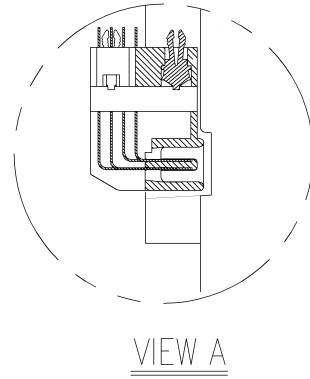
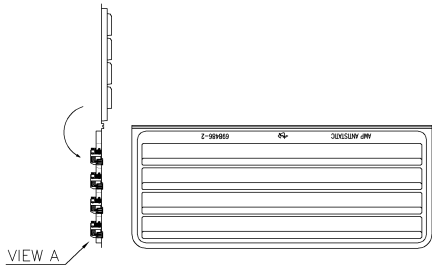

THIS INFORMATION IS CONFIDENTIAL AND IS DISCLOSED TO YOU ON CONDITION THAT NO FURTHER DISCLOSURE IS MADE BY YOU TO OTHER THAN AMP PERSONNEL WITHOUT DIMENSIONS IN MILLIMETERS. DO NOT SCALE PRINT.

PRINT DW
 DIST

SEE SHEET 1.	ECN	DWN/CHK	DATE
LTR	REVISION RECORD		

2.46	1.46	128	8	16	1-1734375-1
G.W(KGS)	N.W(KGS)	PACKAGING QUANTITY/BOX	TRAY/BOX	PCS/TRAY	PART NUMBER
TOLERANCES UNLESS OTHERWISE SPECIFIED:		DWN	O. HU	TYCO	
0 PLC ±		24-OCT-2006		TYCO HOLDINGS (BERMUDA)	
1 PLC ±		S. HOU		VII LTD. TAIWAN BRANCH	
2 PLC ±		24-OCT-2006		NAME	
3 PLC ±		W.J. KE		CHAMP 1.27, SERIES I, PLUG	
ANGLES ±		24-OCT-2006		ASS'Y, R/A, EXTENDED HEIGHT	
MATERIAL	APVD	PRODUCT SPEC			
--	--	-			
FINISH	QUALIFICATION TEST REPORT	LOC	SIZE	DRAWING NO	REV
--	--	DW	A ₃	C-1734375	B
WEIGHT		SCALE	SHEET		
-		--	3 OF 3		

CUSTOMER DRAWING