

4

3

2

1

THIS DRAWING IS UNPUBLISHED. RELEASED FOR PUBLICATION
 BY TYCO ELECTRONICS CORPORATION. ALL RIGHTS RESERVED.

LOC	DIST	REVISIONS		DATE	BY	APP'D
GP	00	F	LR			
		K		REVISED PER ECO-08-007327	OSSEPOB	BM WM

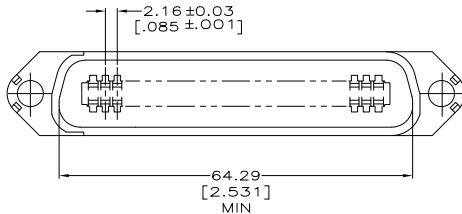
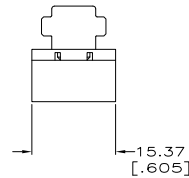
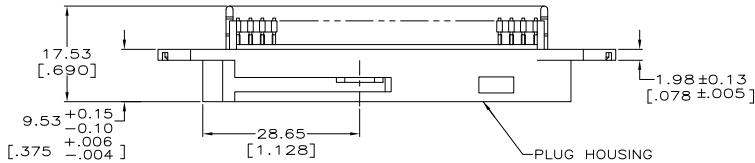
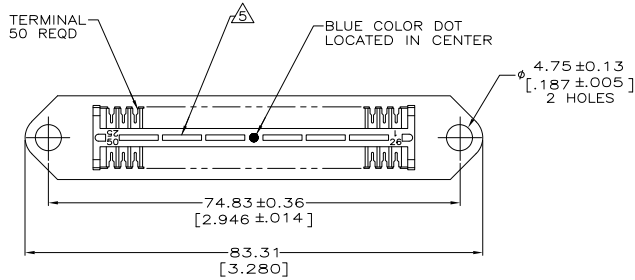

1. THE CONTACT SURFACES OF THE TERMINALS ARE COATED WITH LUBRICANT.

2. DIMENSIONS SHOWN ARE MAXIMUM UNLESS OTHERWISE SPECIFIED.

3. MATERIAL: HOUSING - THERMOPLASTIC
 TERMINAL - HIGH STRENGTH COPPER ALLOY PLATED WITH 0.76μm [.000030] MIN GOLD OR GOLD FLASH OVER PALLADIUM NICKEL PLATE, 0.76μm [.000030] MIN TOTAL ON MATING SURFACE, OVER 1.27μm [.000050] MIN NICKEL PLATING.

4. WIRE SIZE: 24 & 26 SOLID OR 24 AWG 7 STRANDS OF COPPER CONDUCTORS. MAX INSULATION DIAMETER OF .045 IS ACCEPTABLE FOR MOST APPLICATIONS.

5. CORING MAY OR MAY NOT APPEAR AND IS AT THE DISCRETION OF AMP INCORPORATED.

GRAY	552686-2
BLACK	552686-1
COLOR	PART NUMBER

DIMENSIONS		TOLERANCES UNLESS SPECIFIED		APPROVED		TYCO ELECTRONICS CORPORATION	
mm	[INCHES]	0 PLG	± .00	DM	T. SPRINKLE/UTA	2-15-94	Harrisburg, PA 17105-3608
		1 PLG	± .00	CHK	N. JONES	3-28-94	
		2 PLG	± .00	APP'D	J. HARRIS	3-28-94	
		3 PLG	± .00	NAME			
		4 PLG	± .00	APPLICATION SPEC			
		ANGLES	± .00	PRODUCT SPEC			
		FINISH		WEIGHT			
MATERIAL				SIZE	A2	00779	C=552686
				RESTRICTED TO			
				CUSTOMER DRAWING			
				SCALE	2:1	SHEET	1 of 1
						REV	K

AMP 1471-9 REV 31MM2000

552686

A