

4

3

2

1

THIS DRAWING IS UNPUBLISHED. RELEASED FOR PUBLICATION
 © COPYRIGHT BY TYCO ELECTRONICS CORPORATION. ALL RIGHTS RESERVED.

LOC	DIST	REVISIONS				
GP	00	P	LTR	DATE	BY	APPD
		P		REVISED PER ECO-08-007327	14OCT08	BM WM

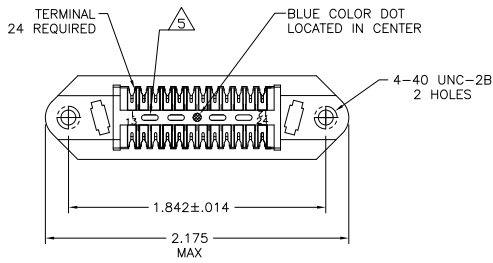

1. THE CONTACT SURFACES OF THE TERMINALS ARE COATED WITH LUBRICANT.
2. ALL DIMENSIONS SHOWN ARE FOR REFERENCE ONLY UNLESS OTHERWISE SPECIFIED.

△ MATERIAL:
 HOUSING - THERMOPLASTIC (BLACK)
 TERMINALS - HIGH STRENGTH COPPER ALLOY PLATED WITH .000030 MIN GOLD OR GOLD FLASH OVER PALLADIUM NICKEL PLATE .000030 MIN TOTAL ON MATING SURFACE. .000050 MIN NICKEL UNDERPLATE OVER ENTIRE TERMINAL.

4. WIRE SIZE: 24 & 26 AWG SOLID & 24 AWG 7 STRANDS OF COPPER CONDUCTORS. MAX INSULATION DIAMETER OF .045 IS ACCEPTABLE FOR MOST APPLICATIONS.

△ CORING MAY OR MAY NOT APPEAR AND IS AT THE DISCRETION OF TYCO ELECTRONICS.

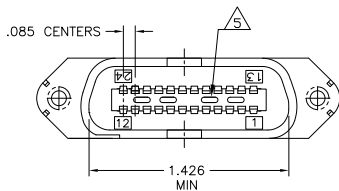
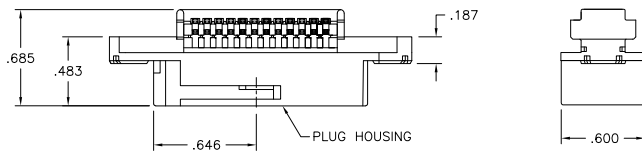

552283-1
 PART NUMBER

THIS DRAWING IS A CONTROLLED DOCUMENT.		DR. S. MCMASTER 050CT05	Tyco Electronics Corporation Harrisburg, PA 17105-3608	
DIMENSIONS:		CR. W. MILLIMETERS 050CT05	Tyco Electronics	
INCHES		APD. W. MILLIMETERS 050CT05	ASSEMBLY, PLUG, 24 POSITION, B-SLOT CHAMP-LOK W/ 4-40 HOLES	
OTHER DIMENSIONS:		PRODUCT SPEC	SIZE	CAGE CODE (FOWING 90)
0 PLG	±	APPLICATION SPEC	A2	00779
1 PLG	±	WEIGHT	C=552283	
2 PLG	±	FINISH	RESTRICTED TO	
3 PLG	±		CUSTOMER DRAWING	
4 PLG	±		SCALE NTS SHEET 1 of 1 REV P	
ANGLES	±			