

4

3

2

1

THIS DRAWING IS UNPUBLISHED. RELEASED FOR PUBLICATION. ALL RIGHTS RESERVED.

LOC	DIST	REVISIONS		
GP	00	P	LTR	DESCRIPTION
		K1	REVISED PER ECO-11-004835	DATE
				11MAR11
				BY
				RK HMR

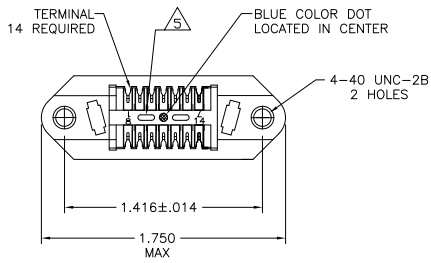

1. THE CONTACT SURFACES OF THE TERMINALS ARE COATED WITH LUBRICANT.
 2. ALL DIMENSIONS SHOWN ARE FOR REFERENCE ONLY UNLESS OTHERWISE SPECIFIED.
- △ MATERIAL:
- HOUSING - THERMOPLASTIC (BLACK)
- TERMINALS: - HIGH STRENGTH COPPER ALLOY PLATED WITH .000030 MIN GOLD OR GOLD FLASH OVER PALLADIUM NICKEL PLATE .000030 MIN TOTAL ON MATING SURFACE. .000050 MIN NICKEL UNDERPLATE OVER ENTIRE TERMINAL.
4. WIRE SIZE: 24 & 26 AWG SOLID & 24 AWG 7 STRANDS OF COPPER CONDUCTORS. MAX INSULATION DIAMETER OF .045 IS ACCEPTABLE FOR MOST APPLICATIONS.
- △ CORING MAY OR MAY NOT APPEAR AND IS AT THE DISCRETION OF TE CONNECTIVITY.

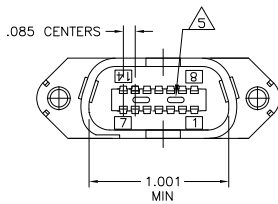
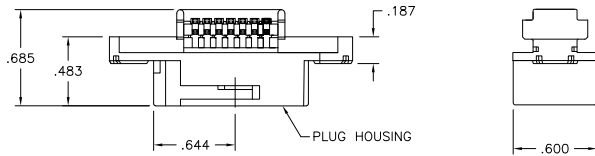

552282-1
PART NUMBER

THIS DRAWING IS A CONTROLLED DOCUMENT.		DR. S. MCMASTER 050205	TE Connectivity	
DIMENSIONS:		CR. W. MILLIMETERS 050205	NAME	
INCHES		APP. W. MILLIMETERS 050205	ASSEMBLY, PLUG, 14 POSITION, B-SLOT	
OTHER DIMENSIONS:		PRODUCT SPEC	CHAMP-LOK W/ 4-40 HOLES	
0 PLC		APPLICATION SPEC	SIZE	RESTRICTED TO
1 PLC		WEIGHT	A2	00779
2 PLC		FINISH	C=552282	552282
3 PLC				
4 PLC				
ANGLES				
MATERIAL				
FINISH				
△				
△				
CUSTOMER DRAWING		SCALE	NTS	SHEET 1 of 1
				REV K1

1471-9 (3/11)

552282

A