

4 3 2 1

THIS DRAWING IS UNPUBLISHED. RELEASED FOR PUBLICATION. BY AMP INCORPORATED. ALL RIGHTS RESERVED.

REV	DATE	BY	APPD	DESCRIPTION
W	28 OCT 97	TS	SB	OBsolete -16 & REDRAWN ON CAD PER EC 0420-143-96
Y	18 MAR 99	DB	RT	REV PER EC 0640-441-98
Z	27 OCT 98	DB	JK	REV PER EC 001D-0246-00
AA	12 SEP 91	JR	JG	REV PER EC 001D-0260-00
AZ	09 JAN 02	JR	J6	REV PER EC 00E0-0002-01

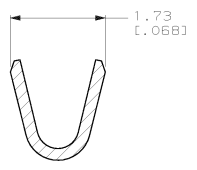
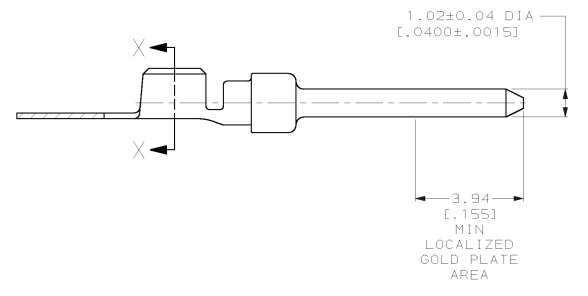
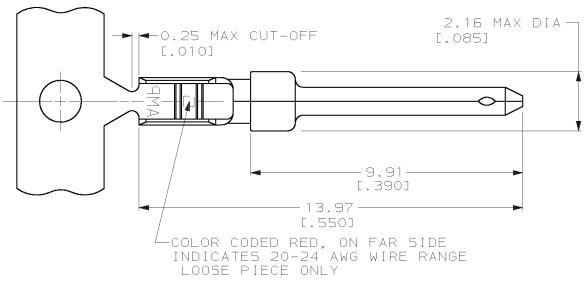

SECTION X-X
WIRE BARREL
SCALE 20:1

- ⚠ FOR MINI-APPLICATOR.
- ⚠ FOR HAND TOOL USE ONLY.
- ⚠ FOR STANDARD APPLICATOR PART #566051 & #566110 ONLY.
- 4. WIRE RANGE OF 20-24 AWG, .068 MAX INSULATION DIA.
- 5. GOLD PLATING MAY NOT APPEAR ON CARRIER STRIP.
- ⚠ GOLD PLATING PER MIL-G-45204, NICKEL PLATING PER QQ-N-290, TIN PLATING PER MIL-T-10727.
- ⚠ GOLD PLATED IN LOCALIZED GOLD PLATED AREA, 0.76μm [.000030] GOLD IN MATED AREA, GOLD FLASH ON REMAINDER, OVER 1.27μm [.000050] NICKEL.
- ⚠ PLATED WITH GOLD FLASH OVER 0.76μm [.000030] NICKEL.
- ⚠ PLATED WITH 2.54μm-5.08μm [.000100-.000200] TIN.
- ⚠ PLATED WITH GOLD FLASH IN LOCALIZED GOLD PLATE AREA, TIN PLATED WIRE BARREL, OVER 0.76μm [.000030] NICKEL.
- ⚠ GOLD PLATED IN LOCALIZED GOLD PLATED AREA, 0.76μm [.000030] GOLD IN MATED AREA, TIN PLATED WIRE BARREL, OVER 1.27μm [.000050] NICKEL.

SUPERSEDED BY 205202-2	STANDARD	⚠	⚠	STRIP	2-205202-5
SUPERSEDED BY 205202-6	STANDARD	⚠	⚠	STRIP	2-205202-2
SUPERSEDED BY 205202-6	STANDARD	⚠	⚠	STRIP	1-205202-4
	STANDARD	⚠	⚠	LOOSE PIECE	205202-7
	STANDARD	⚠	⚠	STRIP	205202-6
OBSOLETE	STANDARD	⚠	⚠	LOOSE PIECE	205202-4
	STANDARD	⚠	⚠	STRIP	205202-2
	PACKAGING TYPE	FINISH	USE	TYPE	PART NUMBER

THIS DRAWING IS A CONTROLLED DOCUMENT.		DN S. WELDON 9-9-96	AMP AMP Incorporated Harrisburg, PA 17105-3608
DIMENSIONS: mm (INCHES)		CHK. T. RICHARD 9-9-96	
SYMBOLS AND ABBREVIATIONS		DATE 9-10-96	NAME
DIMENSIONS (INCHES)		SYMBOLS AND ABBREVIATIONS	PRODUCT SPEC.
MATERIAL		APPLICATION SPEC.	114-10000
FINISH		REWORK	A200779
SEE TABLE		CUSTOMER DRAWING	SCALE 10:1 SHEET 1 OF 1 REV A7

205202