

4

3

2

1

THIS DRAWING IS UNPUBLISHED. RELEASED FOR PUBLICATION. ALL RIGHTS RESERVED.

LOC	DIST	REVISIONS					
FT	0	F	LNK	DESCRIPTION	DATE	OWN	APPD
		G2		REVISED PER ECO-11-004820	11MAR11	RK	HMR

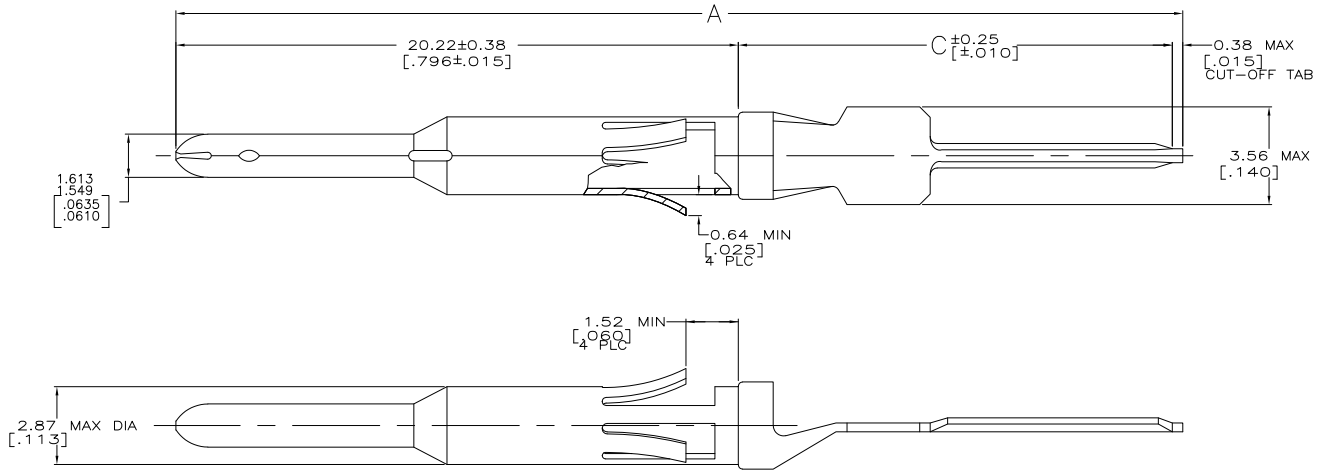

- △ BRASS PER MIL-C-50.
- △ 0.76um [.000030] MIN GOLD FOR A LENGTH OF 3.81 [.150] MIN ON CONTACT END, 1.27um [.000050] MIN TIN-LEAD ON OPPOSITE END, BOTH OVER 1.27um [.000050] MIN NICKEL ON ENTIRE CONTACT.
- 3. GOLD PLATING PER MIL-G-45204; TIN PLATING PER MIL-T-10727; NICKEL PLATING PER QQ-N-290.
- △ 0.76um [.000030] MIN GOLD FOR A LENGTH OF 3.81 [.150] MIN ON CONTACT END, 1.27um [.000050] MIN TIN ON OPPOSITE END, BOTH OVER 1.27um [.000050] MIN NICKEL ON ENTIRE CONTACT.
- △ OBSOLETE PARTS: OBSOLETE CIS STREAMLINING PER D.RENAUD/D.SINISI

△ OBSOLETE	25.91 [1.020]	46.51 [1.831]	2-66730-1
△ OBSOLETE	21.11 [.831]	41.71 [1.642]	1-66730-9
△ OBSOLETE	15.80 [.622]	36.40 [1.433]	1-66730-7
	25.91 [1.020]	46.51 [1.831]	66730-9
	21.11 [.831]	41.71 [1.642]	66730-6
	15.80 [.622]	36.40 [1.433]	66730-3

THIS DRAWING IS A CONTROLLED DOCUMENT. DIM 07/09/92  
 I. SHIP 7-10-92  
 C. STONE  
 R. STONE  
 P. STONE  
 NAME  
 PRODUCT SPEC  
 APPLICATION SPEC  
 WEIGHT  
 MATERIAL △  
 FINISH △

TE Connectivity  
 CONTACT, PIN, TYPE VI, POSTED  
 SIZE CASE CODE DRAWING NO  
 A2 00779 C=66730  
 RESTRICTED TO  
 CUSTOMER DRAWING SCALE 10:1 SHEET 1 of 1 REV G2