

4

3

2

1

THIS DRAWING IS UNPUBLISHED.
 © COPYRIGHT 19 BY AMP INCORPORATED. ALL RIGHTS RESERVED.

LOC		DIST		REVISIONS			
FT	47	F	LWR	DESCRIPTION	DATE	OWN	APPD
		0		RLSE PER NPR 19	21 NOV 96	-	-
		A		ADDED -2 PER EC 0320-132-97	25 APR 97	CO	GS
		B		ADDED -3 PER EC 0320-201-97	26 JUN 97	MB	GS

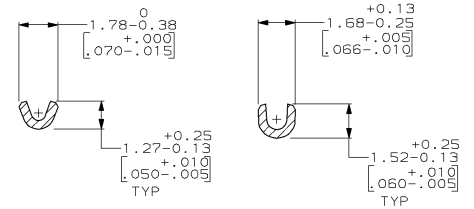
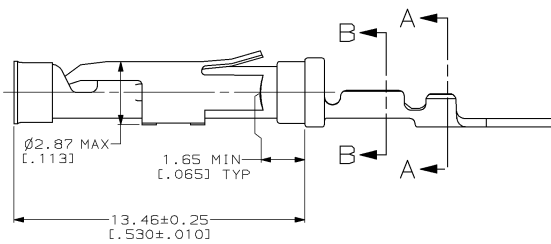
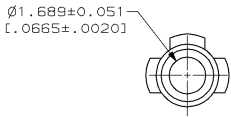
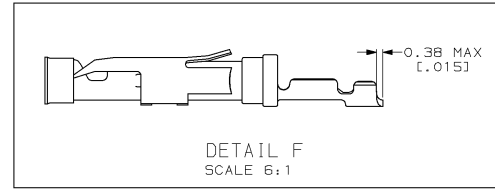
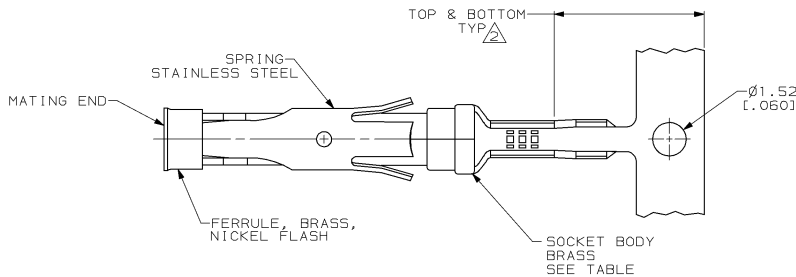

SECTION B-B SECTION A-A

- 1. 0.76µm [L.000030] MIN GOLD PER MIL-G-45204 ON MATING END FOR A LENGTH OF 5.08 [L.200] MIN WITH GOLD FLASH ON THE REMAINDER OVER 0.76µm [L.000030] MIN NICKEL PER QQ-N-290.
- 2. GOLD PLATING NEED NOT APPEAR IN THIS AREA .
- 3. REELED FOR MINI-APPLICATOR.
- 4. WIRE RANGE 28-30 AWG. INSULATION RANGE 3.81[L.015]-7.62[L.030] DIA.
- 5. 0.38µm [L.000015] MIN GOLD PER MIL-G-45204 ON MATING END FOR A LENGTH OF 5.08 [L.200] MIN WITH GOLD FLASH ON THE REMAINDER OVER 0.76µm [L.000030] MIN NICKEL PER QQ-N-290.

PER DETAIL F	△	788088-3
-	△	788088-2
-	△	788088-1
LOOSE PIECE	FINISH SOCKET BODY	PART NUMBER

THIS DRAWING IS A CONTROLLED DOCUMENT.

DWG	C. OBERMAN	21 NOV 96
CHK	R. STONE	22 NOV 96
APPD	B. STEINHAUER	22 NOV 96
PRODUCT SPEC	108-10042	
APPLICATION SPEC	114-10004	
WEIGHT	-	

AMP Incorporated
Harrisburg, PA 17105-3608

AMP

SOCKET ASSEMBLY,
.062, TYPE III+

SIZE: A2 CASE CODE: 00779 DRAWING NO: 788088

CUSTOMER DRAWING SCALE: 8:1 SHEET 1 OF 1 REV B

788088
B