

DO NOT SCALE  
DIMENSIONS IN mm

METRIC

THIRD ANGLE PROJECTION

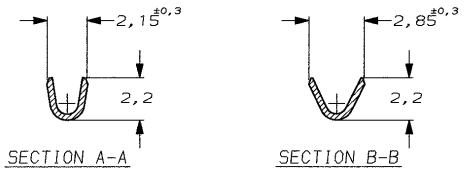
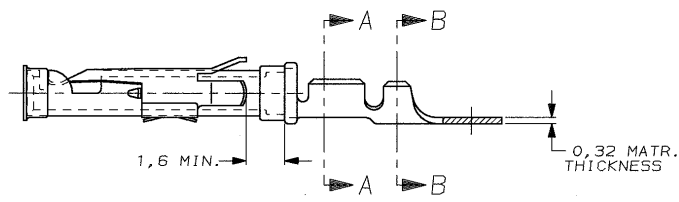
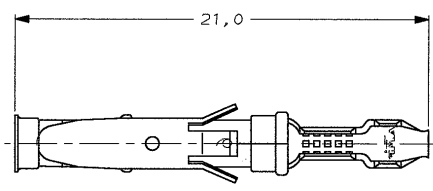
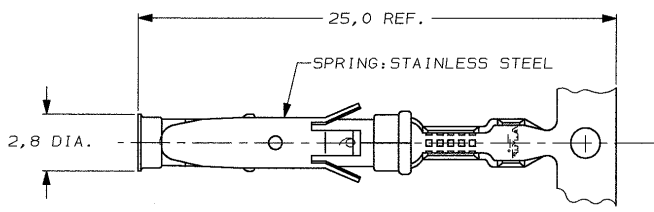

WIRE RANGE : 0,20-0,50 mm<sup>2</sup> (24-20 AWG)  
INSUL. RANGE : 1,1 -1,8 mm (.045-.070)

- NOTES :**
- 1 U.L. RECONIZED UNDER FILE E28476 VOL.VI SEC.I
  - 2 FOR CRIMPDETAILS SEE AMP-SPEC. 114-19.000 .
  - 3 MEETS PRODUCTSPECIFICATION 108-10042.
  - 4 SPECIAL REEL WITH 200 PCS FOR REEL-FED HAND-TOOL
  - 5 **OBSOLETE PARTS: OBSOLETE CIS STREAMLINING PER D.RENAUD/D.SINISI**
  - 6 **OBSOLETE**

NOTES	MATERIAL	THICKNESS	AREA
1	TIN	2,0 μm	ALL OVER
2	NICKEL GOLD TINV/LEAD	0,8 μm	ALL OVER CONTACT AREA BARREL
3	NICKEL GOLD	0,8 μm	ALL OVER CONTACT AREA ALL OVER
4	NICKEL SILVER TINV/LEAD	1,2 μm	ALL OVER CONTACT AREA BARREL
5	NICKEL SILVER TINV/LEAD	2,5 μm	ALL OVER CONTACT AREA BARREL
6	SILVER	1,5-2,5 μm	ALL OVER
7	SILVER	0,76 μm	ALL OVER
8	SILVER	2,5 μm	ALL OVER
9	NICKEL BRIGHT TIN/LEAD	1,27 μm	ALL OVER
10	LUBRICATED		

PARTNUMBER	DIRECTION OF REEL	LOOSE-PIECE	MATERIAL	PLATING
1-163087-5	▲	▲	1-163088-4	BRASS SILVER
1-163087-4	▲	▲	1-163088-4	BRASS EL. TIN
1-163087-3	▲	▲	1-163088-3	BRASS BR. TIN/LEAD
5-163087-3	▲	▲		BRASS ECON. GOLD
5-163087-2	▲	▲		BRASS SEL. GOLD
5-163087-1	▲	▲		BRASS EL. TIN
1-163087-2	▲	▲	1-163088-1	BRASS GOLD
1-163087-1	▲	▲		BRASS ECON. GOLD
1-163087-0	▲	▲	1-163088-0	BRASS ECON. GOLD
163087-9	▲	▲		BRASS EL. TIN
163087-8	▲	▲		BRASS SEL. GOLD
163087-2	▲	▲	163088-2	BRASS SEL. GOLD
163087-1	▲	▲	163088-1	BRASS EL. TIN

DIRECTION OFF TOP OF REEL  
AMPOMATOR + MINI-APPL.  
107-3-F16.1

107-3-F16.2

107-3-F16.4

**CUSTOMER DRAWING** FOR REFERENCE ONLY WILL NOT BE UPDATED

© COPYRIGHT 19- BY AMP HOLLAND B.V.  
ALL INTERNATIONAL RIGHTS RESERVED. AMP PRODUCTS MAY BE COVERED BY U.S. AND FOREIGN AND/OR PATENTS PENDING.  
THIS DRAWING IS UNPUBLISHED  
RELEASED FOR PUBLICATION

**AMP** | AMP HOLLAND B.V.  
s-Hertogenbosch, The Netherlands.

NAME: **SOCKET TYPE III CONTACT**  
SIZE 16

DRG. No. 163087

REV. LTR. AD1

SHEET 1 OF 1

A3