

REV	DATE	DESCRIPTION	BY	CHK	APP
00					
D1	REV PER	DK40-0406-03		TRAMPAS	AH JT

- △ NICKEL UNDER PLATE, GOLD PLATED CONTACT AREA WITH TIN PLATING IN WIRE BARREL.
- 2. REELING DIRECTION FOR 776235-1 IS PER AMP 107-3, FIG.2
- 3. REELING DIRECTION FOR 776235-4 IS PER AMP 107-3, FIG.4

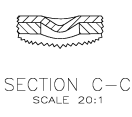
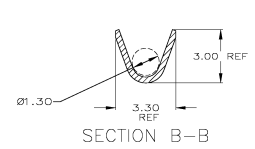
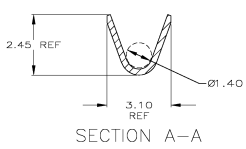
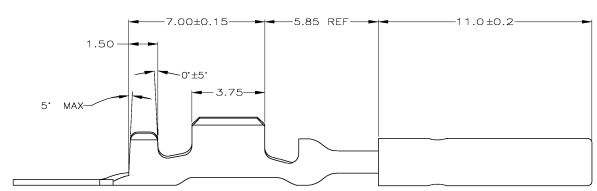
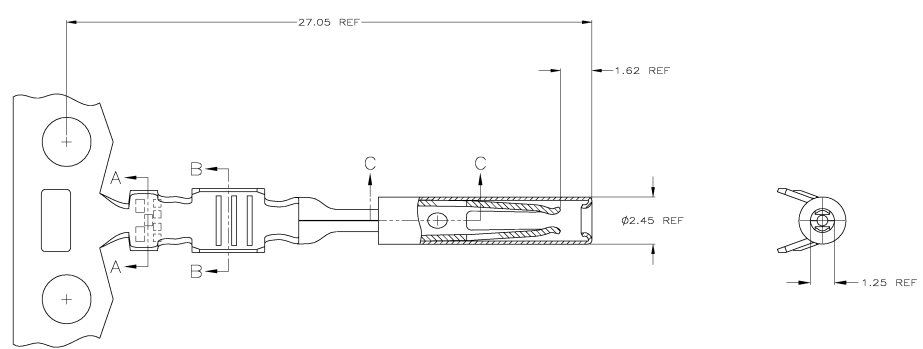

567680	776235-4
	776235-1
	PART NUMBER

THIS DRAWING IS A CONTROLLED DOCUMENT		DATE: 11-20-88	BY: J. COLLINS	REV: 1	APP: [Signature]
DRAWN BY: [Signature]		DATE: 11-20-88	BY: J. COLLINS	REV: 1	APP: [Signature]
CHECKED BY: [Signature]		DATE: 11-20-88	BY: J. COLLINS	REV: 1	APP: [Signature]
APPROVED BY: [Signature]		DATE: 11-20-88	BY: J. COLLINS	REV: 1	APP: [Signature]
MATERIAL: SLEEVE: CU CONTACT: CU ALLOY		DATE: 11-20-88	BY: J. COLLINS	REV: 1	APP: [Signature]
CUSTOMER DRAWING		DATE: 11-20-88	BY: J. COLLINS	REV: 1	APP: [Signature]