

DO NOT SCALE
DIMENSIONS IN mm

METRIC

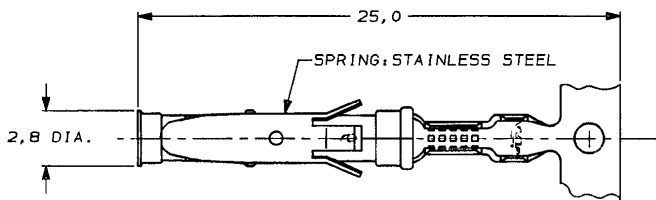

STRIP

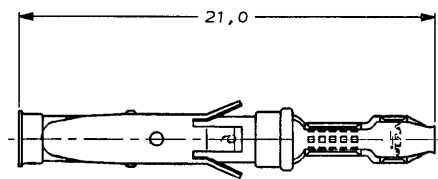

LOOSE-PIECE

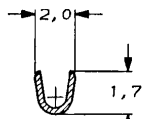
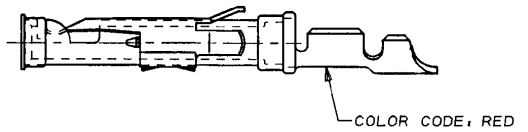
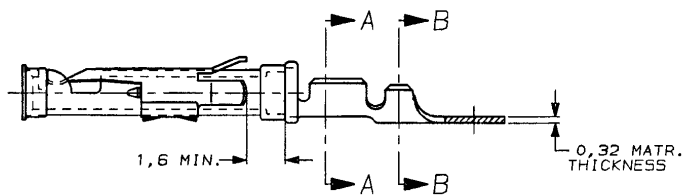

SECTION A-A

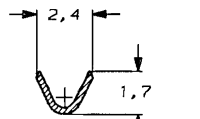

SECTION B-B

WIRE RANGE : 0,12-0,20 mm² (26-24 AWG)
INSUL. RANGE : 0,9 -1,4 mm (.035-.055)

DO NOT SCALE
09 002 1004

DIRECTION OFF TOP OF REEL	1-163091-3	1-163092-3	BRASS	EL. TIN
AMPOMATOR + MINJ-APPL. 107-3-F10.1	1-163091-2	1-163092-2	BRASS	BR. TIN/LEAD
	1-163091-1		BRASS	ECON. GOLD
	1-163091-0	1-163092-0	BRASS	ECON. GOLD
107-3-F10.2	163091-9		BRASS	EL. TIN
	163091-8		BRASS	SEL. GOLD
	163091-2	163092-2	BRASS	SEL. GOLD
TERMINAL "U" UP.	163091-1	163092-1	BRASS	EL. TIN

- NOTES :
- U.L. RECONIZED UNDER FILE E28476 VOL. VI SEC. I .
 - FOR CRIMPDETAILS SEE AMP-SPEC. 114-19.000 .
 - MEETS PRODUCTSPECIFICATION 108-10042.
- OBSELETE PARTS: OBSELETE CIS STREAMLINING PER D.RENAUD/D.SINISI
- OBSELETE

NOTES	MATERIAL	THICKNESS	AREA
△	TIN	2,0 μm	ALL OVER
△	NICKEL		ALL OVER
△	GOLD	0,8 μm	CONTACT AREA
△	TIN/LEAD		BARREL
△	NICKEL		ALL OVER
△	GOLD	0,8 μm	CONTACT AREA
△	NICKEL		ALL OVER
△	GOLD	1,2 μm	CONTACT AREA
△	NICKEL		ALL OVER
△	SILVER	2,5 μm	CONTACT AREA
△	TIN/LEAD		BARREL
△	SILVER	0,5 μm	ALL OVER
△	SILVER	2,5 μm	ALL OVER
△	NICKEL	1,2 μm	ALL OVER
△	TIN/LEAD	1,2 μm	ALL OVER
△	LUBRICATED		

REVISION	REVISION RECORD	DATE	BY	CHK.	DATE
Y1	REVISIED PER - ECO-10-000030	05JAN10	KK	AEG	
Y	EBD0-0335-04	02/08/04	JMS	FWK	
M	EH-0302-94	03-05-94	JvL	MvD	
L	ECN H-9813	18-05-92	JvdH	RD	

CUSTOMER DRAWING FOR REFERENCE ONLY WILL NOT BE UPDATED

© COPYRIGHT 19... BY AMP HOLLAND B.V. ALL INTERNATIONAL RIGHTS RESERVED. AMP PRODUCTS MAY BE COVERED BY U.S. AND FOREIGN AND/OR PATENTS PENDING. THIS DRAWING IS UNPUBLISHED AND IS RELEASED FOR PUBLICATION.

AMP AMP HOLLAND B.V. 's-Hertogenbosch, The Netherlands.

NAME: SOCKET TYPE III CONTACT SIZE 16.

DWG. No. C-163091 REV. LTR. Y1 SHEET 1 OF 1

8 7 6 5 4 3 2 1