

THIS DRAWING IS UNPUBLISHED. RELEASED FOR PUBLICATION .19
 © COPYRIGHT 19 BY AMP INCORPORATED. ALL INTERNATIONAL RIGHTS RESERVED.

REVISIONS									
MOD	LOC	DIST	P	F	ZONE	LTR	DESCRIPTION	DATE	APPD
4	BD	39				T	ADDED -9 PER NPR 4680 AND REDRAWN ON CAD	04/07/93	-
						T1	REVISED PER ECO-09-020935	08SEP09	KK AEG

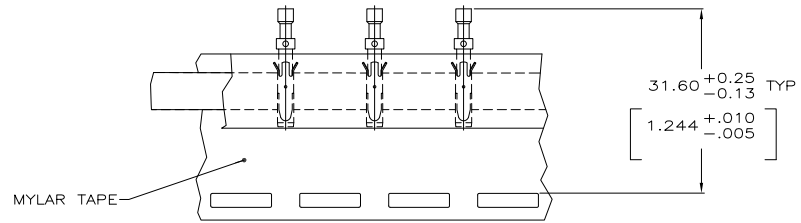
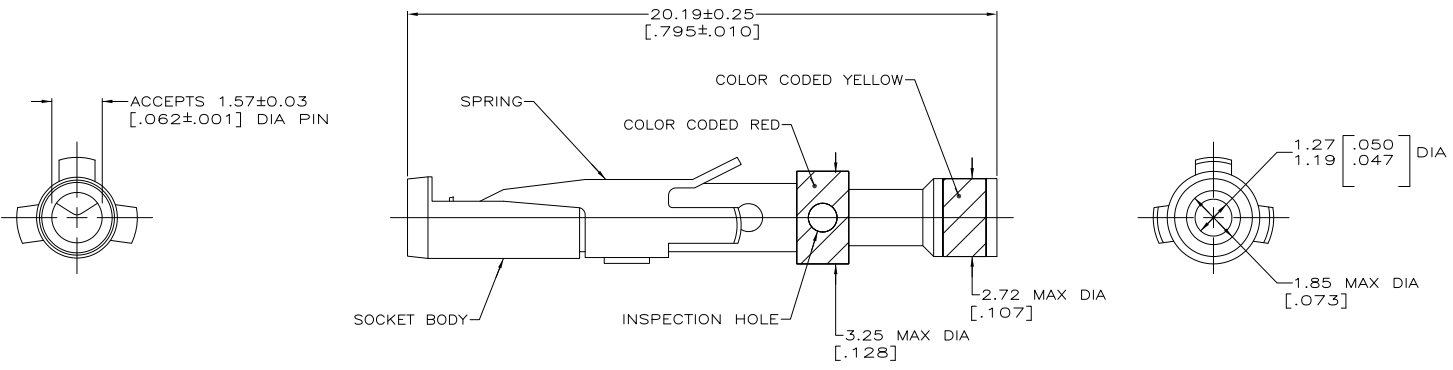

TAPE MTG DETAIL
SCALE 2:1

- ⚠ 0.76μm [.000030] MIN GOLD OVER 1.27μm [.000050] MIN NICKEL.
- ⚠ 2.54μm [.000100] MIN GOLD OVER 1.27μm [.000050] MIN NICKEL.
- ⚠ WHEN ORDERING CONTACT ASSEMBLY ON TAPE, ORDER BY THE TAPE NUMBER PLUS THE PACKAGING CODE AS FOLLOWS:
 1. FOR USE WITH AMP TAPETRONIC, PNEUMATIC TOOL-
 - A. 1000 PARTS TO A BOX ADD PACKAGING CODE: 1MBOX
 2. FOR USE WITH 4/8 INDENT STRIPPER CRIMPER-
 - A. 1000 PARTS TO A REEL ADD PACKAGING CODE: 1MREEL
 - B. 5000 PARTS TO A REEL ADD PACKAGING CODE: 5MREEL
- ⚠ OBSOLETE PARTS: OBSOLETE CIS STREAMLINING PER D.RENAUD/D.SINISI

OBSOLETE	SMALL PACK	⚠	-201580-9
	TAPE MTG (SEE DETAIL)	⚠	-201580-7
	TAPE MTG (SEE DETAIL)	⚠	-201580-4
	STANDARD	⚠	201580-3
	STANDARD	⚠	201580-1

PACKAGING TYPE		SOCKET BODY FINISH		PART NO	
DO NOT SCALE PRINT. UNLESS SPECIFIED DIMENSIONS IN mm [INCHES] TOLERANCES ON : 2 PLC DEC ± - 3 PLC DEC ± - ANGLES ± -	DR 04/07/93 D.GELTZ	AMP Incorporated Harrisburg, PA 17105-3608		CONTACT ASSEMBLY, SOCKET, #16, 20-24 AWC, TYPE II	
MATERIAL SOCKET BODY: COPPER ALLOY SPRING: STAINLESS STEEL	CHK 4-26-93 R.STONE				
FINISH SOCKET BODY: SEE TABLE	APPD 4-29-93 R.S.KLINE				
APPLICATION SPEC	PRODUCT SPEC	NAME	SIZE	CAGE CODE	DRAWING NO
			Ⓢ	00779	Ⓒ-201580
WEIGHT		SCALE	10:1		SHEET 1 OF 1

THIS DRAWING IS A CONTROLLED DOCUMENT FOR AMP INCORPORATED. IT IS SUBJECT TO CHANGE AND THE CONTROLLING ENGINEERING ORGANIZATION SHOULD BE CONTACTED FOR THE LATEST REVISION.