

4

3

2

1

193844

THIS DRAWING IS UNPUBLISHED. RELEASED FOR PUBLICATION .19
 © COPYRIGHT 19 BY AMP INCORPORATED. ALL RIGHTS RESERVED.

| LOC | | DIST | | REVISIONS | | | |
|-----|-----|-------------|-----------------------------------|-----------|------|-----|--|
| P | LTR | DESCRIPTION | DATE | DWN | APVD | | |
| | | D | ADDED -2 | 21/NOV/95 | RNP | PG | |
| | | E | MATERIAL Δ FINISH Δ | 25/JUL/96 | RNP | PRG | |
| | | F | EC 0B20-0724-97 | 10/JUN/97 | RNP | RAR | |
| | | G | EC 0B20-0852-98 | 09/JUL/98 | RNP | RAR | |

- Δ 1 MATERIAL: COPPER ALLOY
- Δ 2 FINISH: 200 μ INCH MIN SILVER OVER 50 μ INCH MIN. NICKEL
- Δ 3 WIRE BARREL WILL ACCEPT #14AWG WIRE
- Δ 4 WHEN ORDERING CONTACT ASSEMBLIES ON TAPE, ORDER BY PART NUMBER PLUS THE PACKAGING CODE AS FOLLOWS:
 A. 5000 PARTS PER REEL ADD PACKAGING CODE: 5MREEL
 I.E. ORDER # 193844-2, 5MREEL

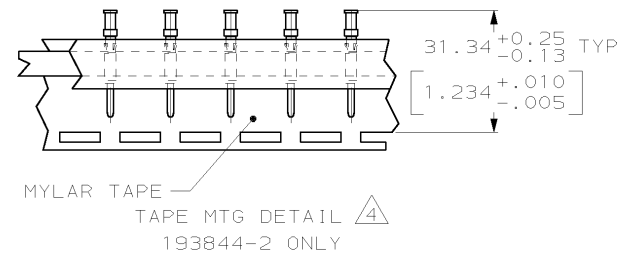
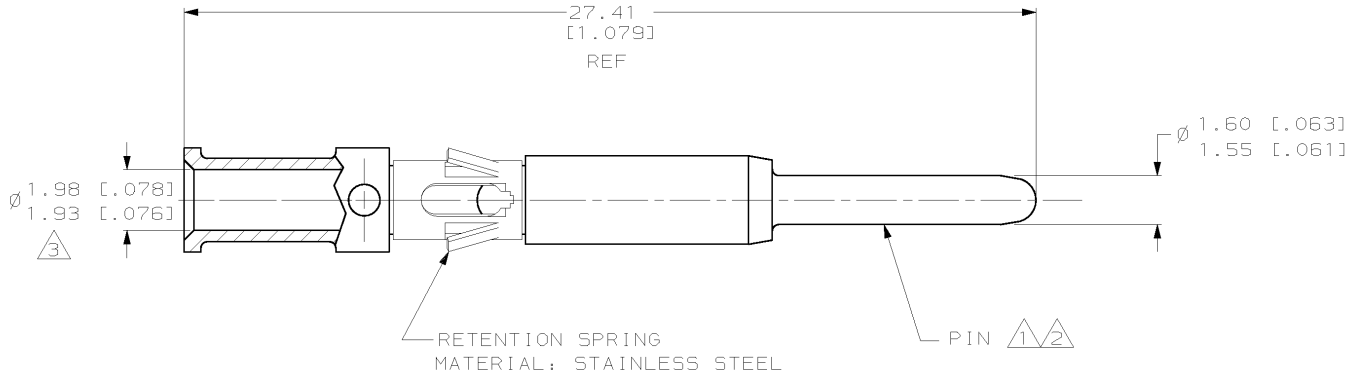

| | |
|--------------------------------|----------|
| Δ TAPE MTG (SEE DETAIL) | 193844-2 |
| STANDARD | 193844-1 |
| PACKAGING TYPE | PART NO |

| | | | | |
|---|--|--------------------------------------|--|---|
| THIS DRAWING IS A CONTROLLED DOCUMENT FOR AMP INCORPORATED. IT IS SUBJECT TO CHANGE AND THE CONTROLLING ENGINEERING ORGANIZATION SHOULD BE CONTACTED FOR THE LATEST REVISION. | | OWN CRAIG M. SVOBODA 16/MAY/94 | 14/OCT/94 | AMP Incorporated Harrisburg, PA 17105-3608 |
| DIMENSIONS: mm [in] | | APVD 16/MAY/94 | NAME | |
| TOLERANCES UNLESS OTHERWISE SPECIFIED: 0 PLC ±- 1 PLC ±.3 [.01] 2 PLC ±.13 [.005] 3 PLC ±- 4 PLC ±- ANGLES ±- FINISH | | PRODUCT SPEC - | PIN, ϕ .062, #14 AWG HIGH CURRENT TYPE II/III+ | |
| MATERIAL Δ 1 | | APPLICATION SPEC - | SIZE A3 | CAGE CODE 00779 |
| | | WEIGHT - | DRAWING NO C-193844 | |
| | | CUSTOMER DRAWING | | SCALE 1 1 |
| | | | | REV G |

AMP1470-19 REV 10/93

09-JUL-98 12:36:44 omp25479ws/spc/pending