

DO NOT SCALE
DIMENSIONS IN mm

METRIC

THIRD ANGLE PROJECTION

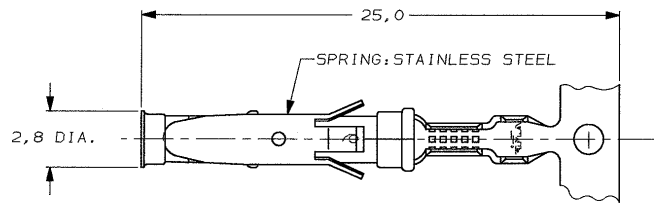

STRIP

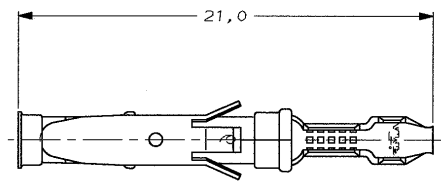

LOOSE-PIECE

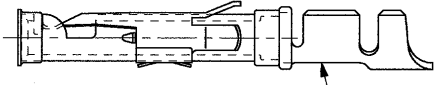
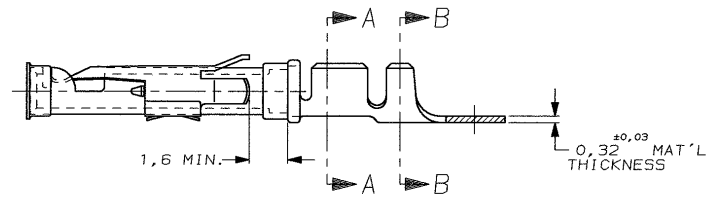

COLOR CODE: BLUE

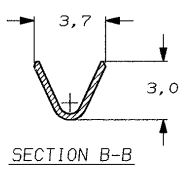
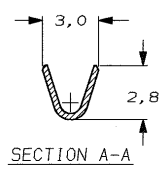

WIRE RANGE : 0,75-1,50 mm² (18-16 AWG)
INSUL. RANGE : 2,0 -2,5 mm (.080-.100)

- NOTES :
- U.L. RECOGNIZED UNDER FILE E28476 VOL. VI SEC. I .
 - FOR CRIMP DETAILS SEE AMP-SPEC. 114-19.000 .
 - MEETS PRODUCTS SPECIFICATION 108-10042.
 - SPECIAL REEL WITH 200 PCS FOR REEL-FED HANDTOOL.
 - OBsolete PARTS: OBSOLETE CIS STREAMLINING PER D.RENAUD/D.SINISI

OBsolete	PARTNUMBER	DIRECTION OF REEL	LOOSE-PIECE	MATERIAL	PLATING
△	5-163083-3	△		BRASS	ECON. GOLD
△	5-163083-2	△		BRASS	SEL. GOLD
△	5-163083-1	△		BRASS	EL. TIN
△	1-163083-4	△	1-163084-4	BRASS	EL. TIN
△	1-163083-2	△	1-163084-3	BRASS	BR. TIN/LEAD
△	1-163083-1	△		BRASS	SILVER
△	1-163083-0	△	1-163084-0	BRASS	ECON. GOLD
△	163083-9	△		BRASS	SILVER
△	163083-8	△		BRASS	EL. TIN
△	163083-7	△		BRASS	SEL. GOLD
△	163083-2	△	163084-2	BRASS	SEL. GOLD
△	163083-1	△	163084-1	BRASS	EL. TIN

DIRECTION OFF TOP OF REEL
AMPOMATOR + MINI-APPL.
107-3-F16.1
107-3-F16.2
107-3-F16.4

NOTES	MATERIAL	THICKNESS	AREA
△	TIN	2,0 μm	ALL OVER
△	NICKEL		ALL OVER
△	GOLD	0,8 μm	CONTACT AREA
△	TIN/LEAD		BARREL
△	NICKEL	0,8 μm	ALL OVER
△	GOLD		CONTACT AREA
△	NICKEL	1,2 μm	ALL OVER
△	GOLD		CONTACT AREA
△	NICKEL	2,5 μm	ALL OVER
△	SILVER		CONTACT AREA
△	TIN/LEAD		BARREL
△	SILVER	1,5-2,5 μm	ALL OVER
△	NICKEL	0,75 μm	ALL OVER
△	SILVER	2,5 μm	ALL OVER
△	NICKEL	1,27 μm	ALL OVER
△	TIN/LEAD	1,27 μm	ALL OVER
△	LUBRICATED		

REV.	DESCRIPTION	BY	DATE
AZ1	ECO-10-000445	KK HMR	19JAN10
AZ	EBD0-0003-05	AM FWK	05/01/05
AY	EBD0-0335-04	JMS FWK	02/08/04
V	EH-1020-98	D.K. R.V.	08 JUL 98
U	EH-1347-96	JvL RV	21-11-96
T	EH-0302-94	JvL MvD	03-05-94
S	ECN H-9813	JvdH RD	18-05-92

CUSTOMER DRAWING FOR REFERENCE ONLY WILL NOT BE UPDATED.

© COPYRIGHT 19- BY AMP HOLLAND B.V.
ALL INTERNATIONAL RIGHTS RESERVED. AMP PRODUCTS MAY BE COVERED BY U.S. AND FOREIGN AND/OR PATENTS PENDING.

THIS DRAWING IS UNPUBLISHED
RELEASED FOR PUBLICATION

AMP AMP HOLLAND B.V.
s-Hertogenbosch, The Netherlands.

NAME: SOCKET TYPE III CONTACT
SIZE 16

DR.:	CHK.:	APP.:	DWG. No.	REV. LTR.	SHEET
DATE:	DATE:	DATE:	163083	AZ1	1 of 1

8 7 6 5 4 3 2 1

R6-126 (REV.04-91)