

4

3

2

1

THIS DRAWING IS UNPUBLISHED. RELEASED FOR PUBLICATION. ALL RIGHTS RESERVED.

LOC		DIST		REVISIONS			
FT	47	P	LTR	DESCRIPTION	DATE	MIN	APD
		M2		REVISED PER ECO-11-004917	11MAR11	RK	HMR

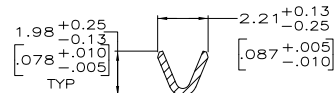
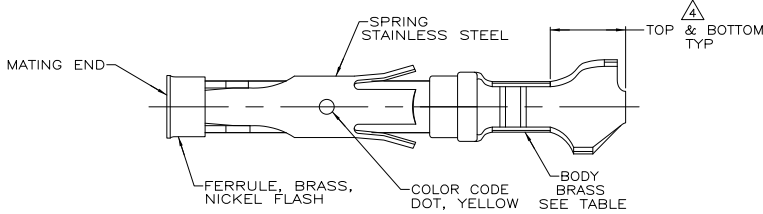

SECTION A-A

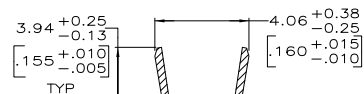

SECTION B-B

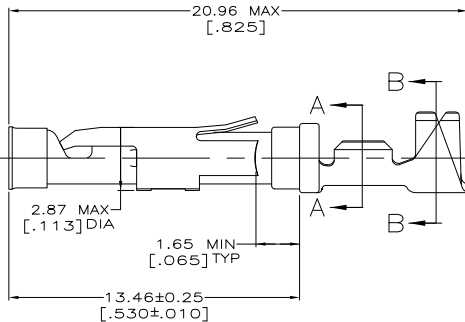
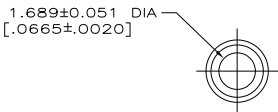

- ⚠ 0.76µm [.000030] MIN GOLD PER MIL-G-45204 ON MATING END FOR A LENGTH OF 5.08 [.200] MIN WITH GOLD FLASH ON THE REMAINDER OVER 0.76µm [.000030] MIN NICKEL PER QQ-N-290.
- ⚠ 0.76µm [.000030] MIN GOLD PER MIL-G-45204 ON MATING END FOR A LENGTH OF 5.08 [.200] MIN WITH A UNIFORM GRADIENT TO 0.25µm [.000010] MIN GOLD PER MIL-G-45204 ON THE REMAINDER OVER 0.76µm [.000030] MIN NICKEL PER QQ-N-290.
- ⚠ 0.38µm [.000015] MIN GOLD PER MIL-G-45204 ON MATING END FOR A LENGTH OF 5.08 [.200] MIN WITH GOLD FLASH ON THE REMAINDER OVER 0.76µm [.000030] MIN NICKEL PER QQ-N-290.
- ⚠ GOLD PLATING NEED NOT APPEAR IN THIS AREA.
- ⚠ 1.27µm [.000050] MIN TIN-LEAD PER MIL-T-10727 OVER 0.76µm [.000030] MIN NICKEL PER QQ-N-290.
- 6. WIRE RANGE 24-20 AWG.
INSULATION RANGE 1.52 [.060]-3.05 [.120].
- ⚠ 0.38µm [.000015] MIN GOLD PER MIL-G-45204 ON MATING END FOR A LENGTH OF 5.08 [.200] MIN, 1.27µm [.000050] MIN TIN-LEAD PER MIL-T-10727 FOR A LENGTH OF 5.69 [.224] MIN ON OPPOSITE END, BOTH OVER 1.27µm [.000050] MIN NICKEL PER QQ-N-290 ON ENTIRE CONTACT.
- ⚠ 1.27µm [.000050] MIN TIN PER MIL-T-10727 OVER 0.76µm [.000030] MIN NICKEL PER QQ-N-290.
- ⚠ OBSOLETE PARTS: OBSOLETE CIS STREAMLINING PER D.RENAUD/D.SINISI

	STANDARD		1-66563-1	66565-7
9	OBSOLETE	SMALL PACK	66563-4	66565-6
	OBSOLETE	STANDARD	1-66563-0	66565-5
		STANDARD	66563-4	66565-4
	OBSOLETE	STANDARD	66563-7	66565-3
		STANDARD	66563-6	66565-2
		STANDARD	66563-1	66565-1
		PACKAGING TYPE	STRIP P/N REF	PART NO

THIS DRAWING IS A CONTROLLED DOCUMENT.

DESIGNED BY: R. SHIBEY	DATE: 7-31-91	TE Connectivity
CHECKED BY: S. STONE	DATE: 9-19-91	
APPROVED BY: J. WESTMAN	DATE: 9-20-91	SOCKET ASSEMBLY, LOOSE PIECE, TYPE III+
PRODUCT SPEC: APPLICATION SPEC: -	SIZE: A2	CAGE CODE: 00779
MATERIAL: SEE CALLOUTS	FINISH: SEE CALLOUTS	DRAWING NO: C-66565
		RESTRICTED TO: -
		CUSTOMER DRAWING

SCALE: 8:1 SHEET 1 of 1 REV M2

66565

A