

4

3

2

1

THIS DRAWING IS UNPUBLISHED. RELEASED FOR PUBLICATION. ALL RIGHTS RESERVED.

LOC	DIST	REVISIONS		
FT	0	P	LTR	DATE
		H1	REVISED PER ECO-11-004587	11MAR11
				RK HMR

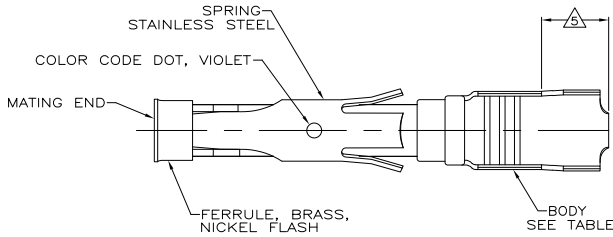

1.689±0.051 DIA
[.0665±.0020]

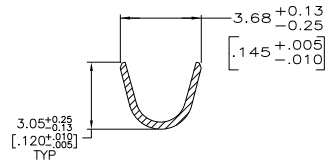
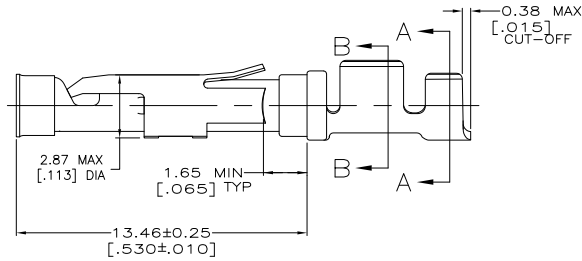
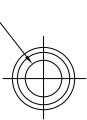

SECTION A-A

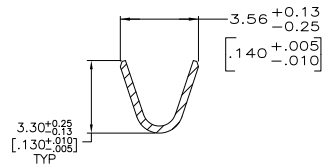

SECTION B-B

- ▲ 0.76µm [.000030] MIN GOLD PER MIL-G-45204 ON MATING END FOR A LENGTH OF 5.08 [.200] MIN WITH GOLD FLASH ON THE REMAINDER OVER 0.76µm [.000030] MIN NICKEL PER QQ-N-290.
- ▲ 1.27µm [.000050] MIN TIN-LEAD PER MIL-T-10727 OVER 0.76µm [.000030] MIN NICKEL PER QQ-N-290.
- ▲ 0.76µm [.000030] MIN GOLD PER MIL-G-45204 ON MATING END FOR A LENGTH OF 5.08 [.200] MIN WITH A UNIFORM GRADIENT TO 0.25µm [.000010] MIN GOLD PER MIL-G-45204 ON THE REMAINDER OVER 0.76µm [.000030] MIN NICKEL PER QQ-N-290.
- ▲ 0.38µm [.000015] MIN GOLD PER MIL-G-45204 ON MATING END FOR A LENGTH OF 5.08 [.200] MIN WITH GOLD FLASH ON THE REMAINDER OVER 0.76µm [.000030] MIN NICKEL PER QQ-N-290.
- ▲ GOLD PLATING NOT REQUIRED IN THIS AREA.
- ▲ WIRE RANGE 18-14 AWG.
- ▲ INSULATION RANGE 2.03 [.080]-2.54 [.100].
- ▲ 0.38µm [.000015] MIN GOLD PER MIL-G-45204 ON MATING END FOR A LENGTH OF 5.08 [.200] MIN, 1.27µm [.000050] MIN TIN-LEAD PER MIL-T-10727 FOR A LENGTH OF 5.69 [.224] MIN ON OPPOSITE END, BOTH OVER 1.27µm [.000050] MIN NICKEL PER QQ-N-290 ON ENTIRE CONTACT.
- ▲ 1.27µm [.000050] MIN TIN PER MIL-T-10727 OVER 0.76µm [.000030] MIN NICKEL PER QQ-N-290.

STANDARD	▲	CU-NI ALLOY	2-66358-1	1-66360-6
STANDARD	▲	CU-NI ALLOY	2-66358-0	1-66360-5
STANDARD	▲	CU-NI ALLOY	1-66358-9	1-66360-4
SMALL PACK	▲	BRASS	1-66358-6	1-66360-3
STANDARD	▲	BRASS	1-66358-6	1-66360-2
SMALL PACK	▲	BRASS	66358-4	1-66360-1
SMALL PACK	▲	BRASS	66358-2	1-66360-0
OBSOLETE	▲	BRASS	1-66358-5	66360-9
OBSOLETE	▲	PHOSPHOR BRONZE	1-66358-3	66360-8
OBSOLETE	▲	PHOSPHOR BRONZE	1-66358-2	66360-7
STANDARD	▲	BRASS	66358-4	66360-4
STANDARD	▲	BRASS	66358-3	66360-3
STANDARD	▲	BRASS	66358-2	66360-2
STANDARD	▲	BRASS	66358-1	66360-1
PACKAGING		BODY MATERIAL	STRIP P/N REF	PART NUMBER

THIS DRAWING IS A CONTROLLED DOCUMENT. DATE: 06/03/92

DESIGNER: W. LENKER DATE: 6-11-92

APP'D: G. STEINHAUER DATE: 7-8-92

PRODUCT SPEC: -

APPLICATION SPEC: -

SIZE: A2 CASE CODE: C-66360 DRAWING NO: 00779

WEIGHT: -

MATERIAL: SEE CALLOUTS FINISH: SEE TABLE

CUSTOMER DRAWING

SCALE: 8:1 SHEET: 1 of 1 REV: H1

TE Connectivity SOCKET ASSEMBLY, LOOSE PIECE, TYPE III+