

4

3

2

1

THIS DRAWING IS UNPUBLISHED. RELEASED FOR PUBLICATION. ALL RIGHTS RESERVED.

LOC	DIST	REVISIONS			
P	LTR	DESCRIPTION	DATE	MIN	APD
FT	47				
	H2	REVISED PER ECO-11-004587	11MAR11	RK	HMR

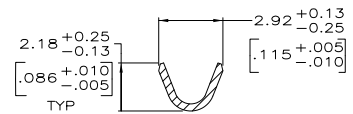
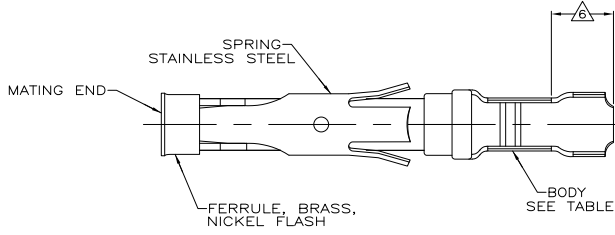

SECTION A-A

1.689±0.051 DIA
[.0665±.0020]

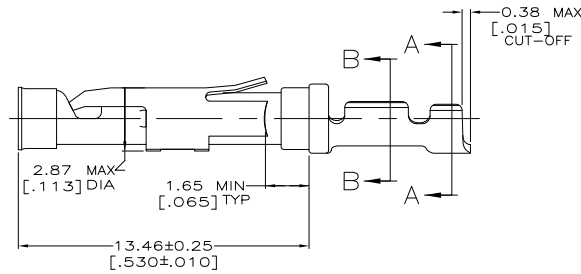
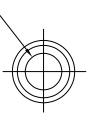

SECTION B-B

- ⚠ 0.76µm [.000030] MIN GOLD PER MIL-G-45204 ON MATING END FOR A LENGTH OF 5.08 [.200] MIN WITH GOLD FLASH ON THE REMAINDER OVER 0.76µm [.000030] MIN NICKEL PER QQ-N-290.
- ⚠ 1.27µm [.000050] MIN TIN-LEAD PER MIL-T-10727 OVER 0.76µm [.000030] MIN NICKEL PER QQ-N-290.
- ⚠ 0.76µm [.000030] MIN GOLD PER MIL-G-45204 ON MATING END FOR A LENGTH OF 5.08 [.200] MIN WITH A UNIFORM GRADIENT TO 0.25µm [.000010] MIN GOLD PER MIL-G-45204 ON THE REMAINDER OVER 0.76µm [.000030] NICKEL PER QQ-N-290.
- ⚠ 0.38µm [.000015] MIN GOLD PER MIL-G-45204 ON MATING END FOR A LENGTH OF 5.08 [.200] MIN WITH GOLD FLASH ON THE REMAINDER OVER 0.76µm [.000030] MIN NICKEL PER QQ-N-290.
- ⚠ 1.27µm [.000050] MIN GOLD PER MIL-G-45204 ON MATING END FOR A LENGTH OF 5.08 [.200] MIN WITH GOLD FLASH ON REMAINDER OVER 1.90µm [.000075] MIN NICKEL PER QQ-N-290.
- ⚠ GOLD PLATING NOT REQUIRED IN THIS AREA.
- 7. WIRE RANGE 24-20 AWG. INSULATION RANGE 1.02[.040]-2.03[.080].
- ⚠ 0.38µm [.000015] MIN GOLD PER MIL-G-45204 ON MATING END FOR A LENGTH OF 5.08 [.200] MIN, 1.27µm [.000050] MIN TIN-LEAD PER MIL-T-10727 FOR A LENGTH OF 5.69 [.224] MIN ON OPPOSITE END, BOTH OVER 1.27µm [.000050] MIN NICKEL PER QQ-N-290 ON ENTIRE CONTACT.
- ⚠ 1.27µm [.000050] MIN TIN PER MIL-T-10727 OVER 0.76µm [.000030] MIN NICKEL PER QQ-N-290.
- ⚠ OBSOLETE PARTS: OBSOLETE CIS STREAMLINING PER D.RENAUD/D.SINISI

⚠ OBSOLETE

OBSOLETE
OBSOLETE
OBSOLETE
OBSOLETE

PACKAGING TYPE	BODY FINISH	BODY MATERIAL	STRIP P/N	PART NO
SMALL PACK	9	BRASS	1-66105-9	2-66105-0
STANDARD	9	BRASS	3-66104-0	1-66105-9
SMALL PACK	9	BRASS	66104-4	1-66105-8
SMALL PACK	9	BRASS	66104-3	1-66105-7
SMALL PACK	9	BRASS	66104-2	1-66105-6
SMALL PACK	9	BRASS	66104-1	1-66105-5
STANDARD	9	BRASS	2-66104-6	1-66105-4
STANDARD	9	PHOSPHOR BRONZE	2-66104-3	1-66105-3
STANDARD	9	PHOSPHOR BRONZE	2-66104-2	1-66105-2
STANDARD	9	BRASS	1-66104-6	1-66105-0
STANDARD	9	BRASS	66104-4	66105-4
STANDARD	9	BRASS	66104-3	66105-3
STANDARD	9	BRASS	66104-2	66105-2
STANDARD	9	BRASS	66104-1	66105-1

THIS DRAWING IS A CONTROLLED DOCUMENT. DATE: 06/01/92

DESIGNED BY: W. LENKER DATE: 6-11-92

DRAWN BY: G. STEINHAUER DATE: 7-8-92

PRODUCT SPEC: -

APPLICATION SPEC: -

REQUIREMENTS: -

SIZE: A2 CASE CODE: 00779 DRAWING NO: 66105

MATERIAL: SEE CALLOUTS FINISH: SEE CALLOUTS

CUSTOMER DRAWING

SCALE: 8:1 SHEET: 1 of 1 REV: H2

TE Connectivity

SOCKET ASSEMBLY, LOOSE PIECE, TYPE III+