

4

3

2

1

THIS DRAWING IS UNPUBLISHED. RELEASED FOR PUBLICATION
 © COPYRIGHT - BY TYCO ELECTRONICS CORPORATION. ALL RIGHTS RESERVED.

LOC	DIST	REVISIONS			
P	LTR	DESCRIPTION	DATE	DWN	APVD
	D	EC 0G3B-0317-03	24APR03	VF	GS

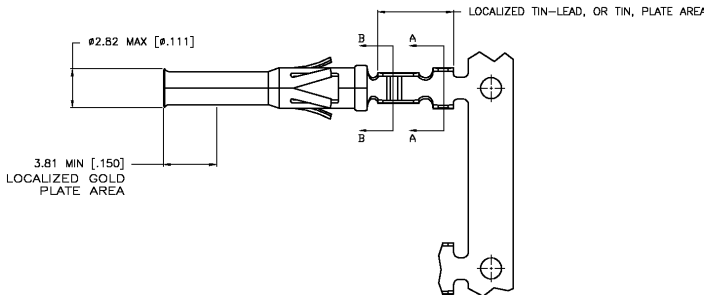
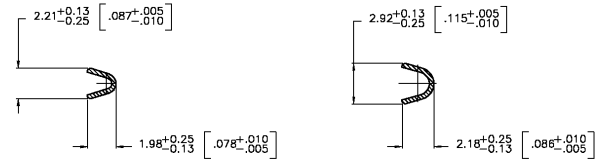
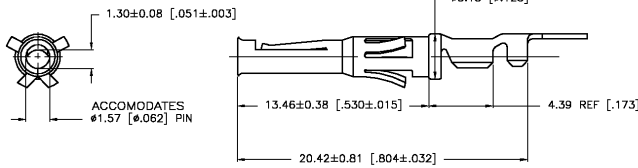
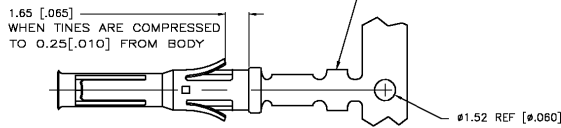

1. WIRE RANGE 24-20 AWG.
 2. INSULATION RANGE 1.02-2.03 [.040-.080] DIA.
 3. FOR LOOSE PIECE PART SEE DWG 66594.
- ▲ 0.76µm [.000030] MIN GOLD IN LOCALIZED GOLD PLATE AREA,
 1.27µm [.000050] MIN TIN-LEAD IN LOCALIZED TIN-LEAD PLATE AREA,
 BOTH OVER 1.27µm [.000050] MIN NICKEL.
- ▲ TIN PLATED.
- ▲ GOLD PLATING PER MIL-C-45204, TIN PER MIL-T-10727
- ▲ 0.76µm [.000030] MIN GOLD IN LOCALIZED GOLD PLATE AREA,
 1.27µm [.000050] MIN TIN IN LOCALIZED TIN PLATE AREA,
 BOTH OVER 1.27µm [.000050] MIN NICKEL.

REVERSE REELED FOR MINI-APPLICATOR	▲	1-66584-0
REVERSE REELED FOR MINI-APPLICATOR	▲	66584-4
OBSELETE	▲	66584-3
REVERSE REELED FOR MINI-APPLICATOR	▲	66584-2
OBSELETE	▲	66584-1
DESCRIPTION	FINISH	PART NUMBER

THIS DRAWING IS A CONTROLLED DOCUMENT.

DIMENSIONS: MM [INCHES]	TOLERANCES UNLESS OTHERWISE SPECIFIED:	DWN V. FURLER 09JUN2003	 Tyco Electronics Corporation Harrisburg, PA 17105
0 PLC ± -	1 PLC ± -	CHK C. STEINHAUER 09JUN03	
1 PLC ± -	2 PLC ± 0.13 [.005]	APVD G. STEINHAUER 09JUN03	NAME
2 PLC ± -	3 PLC ± -	PRODUCT SPEC	CONTACT, SOCKET, STRIP TYPE VI, MULTIMATE
3 PLC ± -	4 PLC ± -	APPLICATION SPEC	SIZE CAGE CODE DRAWING NO
4 PLC ± -	ANGLES ± -	WEIGHT	A3 00779 C-66584
MATERIAL BRASS MIL-C-50	FINISH SEE TABLE ▲	CUSTOMER DRAWING	RESTRICTED TO
		SCALE 6:1	SHEET 1 OF 1 REV D

AMP 1470-19 REV 31MAR2000

C:\Program Files\Common Files\System\MAPI\1033\nt\