

4

3

2

1

THIS DRAWING IS UNPUBLISHED. RELEASED FOR PUBLICATION
 © COPYRIGHT - BY TYCO ELECTRONICS CORPORATION. ALL RIGHTS RESERVED.

LOC	DIST	REVISIONS			
P	LTR	DESCRIPTION	DATE	DWN	APVD
B		REV PER EC OG3B-0317-03	24APR03	VF	GS

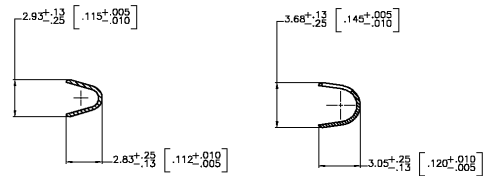
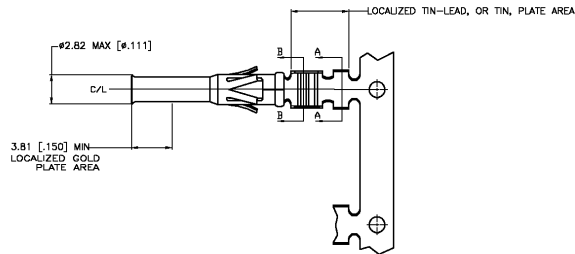
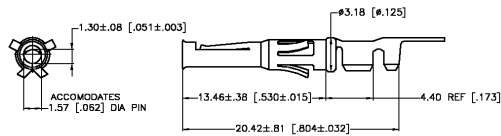
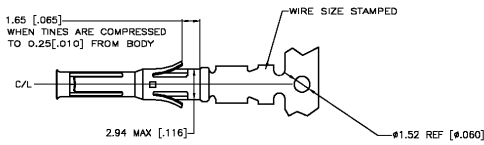

SECTION B-B

SECTION A-A

1. WIRE RANGE 18-16 AWG.
 2. INSULATION RANGE 2.54-2.03 [100-.080] DIA.
 3. FOR LOOSE PIECE PART SEE DWG 66590.
- ▲ 0.76µm [.000030] MIN GOLD IN LOCALIZED GOLD PLATE AREA.
 - ▲ 1.27µm [.000050] MIN TIN-LEAD IN LOCALIZED TIN-LEAD PLATE AREA, BOTH OVER 1.27µm [.000050] MIN NICKEL.
 - ▲ TIN PLATED.
 - ▲ GOLD PLATING PER MIL-G-45204, TIN PER MIL-T-10727 AND NICKEL PER QQ-N-290.
 - ▲ 0.76µm [.000030] MIN GOLD IN LOCALIZED GOLD PLATE AREA.
 - ▲ 1.27µm [.000050] MIN TIN IN LOCALIZED TIN PLATE AREA, BOTH OVER 1.27µm [.000050] MIN NICKEL.

REVERSE REELED FOR MINI-APPLICATOR	▲	66580-7
REVERSE REELED FOR MINI-APPLICATOR	▲	66580-4
REVERSE REELED FOR MINI-APPLICATOR	▲	66580-3
REVERSE REELED FOR MINI-APPLICATOR	▲	66580-2
REVERSE REELED FOR MINI-APPLICATOR	▲	66580-1
DESCRIPTION	FINISH	

THIS DRAWING IS A CONTROLLED DOCUMENT.

DIMENSIONS: MM [INCHES]	TOLERANCES UNLESS OTHERWISE SPECIFIED: 0 PLC ± - 1 PLC ± - 2 PLC ± 0.13 [.005] 3 PLC ± - 4 PLC ± - ANGLES ± -	DWN V. FURLER 14MAY2003	CHK G. STEINHAUER 16MAY03	APVD G. STEINHAUER 16MAY03	NAME G. STEINHAUER	14MAY2003	Tyco Electronics Corporation Harrisburg, PA 17105
MATERIAL BRASS MIL-C-50	FINISH SEE TABLE ▲	PRODUCT SPEC -	APPLICATION SPEC -	WEIGHT -	SIZE A3	CAGE CODE 00779	DRAWING NO 66580
CUSTOMER DRAWING				SCALE 8:5	SHEET 1	OF 1	REV B

AMP 1470-19 REV 31MAR2000

H:\dmtmod\