

4

3

2

1

THIS DRAWING IS UNPUBLISHED. RELEASED FOR PUBLICATION.
 © COPYRIGHT BY TYCO ELECTRONICS CORPORATION. ALL INTERNATIONAL RIGHTS RESERVED.

LOC	DIST	REVISIONS		
F	LNK	DESCRIPTION	DATE	BY
K		REVISED PER ECO-08-007480	19JUN2008	ZMRCW/R
K1		REVISED PER ECO-10-000030	07JAN10	KK AEG

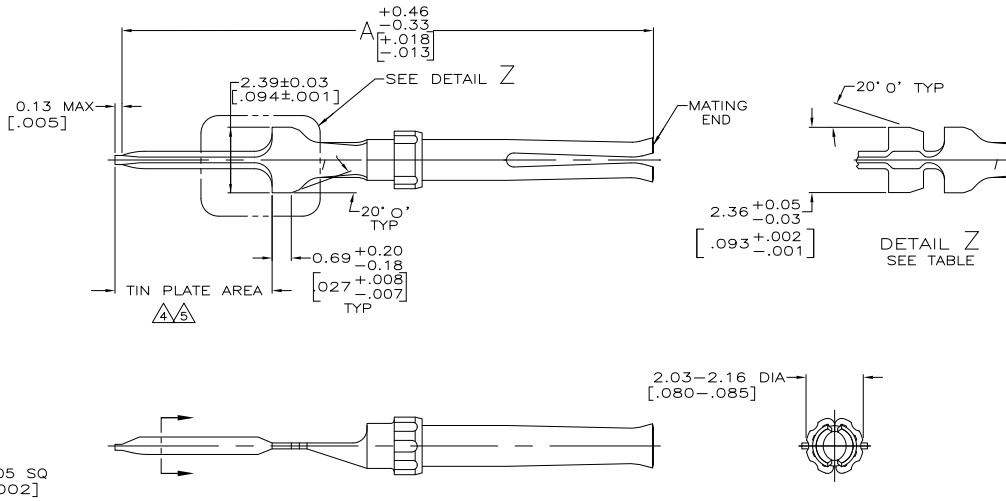

1. FOR MATING CONTACT SEE DRAWING 745287.
2. TO BE USED FOR REPLACEMENT ONLY.

- △ PLATED GOLD FLASH FOR LENGTH OF 2.54 [.100] MIN FROM MATING END, 2.54µm [.000100] MIN TIN ON TIN PLATE AREA, ALL OVER 1.27µm [.000050] MIN NICKEL.
- △ PLATED GOLD FLASH FOR LENGTH OF 2.54 [.100] MIN FROM MATING END 2.54µm [.000100] MIN TIN-LEAD ON TIN PLATE AREA, ALL OVER 1.27µm [.000050] MIN NICKEL.
- △ PLATED 0.76µm [.000030] GOLD FOR LENGTH OF 2.54 [.100] MIN FROM MATING END, 2.54µm [.000100] MIN TIN-LEAD ON TIN PLATE AREA, ALL OVER 1.27µm [.000050] MIN NICKEL.
- △ GOLD PLATED AS FOLLOWS:
 PLATED WITH 0.76µm [.000030] GOLD FOR A LENGTH OF 2.54 [.100] MIN FROM MATING END, 2.54µm [.000100] MIN TIN ON TIN PLATE AREA, ALL OVER 1.27µm [.000050] MIN NICKEL.
 OR
 GOLD FLASH OVER PALLADIUM-NICKEL PLATE, 0.76µm [.000030] MIN TOTAL FOR A LENGTH OF 2.54 [.100] MIN FROM MATING END, 2.54µm [.000100] MIN TIN ON TIN PLATE AREA, ALL OVER 1.27µm [.000050] MIN NICKEL.
- △ MATERIAL: PHOSPHOR BRONZE.

PER DETAIL Z	26.92	[1.060]	△	7-745288-2	
AS SHOWN	30.15	[1.187]	△	7-745288-0	
PER DETAIL Z	32.56	[1.282]	△	6-745288-1	
PER DETAIL Z	26.92	[1.060]	△	5-745288-8	
AS SHOWN	19.30	[.760]	△	5-745288-5	
SUPERSEDED BY 7-745288-0	AS SHOWN	30.15	[1.187]	△	4-745288-4
SUPERSEDED BY 7-745288-0	AS SHOWN	21.16	[.833]	△	2-745288-0
OBSOLETE	AS SHOWN	21.16	[.833]	△	1-745288-8
SUPERSEDED BY 6-745288-1	PER DETAIL Z	32.56	[1.282]	△	1-745288-2
SUPERSEDED BY 7-745288-2	PER DETAIL Z	32.56	[1.282]	△	1-745288-0
SUPERSEDED BY 5-745288-8	PER DETAIL Z	26.92	[1.060]	△	745288-8
SUPERSEDED BY 7-745288-2	PER DETAIL Z	26.92	[1.060]	△	745288-6
SUPERSEDED BY 5-745288-5	AS SHOWN	19.30	[.760]	△	745288-4
SUPERSEDED BY 5-745288-5	AS SHOWN	19.30	[.760]	△	745288-2

THIS DRAWING IS A CONTROLLED DOCUMENT. DIM: R. SHIBBY 29 JAN 91
 CHK: J. MCCLINTON 06 FEB 91
 TPO: - NAME: Tyco Electronics Corporation
 HARRISBURG, PA 17105-3608

SOCKET CONTACT, SIZE 20 DF, AMPLIMITE

SIZE: A2 CASE CODE: C=745288
 WEIGHT: -
 FINISH: △△△△△△

CUSTOMER DRAWING SCALE: 10:1 SHEET: 1 of 1 REV: K1