

REV	DATE	DESCRIPTION	BY	CHK	APP
00					
01		REVISED PER ECO-08-019103			

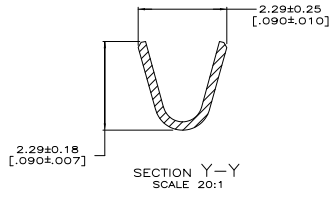
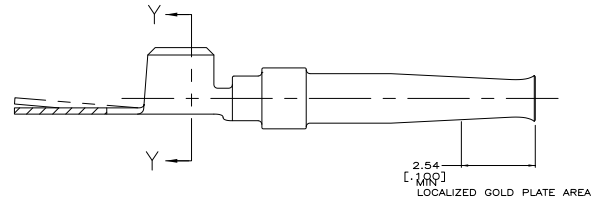
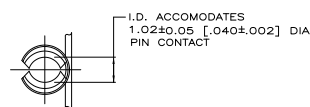
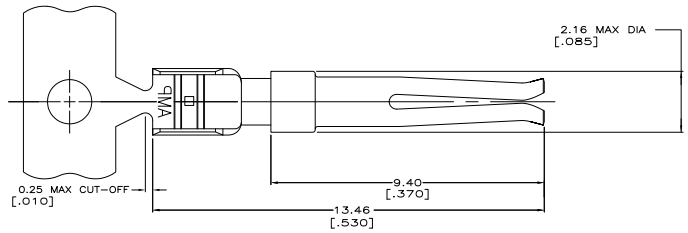

- △ FOR MINI-APPLICATOR.
- 2. MAX. INSULATION DIAMETER ALLOWABLE FOR EXTRACTING CONTACT FROM CONNECTOR WITH 910E7-2 TOOL IS 1.75 [.068].
- 3. GOLD FLASH ON INSIDE OF LOCALIZED GOLD PLATE AREA, 2.54µm [.000100] TIN PLATED ON CRIMP BARRELS, ALL OVER 0.76µm [.000030] NICKEL UNDERPLATE.
- 4. PLATED WITH 0.76µm [.000030] GOLD ON INSIDE OF LOCALIZED GOLD PLATE AREA, 2.54µm [.000100] TIN ON CRIMP BARRELS, ALL OVER 1.27µm [.000050] NICKEL UNDERPLATE.  
 -OR-  
 GOLD FLASH OVER PALLADIUM-NICKEL 0.76µm [.000030] TOTAL ON INSIDE OF LOCALIZED GOLD PLATE AREA, 2.54µm [.000100] TIN ON CRIMP BARRELS, ALL OVER 1.27µm [.000050] NICKEL UNDERPLATE.

△	1658542-2
△	1658542-1
FINISH	PART NUMBER

THIS DRAWING IS A CONTROLLED DOCUMENT.		DR: SAMICK	TR: 140003	TYSO Electronics Corporation Harrisburg, PA 17105-3608	
DATE: 11/14/14	REV: 01	DR: BOLASH	TR: 140003	PART: CONTACT, SOCKET,	
DATE: 11/14/14	REV: 01	DR: WILMSLEY	TR: 140003	PART: 20 DF, 18-22 AWG, AMPULITE	
DATE: 11/14/14	REV: 01	DR: 108-40005	TR: 140003	PART: 114-10000	
DATE: 11/14/14	REV: 01	DR: 114-10000	TR: 140003	PART: 100779	
DATE: 11/14/14	REV: 01	DR: 100779	TR: 140003	PART: G=1658542	
DATE: 11/14/14	REV: 01	DR: 1658542	TR: 140003	PART: 15.1	
DATE: 11/14/14	REV: 01	DR: 15.1	TR: 140003	PART: 1	
DATE: 11/14/14	REV: 01	DR: 1	TR: 140003	PART: D	