

ECHELLE 8.000

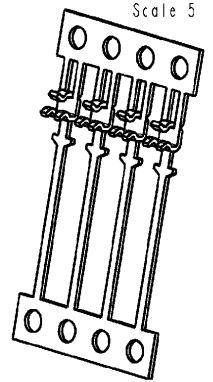
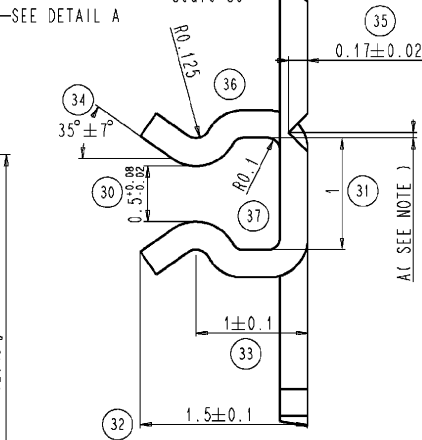
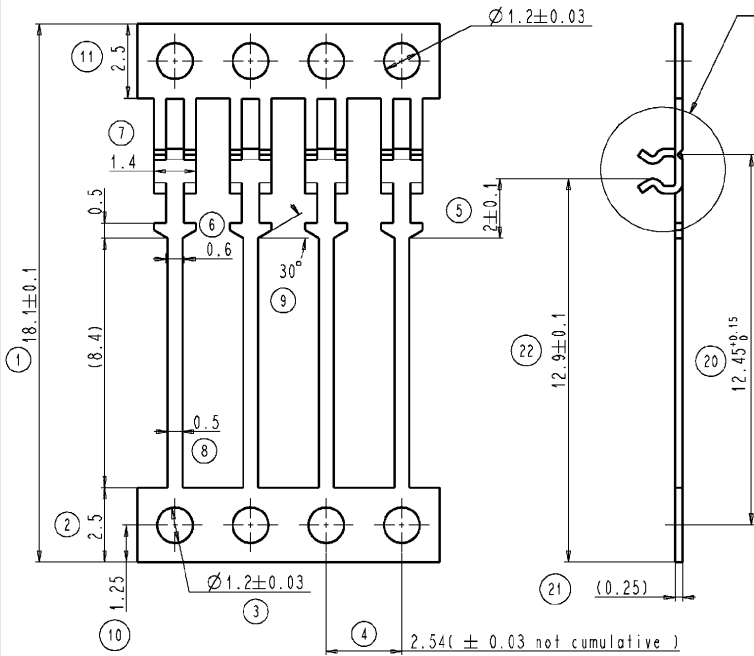

| PRONER COMATEL P/N | TYCO ELECTRONICS P/N |
|--------------------|----------------------|
| 519 1060 142 111 | 0-1544146-1 |
| 519 1060 144 111 | 0-1544146-2 |
| 519 1060 242 111 | 0-1544146-3 |
| 519 1060 244 111 | 0-1544146-4 |

Note : A= Breaking notch shall be outside the clip

| Part number | PLATING |
|------------------|--|
| 519 3955 X04 111 | Bare |
| 519 1060 X42 111 | Sn: 112-19-4 3a 7 μ |
| 519 1060 X44 111 | Etamage: Ni: 112-25-3 1,27 à 3 μ Sn: 112-95-1 4 μ mini |

| Reference/designation | Material | Protection | Quantity |
|-----------------------|------------------------------|------------|---------------------------------|
| see table | Phosphorous bronze SM 105 | / | see table 35000 / lotsize |
| Sub Assy.: | | | |
| Assembly :/ | | | POUR DIFFUSION |

Lead frame DIL

PRONER COMATEL
DEPARTEMENT TECHNIQUE
38530 CHAPAREILLAN
Tél: 04 76 45 34 34 Fax: 04 76 45 28 21

| | |
|-------------------|-----------------|
| Scale: 10/1 | Mass: / |
| Lin. Tol.: ± 0.05 | Ang. Tol.: ± 7° |
| Size A3 | |

4460 D 001

| ER00-0283-04 | SRd | 8/6/04 | B |
|---|------------|----------|---------------|
| MAJ pour maintenance outil, annule et remp. dwg 1060 G3 | / | JDt | 11/07/01 / A1 |
| Description of Modification | No. Modif. | Drawn by | Date |

Reproduction and diffusion forbidden without Proner Comatel agreement