

REV.	DATE	DESCRIPTION
NC	04/25/97	INITIAL RELEASE
A	07/28/06	UPDATE DRAWING FORMAT

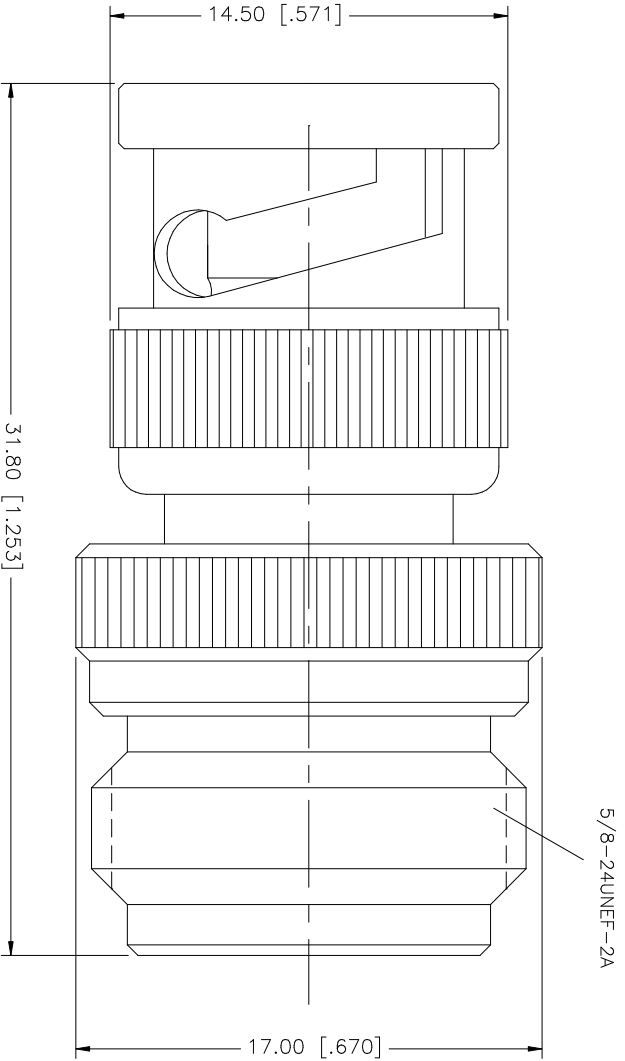

NO.	DESCRIPTION	MATERIAL	FINISH	QTY	UNLESS OTHERWISE SPECIFIED DIMENSIONS ARE IN MILLIMETERS. DIMENSIONS IN INCHES ARE IN PARENTHESES AND FOR REFERENCE ONLY.	APPROVALS	DATE	PART DESCRIPTION	DWG. NO.	REV.	SIZE	SCALE
8					UNLESS OTHERWISE SPECIFIED DIMENSIONS ARE IN MILLIMETERS. DIMENSIONS IN INCHES ARE IN PARENTHESES AND FOR REFERENCE ONLY.			Amphenol Connex BNC MALE TO N FEMALE ADAPTER -	242101	A	A	NA
7					TOLERANCES FOR MILLIMETERS ARE:							
6					0.5 - 8mm ± 0.20mm	DRAWN	07/28/06					
5					8 - 30mm ± 0.40mm	CHECKED						
4					30 - 120mm ± 0.50mm	ISSUED						
3	CONTACT PIN	PHOS. BRONZE	GOLD	1	UNLESS OTHERWISE SPECIFIED DIMENSIONS FOR INCHES ARE:	SHEET	1 OF 1					
2	INSULATOR	TEFLON	NATURAL	1	.020 - .315 = ± 0.007"	CAD FILE						
1	BODY	BRASS	NICKEL	1	.315 - 1.180 = ± 0.015" 1.180 - 4.724 = ± 0.020"	C:\242\242101.DWG						
	DESCRIPTION	MATERIAL	FINISH	QTY	DO NOT SCALE DRAWING							