

REVISIONS			
REV	DESCRIPTION	DATE	APPROVED
01 ₀	RELEASED	3/21/95	<i>D. Cornelli</i>

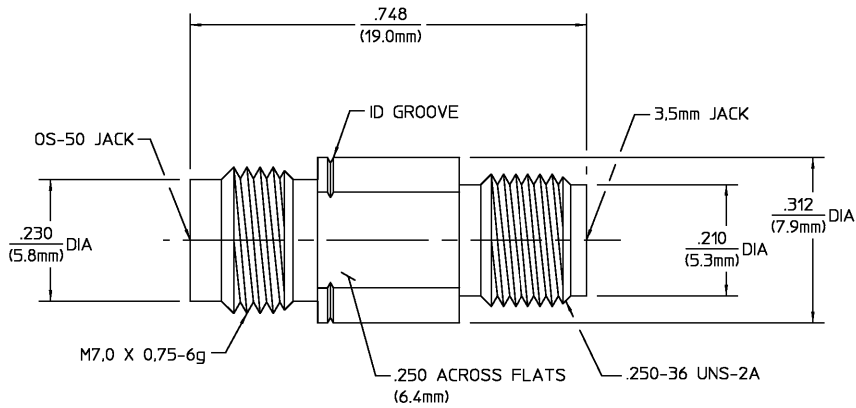

NOTES:

1. CAPTURED CENTER CONTACT
2. MATERIAL:
 CENTER CONDUCTOR: BERYLLIUM COPPER
 PER ASTM B 196, ALLOY C17300, COND. H
 OUTER CONDUCTOR: STAINLESS STEEL
 PER ASTM A484 & A582, TYPE 303
 DIELECTRIC: TEFLON PER ASTM-D-1457
3. FINISH:
 CENTER CONDUCTOR: GOLD PER MIL-G-45204
 OVER NICKEL PLATE PER QQ-N-290
 OUTER CONDUCTOR: PASSIVATE PER QQ-P-35

DESIGN CONTROL REQUIRED

<small>UNLESS OTHERWISE SPECIFIED DIMENSIONS ARE IN INCHES TOLERANCE ON</small> <small>FRAC. DEC. ANGLES</small> <small>+ .004 + .005 ± 1°</small>	<small>DRAWN BY</small> <i>D. Cornelli</i> <small>DATE</small> 3/21/95 <small>CHECKED BY</small> <i>D. Cornelli</i>	AMP Incorporated 140 Fourth Avenue Waltham, MA 02451-7599
	<small>APPROVED BY</small> <i>D. Cornelli</i> 3/21/95 <small>NO. A.P.</small> N/A	
<small>These drawings and specifications are the property of M/A-COM Incorporated and shall not be reproduced or copied or used in whole or in part as the basis for the manufacture or sale of items without written permission.</small>	<small>USE ASSY PROCEDURE</small> <small>SCALE</small> 6:1	<small>CODE IDENT NO.</small> 26805 <small>1250-2277-02</small> <small>REV</small> 01 ₀ <small>SHEET 1 OF 1</small>

CUSTOMER DRAWING

AMP PART # 1046304-1
 SHEET 1 OF 1 REV A