

REVISIONS			
REV	DESCRIPTION	DATE	APPROVED
01	REVISED	10/19/95	DCM 4/5/96

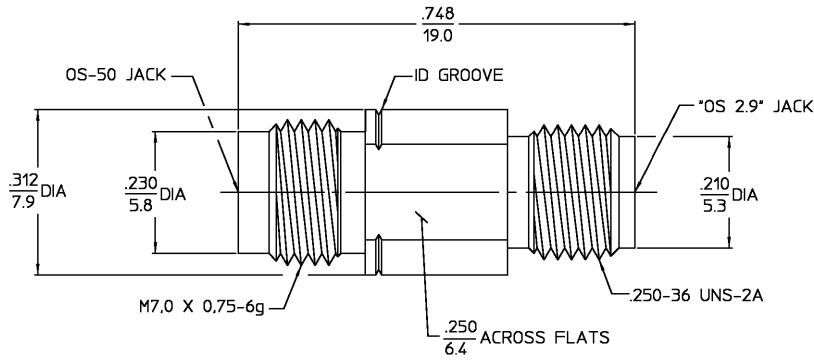

HOUSING	STAINLESS STEEL PER ASTM-A484 AND ASTM-A582, TYPE 303	PASSIVATE PER QQ-P-35
DIELECTRIC	TFE FLUOROCARBON PER ASTM-D-1457	N/A
CENTER CONTACT	BERYLLIUM COPPER PER ASTM-B-196 OR ASTM-B-197, ALLOY C17300, CONDITION H	GOLD PLATE PER MIL-G-45204
COMPONENT	MATERIAL	FINISH
<small>UNLESS OTHERWISE SPECIFIED DIMENSIONS ARE IN INCHES TOLERANCE ON</small> <small>FRAC DEC ANGLES</small> <small>+1/64 ±.005 ±.1°</small>		
<small>THESE DRAWINGS AND SPECIFICATIONS ARE THE PROPERTY OF MVA-COM INCORPORATED AND SHALL NOT BE REPRODUCED OR COPIED OR USED IN WHOLE OR IN PART AS THE BASIS FOR THE MANUFACTURE OR SALE OF ITEMS WITHOUT WRITTEN PERMISSION.</small>		
<small>DRAWN BY</small> RMF <small>DATE</small> 2/2/95 <small>CHECKED BY</small> <small>APP'D BY</small> RMF <small>DATE</small> 2/2/95		AMP Incorporated 140 Fourth Avenue Waltham, MA 02451-7599
<small>USE ASSY PROCEDURE</small> <small>NO. AP.</small> N/A		TITLE OS-50 JACK TO *OS 2.9* JACK <small>SIZE</small> B <small>CODE IDENT NO.</small> 26805 <small>1250-2187-02</small> <small>REV</small> 01 ₁ <small>SCALE</small> 6:1 <small>SHEET</small> 1 OF 1

NOTES:
1. CAPTURED CENTER CONTACT

.XXX = in
XX.X = mm

DESIGN CONTROL REQUIRED

CUSTOMER DRAWING

AMP PART # 1046295-1
SHEET 1 OF 1 REV A