

REVISIONS			
REV	DESCRIPTION	DATE	APPROVED
01 ₁	REVISED	9/18/85	[Signature]

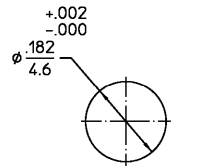

RECOMMENDED MOUNTING HOLE

ELECTRICAL	MECHANICAL	ENVIRONMENTAL
Nominal Impedance (Ohms) 50	Interface Dimensions SEE M/A-COM CATALOG	Temperature Rating -65° to +125°C
Frequency Range (GHz) DC to 18	Mating Characteristics:	Vibration MIL-STD-202, Method 204, Condition D
Volt Rating (VRMS MAX)	Insertion (MAX Lbs) 3	Shock MIL-STD-202, Method 213, Condition I
Sea Level	Withdrawal (MIN Oz) 0.5	Thermal Shock MIL-STD-202, Method 107, Condition B
VSWR 1.05+0.1f(GHz)	Force to Engage (In-Lbs MAX) 3	Moisture Resistance MIL-STD-202, Method 106
Insertion Loss (dB MIN) .06x√f(GHz)	& Disengage (In-Lbs MAX) 1.5	Corrosion - MIL-STD-202, Method 101, Condition B
RF Leakage (dB MIN) -(60-f(GHz))	Center Contact Captivation	
Corona, 70,000 Ft (VRMS MIN) 190	Axial (Lbs) 4	
Dielectric Withstanding Voltage (VRMS MIN) Sea Level 675		
Contact Resistance (Milliohms MAX)		
Center Contact 6.0		
Outer Contact 3.0		
Cable to Housing N/A		
RF High Potential Sea Level (VRMS MIN) 5 MHz 500		
LR (Megohms MIN) 5000		

COMPONENT	MATERIAL	FINISH
HOUSING MOUNTING NUT LOCKWASHER	STAINLESS STEEL PER ASTM-A484 AND ASTM-A582, TYPE 303	PASSIVATE PER QQ-P-35
DIELECTRIC	PTFE FLUOROCARBON PER ASTM-D-1457	N/A
CENTER CONTACT	BERYLLIUM COPPER PER ASTM-B-196 OR ASTM-B-197, ALLOY C17300, CONDITION H	GOLD PLATE PER MIL-G-45204
O-RING	FLUOROSILICONE 60 (DUROMETER) PER MIL-P-25988, CLASS 1, TYPE 1	N/A

UNLESS OTHERWISE SPECIFIED DIMENSIONS ARE IN IN	DRAWN BY GT	DATE 9/18/85	 AMP Incorporated 140 Fourth Avenue Waltham, MA 02451-7599
DEC. ANGLES	CHECKED BY SWA	9/23/85	
±0.13 ±°	APPROD BY PCV	10/25/85	

TITLE 'OSSP' PLUG TO 'OSM' JACK BULKHEAD FEEDTHRU ADAPTER			
SIZE B	CODE IDENT NO. 26805	4785-2240-02	REV 01 ₁
SCALE 5:1			SHEET 1 OF 1

CUSTOMER DRAWING

AMP PART # 1059941-1
SHEET 1 OF 1 REV B
PER EC # 0U20-0261-01