

NUMBER C-1775228  
 METRIC  
 3RD ANGLE PROJECTION

THIS INFORMATION IS CONFIDENTIAL AND IS DECLASSIFIED TO YOU ON CONDITION THAT NO FURTHER DISCLOSURE IS MADE BY YOU TO OTHER THAN AMP PERSONNEL WITHOUT DIMENSIONS IN MILLIMETERS. DO NOT SCALE PRINT.

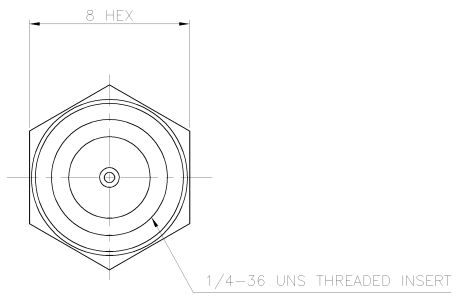
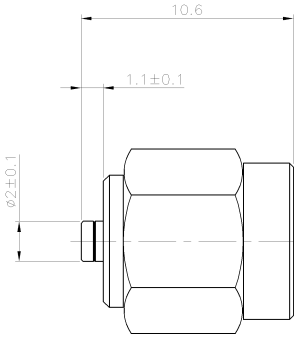

NOTE:

- MATERIAL:  
 SMA BODY: BRASS.  
 MC PLUG: BRASS.  
 CENTER CONTACT: BRASS.  
 INSULATOR: TEFLON, UL 94V-0, WHITE COLOR.  
 C-RING: STAINLESS STEEL.  
 GASKET: SILICON RUBBER, ORANGE COLOR.
- FINISH:  
 0.03302µm [1.3µ"] GOLD PLATED OVER 1.27µm [50µ"] MIN. NICKEL ON SMA BODY, & CENTER CONTACT.  
 3.81µm [150µ"] MIN. SILVER PLATED OVER 1.27µm [50µ"] MIN. NICKEL ON MC PLUG.

1775228-1  
 PART NUMBER

|  |             |                           |                                     |                |
|--|-------------|---------------------------|-------------------------------------|----------------|
| TOLERANCES UNLESS OTHERWISE SPECIFIED: | DWN         | A. WU                     | <b>tyco</b> TYCO HOLDINGS (BERMUDA) |                |
| 0 PLC ±                                | 15-JUN-2006 | S. HOU                    | VII LTD. TAIWAN BRANCH              |                |
| 1 PLC ±0.3                             |             | NAME                      |                                     |                |
| 2 PLC ±0.2                             |             | APVD                      | SMA CONVERSION ADAPTOR              |                |
| 3 PLC ±0.1                             |             | W.J. KE                   | UMCC TYPE I (AMC-380)               |                |
| ANGLES ±5°                             |             | 15-JUN-2006               |                                     |                |
| MATERIAL                               | SEE NOTE    | PRODUCT SPEC              |                                     |                |
| FINISH                                 | SEE NOTE    | QUALIFICATION TEST REPORT | LOC                                 | SIZE           |
|  |             | WEIGHT                    | DW                                  | A <sub>3</sub> |
|  |             |                           | SCALE                               | DRAWING NO     |
|  |             |                           |                                     | C-1775228      |
|  |             |                           |                                     | REV            |
|  |             |                           |                                     | A              |
|  |             |                           |                                     | SHEET          |
|  |             |                           |                                     | 1 OF 2         |

|     |                 |     |     |       |
|-----|-----------------|-----|-----|-------|
|     |                 |     |     |       |
| A   | FIRST RELEASED  | --  | AW  | 15JUN |
| LTR | REVISION RECORD | ECN | DWN | 2006  |
|     |                 |     | CHK | DATE  |

CUSTOMER DRAWING

NUMBER C-1775228  
 METRIC  
 3RD ANGLE PROJECTION

THIS INFORMATION IS CONFIDENTIAL AND IS DECLASSIFIED TO YOU ON CONDITION THAT NO FURTHER DISCLOSURE IS MADE BY YOU TO OTHER THAN AMP PERSONNEL WITHOUT DIMENSIONS IN MILLIMETERS. DO NOT SCALE PRINT.

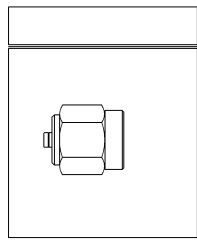

INNER BAG  
 50 X 50 X 0.04

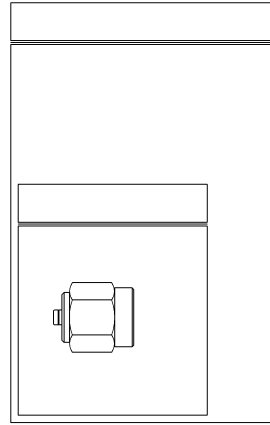

OUTER BAG  
 70 X 100 X 0.04

|              |            |                |                       |          |
|--------------|------------|----------------|-----------------------|----------|
| 28.9 g       | 24.3 g     | 1              | 10                    | 10 PCS   |
| GROSS WEIGHT | NET WEIGHT | PCS /INNER BAG | INNER BAGS /OUTER BAG | QUANTITY |

|  |                  |             |                                     |                |
|--|------------------|-------------|-------------------------------------|----------------|
| TOLERANCES UNLESS OTHERWISE SPECIFIED: | DWN              | A. WU       | <b>tyco</b> TYCO HOLDINGS (BERMUDA) |                |
| 0 PLC ±                                |                  | 15-JUN-2006 | VII LTD. TAIWAN BRANCH              |                |
| 1 PLC ±                                | CHK              | S. HOU      | <b>Electronics</b>                  |                |
| 2 PLC ±                                |                  | 15-JUN-2006 | NAME                                |                |
| 3 PLC ±                                |                  |             | -                                   |                |
| ANGLES ±                               |                  |             | -                                   |                |
| MATERIAL                               | APVD             | W.J. KE     | SMA CONVERSION ADAPTOR              |                |
| -                                      |                  | 15-JUN-2006 | UMCC TYPE I (AMC-380)               |                |
| FINISH                                 | APPLICATION SPEC |             | LOC                                 | SIZE           |
| -                                      |                  |             | DW                                  | A <sub>3</sub> |
|  | WEIGHT           |             | DRAWING NO                          | REV            |
|  |                  |             | C-1775228                           | A              |
|  |                  |             | SCALE                               | SHEET          |
|  |                  |             | --                                  | 2 OF 2         |

|     |                 |     |         |      |
|-----|-----------------|-----|---------|------|
| LTR | SEE SHEET 1.    | ECN | DWN/CHK | DATE |
|     | REVISION RECORD |     |         |      |

CUSTOMER DRAWING