

REV	DATE	DESCRIPTION	BY	CHK	APP
00					
01		REV PER ECO 06-20880	DW	JL	

- ▲ BERYLLIUM COPPER PER ASTM-B-194
- ▲ BRASS PER ASTM-B-16
- ▲ PTFE PER MIL-P-19468
- ▲ SILICONE RUBBER PER ZZ-R-765
- ▲ ZINC DIE CAST PER ASTM-B-86
- ▲ SILVER PLATE PER QQ-S-365, 5.08 μm [.000200] MIN THICKNESS
- ▲ NICKEL PLATE PER QQ-N-290, 1.27 μm [.000050] MIN THICKNESS
- ▲ NICKEL PLATE PER QQ-N-290, 2.54 μm [.000100] MIN THICKNESS
- ▲ TIN PLATE PER ASTM-B-545, 2.54 μm [.000100] MIN THICK.
- ▲ TIN PLATE PER ASTM-B-545, 2.54 μm [.000100] MIN THICKNESS

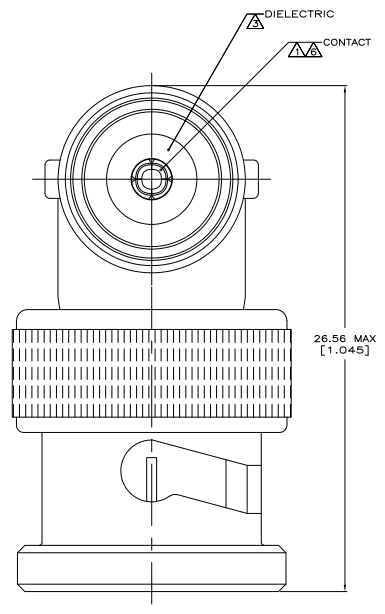
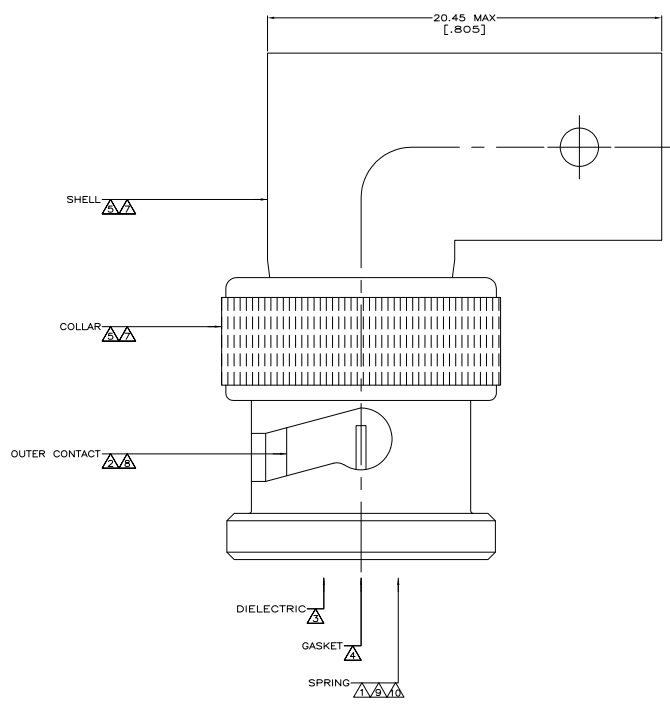

OBsolete	9-329517-0
OBsolete	1-329517-0
	329517
	PART NUMBER

THIS DRAWING IS A CONTROLLED DOCUMENT.		DESIGNER: MICHAEL E. COFFEE	DATE: 06/20/07	SCALE: 10:1	REVISED TO: ---
DRAWN BY: MICHAEL J. PHILLIPS		CHECKED BY: MICHAEL J. PHILLIPS	DATE: 06/20/07	REVISED TO: ---	REWORKED TO: ---
SEE NOTES		CUSTOMER DRAWING		DATE: 10/1	REV: 1