

4

3

2

1

THIS DRAWING IS UNPUBLISHED. RELEASED FOR PUBLICATION AUGUST, 2005.
 © COPYRIGHT 2005 BY TYCO ELECTRONICS CORPORATION. ALL RIGHTS RESERVED.

LOC		DIST		REVISIONS			
P	LTR	DESCRIPTION		DATE	DWN	APVD	
C		ECR-05-018891		25AUG06	JMS	FWK	

NOTES:

- ▲ PACK IN ACCORDANCE WITH AMP SPEC 107-3275
- ▲ 100 TRAY PACK IN ACCORDANCE WITH AMP SPEC 107-3275
- ▲ Au PLATING
- ▲ Ni PLATING
- ▲ THIS ITEM MUST BE WHITE

6 ELECTRICAL CHARACTERISTICS
 FREQUENCY RANGE: DC - 4 GHz
 NOMINAL IMPEDANCE: 50 Ohm
 INSULATION RESISTANCE: 5000 MOhm
 WORKING VOLTAGE: 500 Volts RMS at Sea Level
 DIELECTRIC WITHSTAND VOLTAGE: 1500 Volts RMS Max
 CONTACT RESISTANCE: 1.50 mOhm Max
 CENTRE CONTACT: 0.20 mOhm Max
 OUTER CONTACT: N/A
 VSWR @ xGHz: N/A
 INSERTION LOSS xdb: N/A

7 MECHANICAL CHARACTERISTICS
 COUPLING RETENTION FORCE: N/A
 CABLE RETENTION FORCE: N/A
 DURABILITY: 500 Cycles Min

8 ENVIRONMENTAL CHARACTERISTICS
 OPERATING TEMPERATURE: -65 to +85 DegC

9 FOR TECHNICAL DATA REFER TO YOUR LOCAL TYCO ELECTRONICS SALES OFFICE

10 ALL DIMENSIONS ARE NOMINAL FOR REFERENCE ONLY UNLESS OTHERWISE STATED

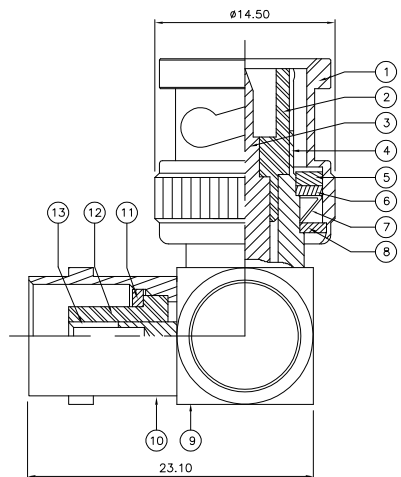
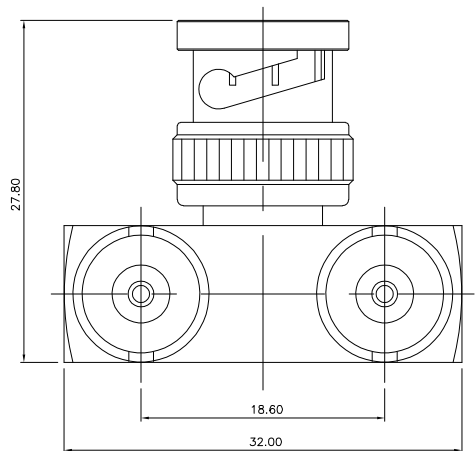

QTY	QTY	QTY	MATERIAL	DESCRIPTION	ITEM	
2	2		SRASS	CONTACT 2	13	
2	2		PP	INSULATION	12	
2	2		BRASS	SLEEVE	11	
2	2		BRASS	BODY 3	10	
1	1		BRASS	BODY 2	9	
1	1		BRASS	WASHER	8	
1	1		SPRING STEEL	SPRING	7	
1	1		BRASS	RETAINING RING	6	
1	1		SILICON RUBBER	GASKET	5	
1	1		BRASS	BODY 1	4	
1	1		BRASS	CONTACT 1	3	
1	1		PP	INSULATION	2	
1	1		BRASS	SHELL	1	
6	-0	1	-0	MATERIAL	DESCRIPTION	ITEM

QUANTITY PER ASSY PARTS LIST

THIS DRAWING IS A CONTROLLED DOCUMENT.		DWN J.SANDWELL 25AUG06	Tyco Electronics Corporation Bideford EX39 4HE	
DIMENSIONS: mm		CHK S.PARLOW 25AUG06		
TOLERANCES UNLESS OTHERWISE SPECIFIED:		APVD F.WHEELER-KING 25AUG06	NAME BNC ELBOW Y-ADAPTOR P-J-J 50 OHM	
0 PLC ± -		PRODUCT SPEC	SIZE CAGE CODE DRAWING NO RESTRICTED TO	
1 PLC ± -		APPLICATION SPEC	A3 00779 C-1337461	
2 PLC ± -		WEIGHT	CUSTOMER DRAWING SCALE NTS SHEET 1 OF 1 REV C	
3 PLC ± -				
4 PLC ± -				
ANGLES ± -				
FINISH				
SEE TABLE				