

4

3

2

1

THIS DRAWING IS UNPUBLISHED. RELEASED FOR PUBLICATION MAY, 2006.
 © COPYRIGHT 2006 BY TYCO ELECTRONICS CORPORATION. ALL RIGHTS RESERVED.

LOC		DIST		REVISIONS			
P	LTR	DESCRIPTION		DATE	DWN	APVD	
C		ECR-06-010127		16MAY06	JMS	FWK	

NOTES:

- ▲ PACK IN ACCORDANCE WITH AMP SPEC 107-3275
- ▲ 100 TRAY PACK IN ACCORDANCE WITH AMP SPEC 107-3275
- ▲ Au PLATING
- ▲ Ni PLATING
- 5 ELECTRICAL CHARACTERISTICS
 FREQUENCY RANGE: DC - 11 GHz
 NOMINAL IMPEDANCE: 50 Ohm
 INSULATION RESISTANCE: 5000 MOhm
 WORKING VOLTAGE: 500 Volts RMS at Sea Level
 DIELECTRIC WITHSTAND VOLTAGE: 1500 Volts RMS Max
 CONTACT RESISTANCE:
 CENTRE CONTACT: 1.50 mOhm Max
 OUTER CONTACT: 1.00 mOhm Max
 INSERTION LOSS db: 0.20 Max
- 6 MECHANICAL CHARACTERISTICS
 MOUNT NUT RECOMMENDED TORQUE: 4N
 DURABILITY: 500 Cycles Min
- 7 ENVIRONMENTAL CHARACTERISTICS
 OPERATING TEMPERATURE: -65 to +165 DegC
- 8 FOR TECHNICAL DATA REFER TO YOUR LOCAL TYCO ELECTRONICS SALES OFFICE
- 9 ALL DIMENSIONS ARE NOMINAL FOR REFERENCE ONLY UNLESS OTHERWISE STATED

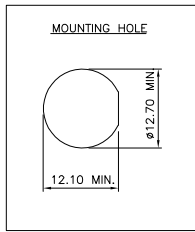
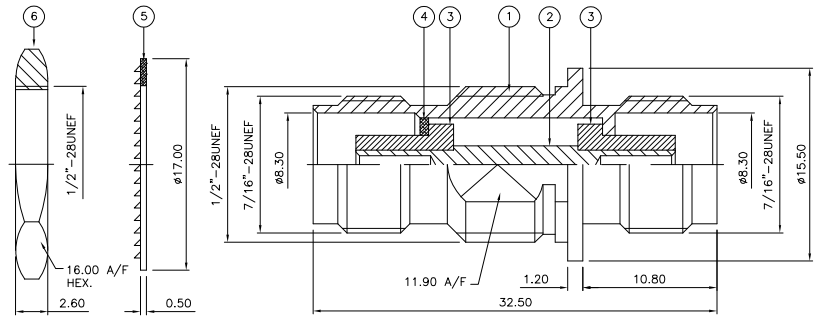

QTY	UNIT	MATERIAL	DESCRIPTION	ITEM
1	1	BRASS	▲ HEXAGONAL NUT	6
1	1	STEEL	▲ LOCKWASHER	5
1	1	BRASS	▲ WASHER	4
2	2	PTFE	INSULATION	3
1	1	BRASS	▲ CONTACT	2
1	1	BRASS	▲ BODY	1
6--0	1--0	MATERIAL	DESCRIPTION	ITEM

THIS DRAWING IS A CONTROLLED DOCUMENT.

DIMENSIONS: mm	TOLERANCES UNLESS OTHERWISE SPECIFIED:	DWN J. SANDWELL 16MAY06	16MAY06	tyco Tyco Electronics Corporation
0 PLC ± .05	1 PLC ± .02	CHK S. PARLOW 16MAY06	16MAY06	Bideford EX39 4HE
2 PLC ± .02	3 PLC ± .02	APVD F. WHEELER-KING 16MAY06	16MAY06	NAME
4 PLC ± .02	ANGLES ± .02	PRODUCT SPEC	PRODUCT SPEC	TNC BULKHEAD ADAPTOR J-J 50 OHM
MATERIAL SEE TABLE	FINISH	APPLICATION SPEC	APPLICATION SPEC	SIZE CAGE CODE DRAWING NO RESTRICTED TO
		WEIGHT	WEIGHT	A3 00779 C-1337619
		CUSTOMER DRAWING	CUSTOMER DRAWING	SCALE NTS SHEET 1 OF 1 REV C