

REV.	DATE	DESCRIPTION
A	01/30/04	UPDATE DRAWING FORMAT
B	03/10/08	REVISE BODY, ADD KNURLED MID-SECTION

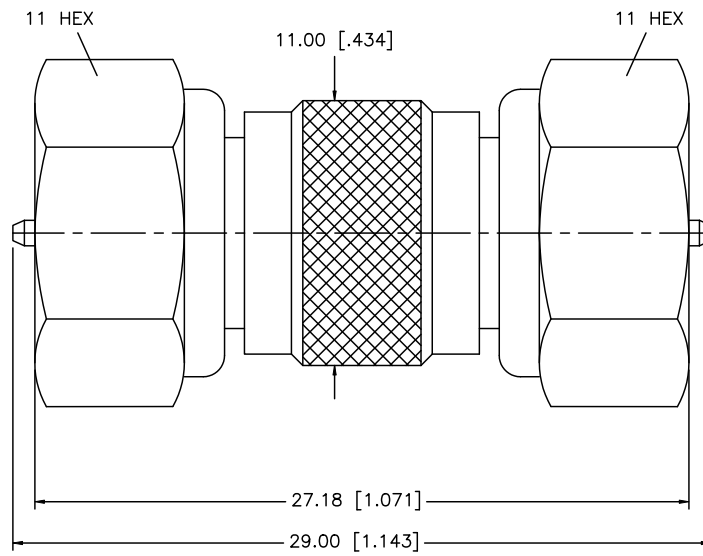

				UNLESS OTHERWISE SPECIFIED DIMENSIONS ARE IN MILLIMETERS. DIMENSIONS IN [] ARE IN INCHES AND FOR CUSTOMER REFERENCE ONLY.	APPROVALS	DATE	Amphenol Connex			
8				UNLESS OTHERWISE SPECIFIED TOLERANCES FOR MILLIMETERS ARE: 0.5 - 8mm ± 0.20mm 8 - 30mm ± 0.40mm 30 - 120mm ± 0.50mm UNLESS OTHERWISE SPECIFIED TOLERANCES FOR INCHES ARE: .020 - .315 = ± 0.007" .315 - 1.180 = ± 0.015" 1.180 - 4.724 = ± 0.020" DO NOT SCALE DRAWING	DRAWN	G.R.S.		03/10/08	PART DESCRIPTION	
7					CHECKED			F MALE TO MALE -		
6					ISSUED				PART NO.	
5					SHEET	1 OF 1		222156		
4										
3	CONTACT PIN	BRASS	NICKEL	1						
2	INSULATOR	DELRIN	NATURAL	1						
1	BODY	BRASS	NICKEL	2						
	DESCRIPTION	MATERIAL	FINISH	QTY		CAD FILE	DWG. NO.	REV.	SIZE	SCALE
						C:/222/222156.DWG	222156.DWG	B	A	NA