

REV.	DATE	DESCRIPTION
NC	12/16/01	INITIAL RELEASE
A	07/24/05	UPDATE DRAWING FORMAT

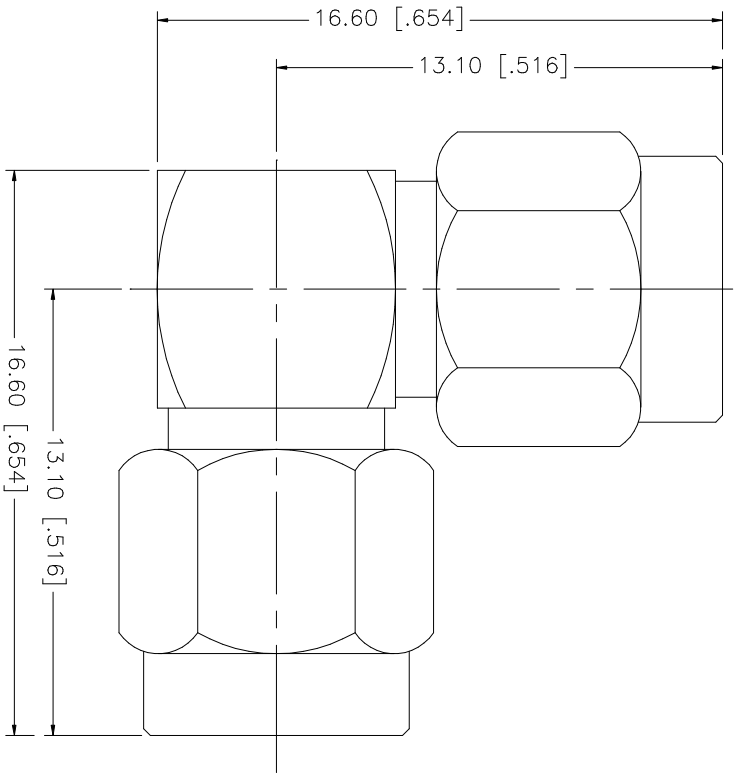

QTY	FINISH	MATERIAL	DESCRIPTION
1	GOLD	BER. COPPER	CONTACT PIN
1	NATURAL	TEFLON	INSULATOR
1	GOLD	BRASS	BODY

UNLESS OTHERWISE SPECIFIED DIMENSIONS ARE INCHES AND FOR CUSTOMER REFERENCE ONLY.	
TOLERANCES FOR MILLIMETERS ARE:	
0.3 - 8mm	± 0.20mm
8 - 30mm	± 0.40mm
30 - 120mm	± 0.50mm
UNLESS OTHERWISE SPECIFIED TOLERANCES FOR INCHES ARE:	
.020 - .315	± 0.007"
.315 - 1.180	± 0.015"
1.180 - 4.724	± 0.020"
DO NOT SCALE DRAWING	

APPROVALS	DATE
DRAMN G.R.S.	07/24/05
CHECKED	
ISSUED	
SHEET 1 OF 1	

CAD FILE C:/132/132339.DWG		DWG. NO. 132339.DWG	REV. A	SIZE A	SCALE NA
-------------------------------	--	------------------------	-----------	-----------	-------------

Amphenol Connex	
PART DESCRIPTION SMA R/A PLUG-PLUG ADAPTER	
PART NO.	132339