

REVISIONS			
REV	DESCRIPTION	DATE	APPROVED
01	REVISED	5/10/96	ICpm 5/10/96

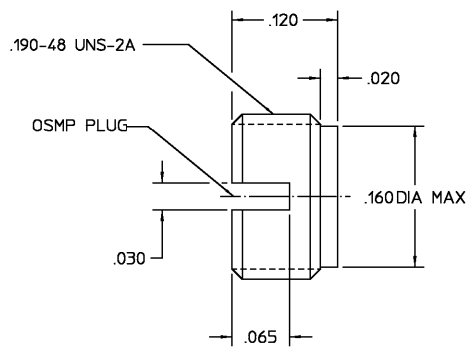

RECOMMENDED MOUNTING HOLE

HOUSING	STAINLESS STEEL PER ASTM-A484 AND ASTM- A582, TYPE 303	PASSIVATE PER ASTM-A380
COMPONENT	MATERIAL	FINISH
UNLESS OTHERWISE SPECIFIED DIMENSIONS ARE IN INCHES TOLERANCE ON FRAC. DEC. ANGLES ± 1/64 ± .005 ± °	DRAWN BY: <i>BB</i> DATE: 3/30/94 CHECKED BY: <i>BB</i> APPROVED BY: <i>BB</i> 4/11/94	AMP Incorporated 140 Fourth Avenue Waltham, MA 02451-7599
These drawings and specifications are the property of MVA-COM Incorporated and shall not be reproduced or copied or used in whole or in part as the basis for the manufacture or sale of items without written permission.	USE ASSY PROCEDURE 408- NO. A.P. (29-015)	TITLE OSMP SHROUD SMOOTH DETENT SIZE B CODE IDENT NO. 26805 SCALE 10:1
		2998-5044-02
		REV 01
		SHEET 1 OF 1

CUSTOMER DRAWING AMP PART # 1056744-1 SHEET 1 OF 1 REV A