

4

3

2

1

THIS DRAWING IS UNPUBLISHED. RELEASED FOR PUBLICATION
 © COPYRIGHT - BY TYCO ELECTRONICS CORPORATION. ALL RIGHTS RESERVED.

LOC	DIST	REVISIONS				
P	LTR	DESCRIPTION	DATE	DWN	APVD	
	01	REDRAWN & REVISED PER ECO-06-012361	02JUN2006	MS	JL	

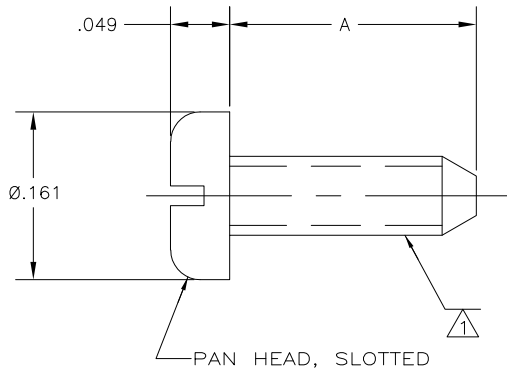

- △1 #2-56 SPECIAL THREAD-ROLLING SCREW THREAD
- △2 CARBON STEEL PER AISI 1019-1022
- △3 ZINC PLATE

.250 MAX	9-221108-1
.312 MAX	9-221108-0
.250 MAX	221108-4
.312 MAX	221108-2
A DIM	PART NO

THIS DRAWING IS A CONTROLLED DOCUMENT.		DWN M SYKES	02JUN2006		Tyco Electronics Corporation Harrisburg, PA 17105-3608	
DIMENSIONS: INCHES		CHK DK SCHRUM	02JUN2006		SCREW, SELF TAPPING	
TOLERANCES UNLESS OTHERWISE SPECIFIED:		APVD JT LIPPETT	02JUN2006	NAME		
0 PLC ± - 1 PLC ± - 2 PLC ± - 3 PLC ± .008 4 PLC ± - ANGLES ± -		PRODUCT SPEC		SIZE CAGE CODE DRAWING NO		
MATERIAL △2		APPLICATION SPEC		RESTRICTED TO		
FINISH △3		WEIGHT -		A3 00779 C-221108		
CUSTOMER DRAWING				SCALE NTS	SHEET 1 OF 1	REV 01

AMP 1470-19 REV 31MAR2000

06JUN2006 8:34am us026463 \\Us194fp00\data\RF\Prod_eng\Schrum\Lippert\ECO-06-012361\221108_1-c.dwg