

REV.	DATE	DESCRIPTION
NC	06/12/02	INITIAL RELEASE

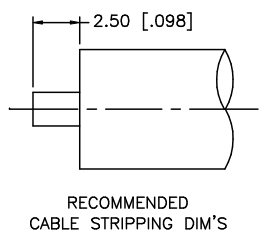
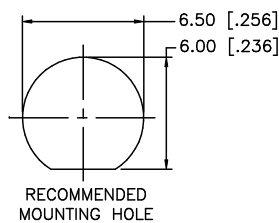
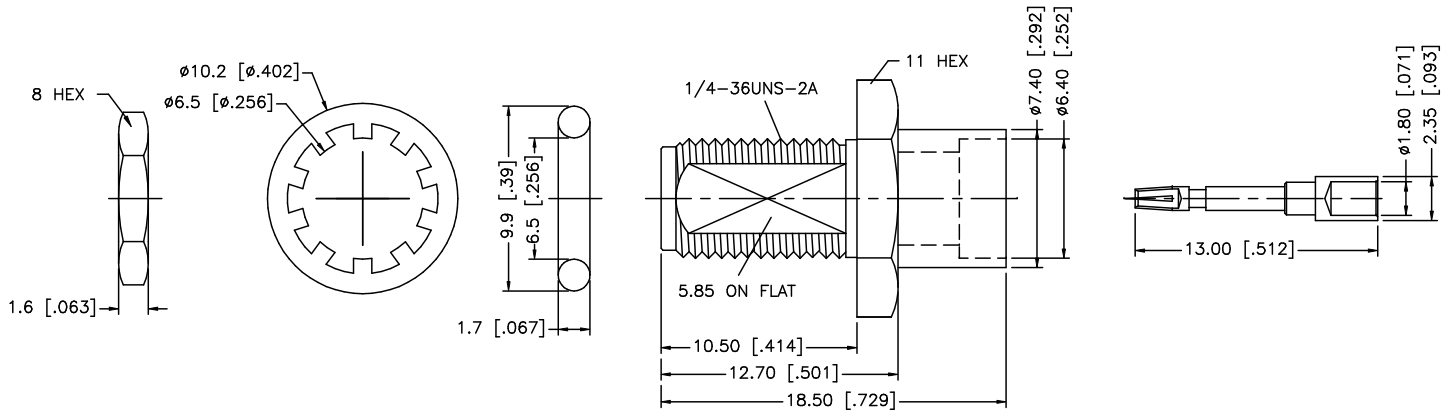

CRIMP NOTES:  
 1. SOLDER CENTER CONTACT  
 2. MAX. PANEL THICKNESS = 2.4mm

8				UNLESS OTHERWISE SPECIFIED DIMENSIONS ARE IN MILLIMETERS	APPROVALS	DATE	<h1>Amphenol - Connex</h1> <p>CONNECTOR CORPORATION</p>			
7					DRAWN	G.R.S.				
6	HEX NUT	BRASS	GOLD	DIMENSIONS IN [ ] ARE IN INCHES FOR CUSTOMER REFERENCE ONLY	CHECKED		TITLE			
5	LOCK WASHER	BRASS	GOLD		ISSUED		SMA DIRECT SOLDER BULKHEAD JACK (.250 SEMI RIGID CABLE)			
4	GASKET	RUBBER	RED	UNLESS OTHERWISE SPECIFIED TOLERANCES FOR INCHES ARE: .XXX = ± 0.005" .XX = ± 0.010" .X = ± 0.020"			SIZE	FSCM NO.	DWG. NO.	REV.
3	CONTACT PIN	BER. COPPER	GOLD				A	99001	132346.DWG	NC
2	INSULATOR	TEFLON	NATURAL	DO NOT SCALE DRAWING			SCALE	PART NO.		SHEET
1	BODY	BRASS	GOLD				NA	132346		1 OF 1
	DESCRIPTION	MATERIAL	FINISH							